

TM 9-1005-262-15

DEPARTMENT OF THE ARMY TECHNICAL MANUAL

OPERATOR, ORGANIZATIONAL, DIRECT AND
GENERAL SUPPORT, AND DEPOT
MAINTENANCE MANUAL
(INCLUDING REPAIR PARTS AND SPECIAL TOOL LISTS)

ARMAMENT SUBSYSTEM, HELICOPTER,
7.62-MILLIMETER MACHINE GUN:
DOOR MOUNTED, LIGHTWEIGHT,
XM23

(USED ON UH-1D HELICOPTERS)
AND

ARMAMENT SUBSYSTEM, HELICOPTER,
7.62-MILLIMETER MACHINE GUN:
DOOR MOUNTED, LIGHTWEIGHT,
XM24

(USED ON CH-47A HELICOPTERS)



HEADQUARTERS, DEPARTMENT OF THE ARMY
AUGUST 1965

574

1a

Digitized by:

**ARMAMENT SUBSYSTEM, HELICOPTER,
 7.62-MILLIMETER MACHINE GUN:
 DOOR MOUNTED, LIGHTWEIGHT, XM23
 (USED ON UH-1D HELICOPTERS)
 AND
 ARMAMENT SUBSYSTEM, HELICOPTER,
 7.62-MILLIMETER MACHINE GUN:
 DOOR MOUNTED, LIGHTWEIGHT, XM24
 (USED ON CH-47A HELICOPTERS)**

		Paragraphs	Page
CHAPTER	1. INTRODUCTION		
Section	I. General	1-1-1-3	2
	II. Description and data	1-4, 1-5	2
CHAPTER	2. OPERATOR AND GROUND CREW OPERATIONAL INSTRUCTIONS		
Section	I. Service upon receipt of materiel	2-1, 2-2	7
	II. Controls	2-3, 2-4	7
	III. Operating instructions	2-5-2-15	7
CHAPTER	3. ORGANIZATIONAL MAINTENANCE INSTRUCTIONS		
Section	I. Repair parts, tools, and equipment	3-1, 3-2	19
	II. Lubrication and painting	3-3, 3-4	19
	III. Preventive-maintenance checks and services	3-5, 3-6	19
	IV. Troubleshooting	3-7	23
	V. Machine gun XM60D	3-8-3-19	24
Section	VI. Mount assembly XM23 and equipment	3-20-3-23	28
	VII. Mount assembly XM24 and equipment	3-24, 3-25	31
CHAPTER	4. DIRECT AND GENERAL SUPPORT AND DEPOT MAINTENANCE INSTRUCTIONS		
Section	I. Machine gun XM60D and equipment	4-1-4-12	33
	II. Mount assembly XM23 and equipment	4-13-4-19	34
CHAPTER	5. AMMUNITION	5-1	36
CHAPTER	6. FINAL INSPECTION	6-1	37
CHAPTER	7. REPAIR STANDARDS	7-1	38
CHAPTER	8. OVERHAUL INSTRUCTIONS	8-1	39
APPENDIX	I. BASIC ISSUE ITEMS, ORGANIZATIONAL, DIRECT AND GENERAL SUPPORT, AND DEPOT MAINTENANCE REPAIR PARTS AND SPECIAL TOOL LISTS		40
	II. MAINTENANCE ALLOCATION CHART	1-2	2
	INDEX		72

CHAPTER 1 INTRODUCTION

Section I. GENERAL

1-1. Scope

This manual contains information and instructions for operation and maintenance of 7.62-millimeter machine gun helicopter armament subsystems XM23 and XM24. The order of disassembly is in accordance with the numbering and lettering as shown on the illustration, unless otherwise indicated. Assembly is in reverse order of disassembly.

1-2. Maintenance Allocation Chart

See Appendix II.

1-3. Forms, Records, and Reports

a. Authorized Forms. Refer to DA Pam 310-2 and TM 38-750. Use DA Form 2028 for direct reporting of errors, omissions and recommendations for improvement direct to: Commanding General, U. S. Army Weapons Command, ATTN: AMSWE-SMM-P, Rock Island Arsenal, Rock Island, Illinois 61202.

b. Field Report of Accidents.

- (1) *Injury to personnel or damage to materiel.* Refer to AR 385-40.
- (2) *Ammunition.* Refer to AR 700-1300-8.

Section II. DESCRIPTION AND DATA

1-4. Description

a. Armament Subsystems. Subsystem XM23 is used on the UH-1D helicopter (fig. 1-1) and subsystem XM24 is used on the CH-47A helicopter (fig. 1-2). For subsystem components and equipment, refer to figures 1-3 through 1-7.

b. Machine Gun XM60D. The machine gun is mounted on the left and right side mount assemblies of each subsystem.

c. Mount Assembly XM23. Left side and right side mount assemblies are attached to hard points on the underside of the helicopter (fig. 1-4). A traversing lock on the post pintle secures the machine gun in stowed position. Maximum elevation, depression and traverse of the machine gun are controlled by the pintle pivot.

d. Mount Assembly XM24. The two mount assemblies are installed horizontally, right mount assembly across the right cabin doorway and the left mount assembly across the escape hatch on the left side of helicopter, and each

mount assembly attaches to the wall frame members (fig. 1-6). One shock cord assembly is attached to the rear mounting bracket of each mount assembly and is used to stow machine gun. Maximum elevation, depression, and traverse movements of the machine gun on mount assembly are controlled by the pintle pivot.

1-5. Tabulated Data

a. Mount Assembly XM23.

Elevation	Forward 0 mils
	Aft +178 mils
	Side +89 mils
Depression	Forward 1510 mils
	Aft 1333 mils
	Side 1422 mils
Traverse	2914 mils

b. Mount Assembly XM24.

Elevation	Forward -107 mils +3
	Aft +151 mils +6.5
Depression	1386 mils max right side
	1191 mils max left side
Traverse	Forward 1066 mils
	Rearward 1066 mils



Figure 1-1. 7.62-millimeter machine gun helicopter armament subsystem XM23—installed on UH-1D helicopter.

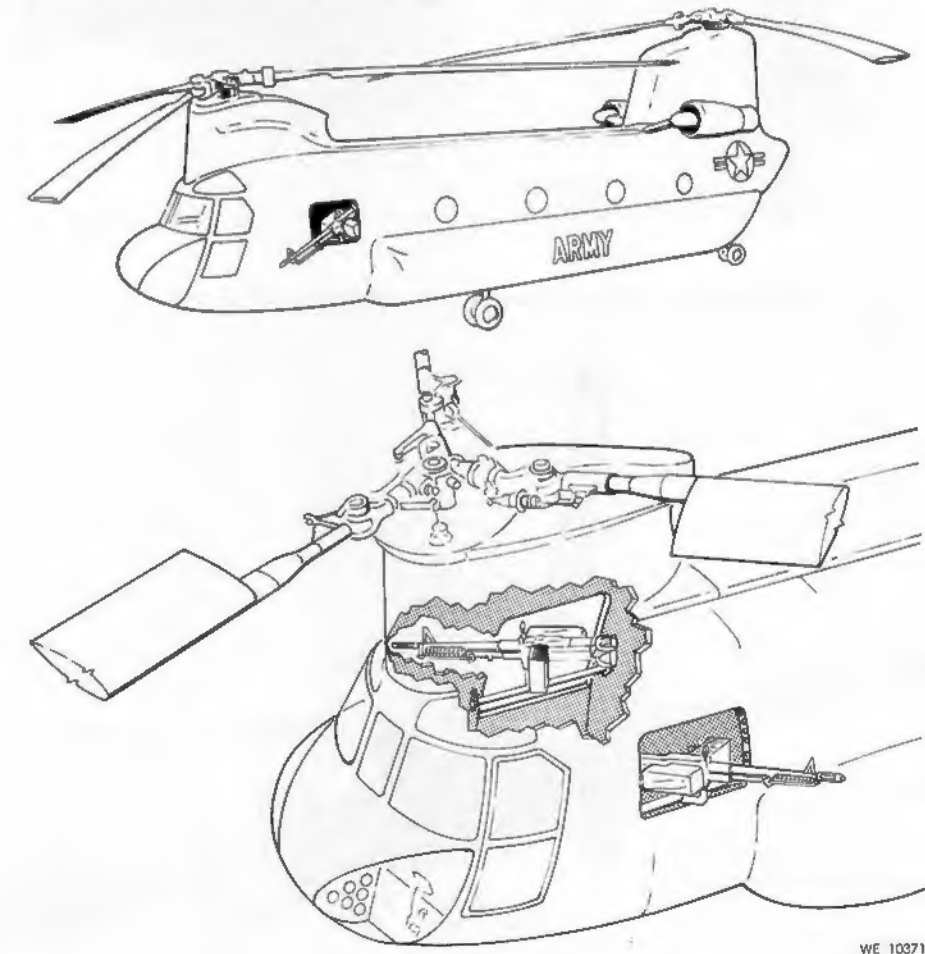

Figure 1-2. 7.62-millimeter machine gun helicopter armament subsystem XM24—installed on CH-47A helicopter.

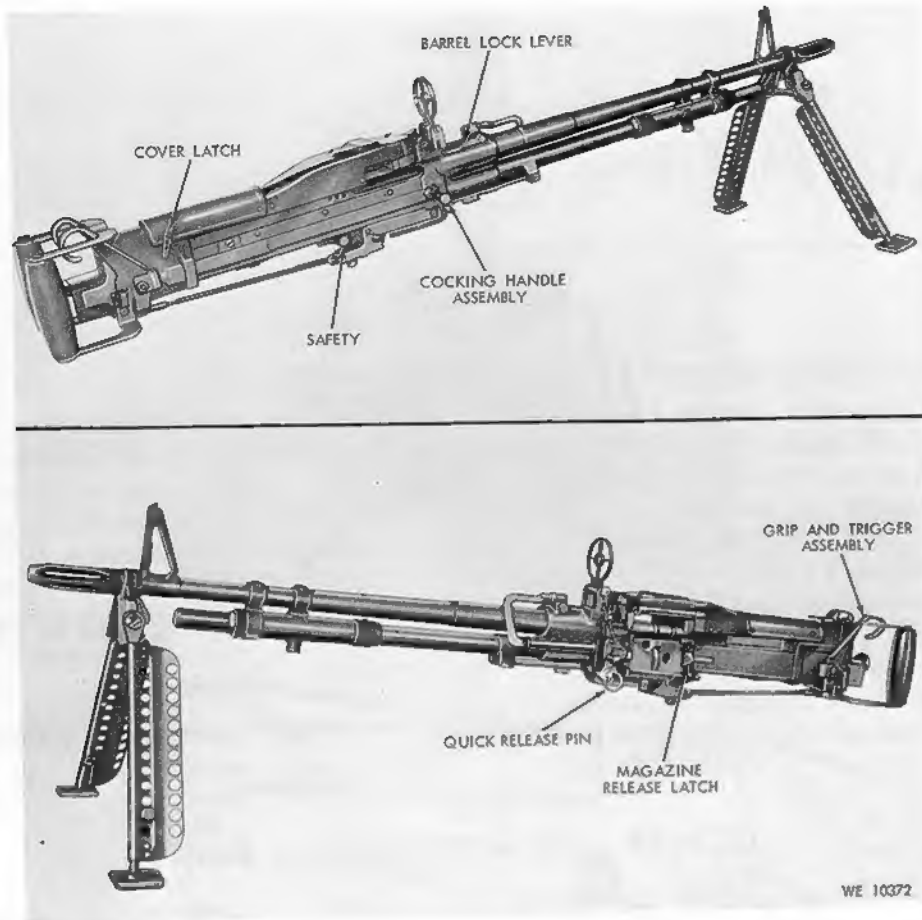

Figure 1-3. Flexible 7.62-millimeter machine gun XM60D subsystem XM23 and XM24—right and left view.

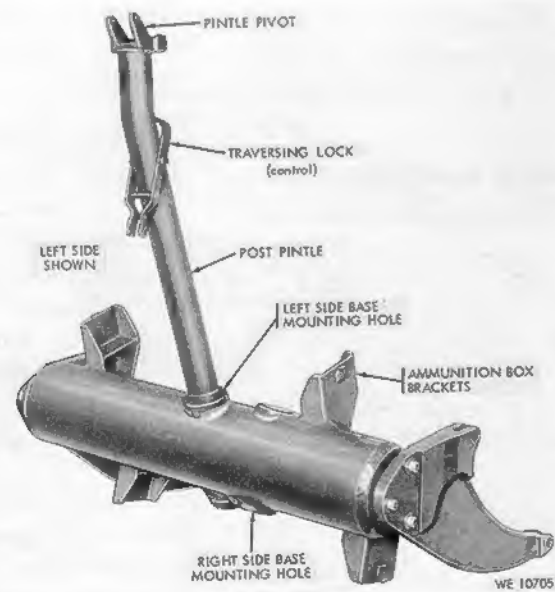

Figure 1-4. Mount assembly XM23—left side shown.

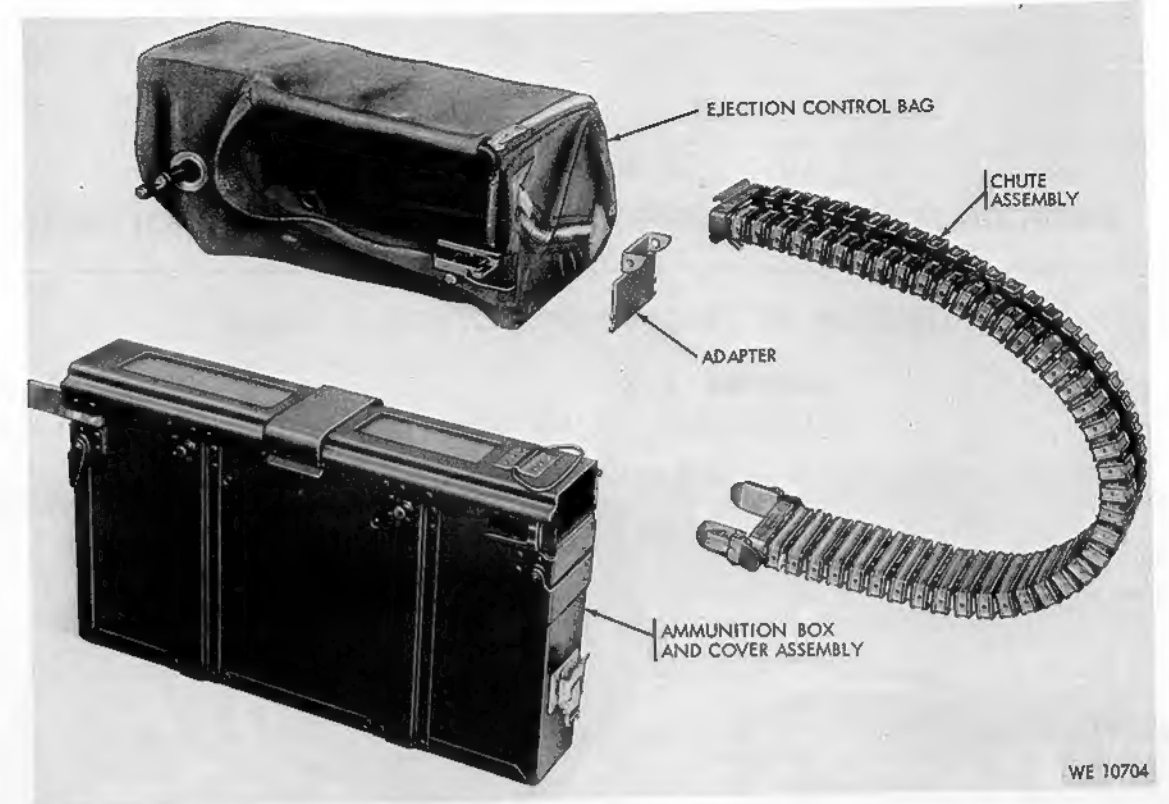

Figure 1-5. Equipment for mount assembly XM23—right and left sides.

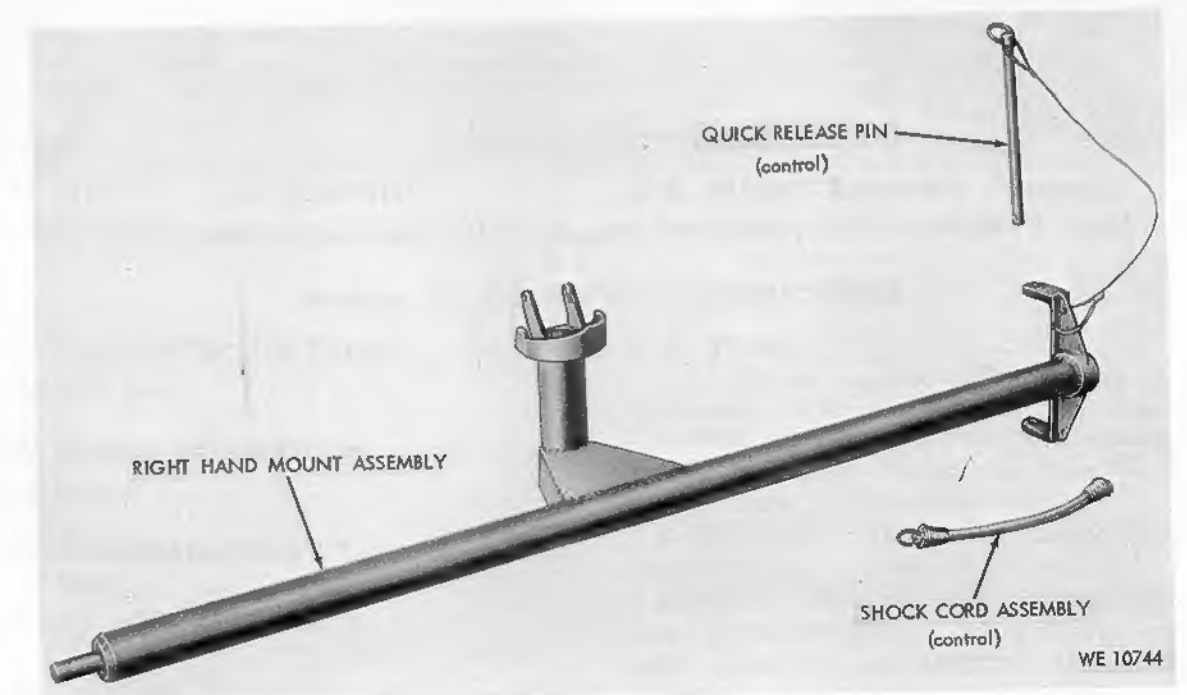

Figure 1-6. Mount assembly XM24—left side shown.

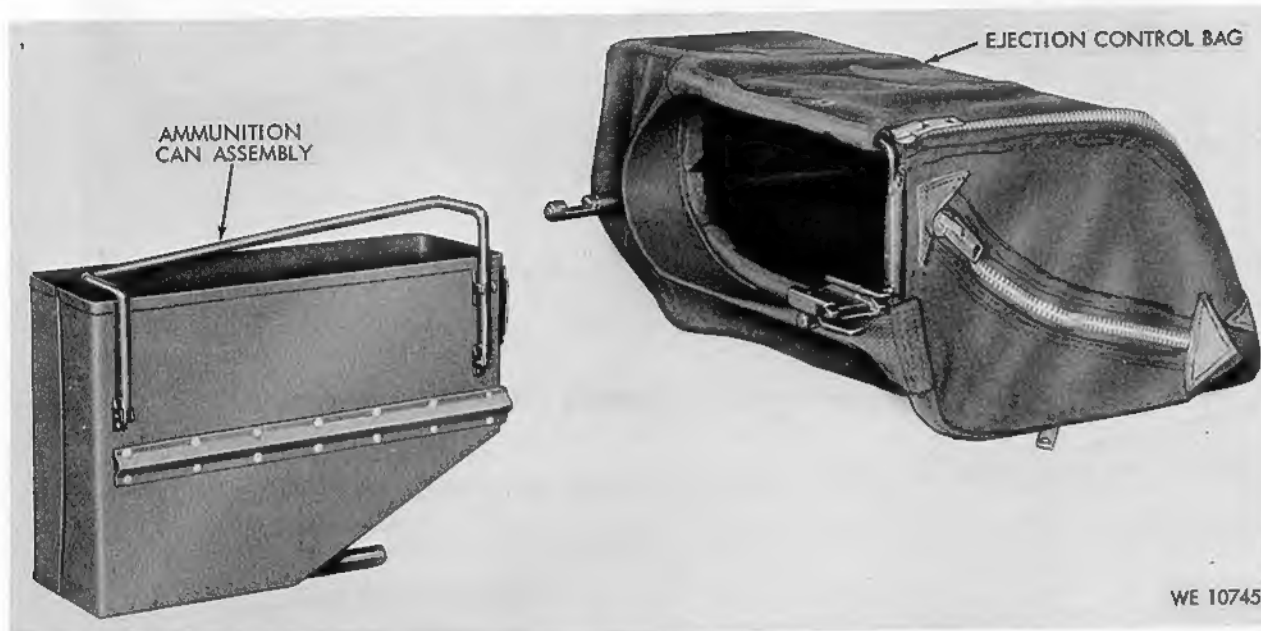

Figure 1-7. Equipment for mount assembly XM24—right and left sides.

CHAPTER 2 OPERATOR AND GROUND CREW OPERATIONAL INSTRUCTIONS

Section I. SERVICE UPON RECEIPT OF MATERIEL

2-1. Scope

The instructions covered in this chapter are to be performed by the operator and aircraft armament repairman.

2-2. Services

See table 2-1.

TABLE 2-1. Service Upon Receipt of Materiel

Item	Checks and Procedures	References
Tools.....	Check against packing list in packing box for missing items.....	Appx I
Equipment.....	Missing items and condition of items.....	Appx I
Mount assembly XM23.....	Check mount assemblies for damage, missing parts and unpainted surfaces.	TM 9-213 and Appx I
or		
Mount assembly XM24		
Machine gun XM60D.....	Remove ¹ VCI packaging, clean barrel, remove plastic cap, ² operate weapon and lubricate.	Para 3-7 Lubrication chart
Barrel assembly.....	Remove ¹ VCI packaging, clean barrel, install gun and check for positive retention, check bipod legs, and place in carrying case.	Para 3-7 Appx I Lubrication chart

¹ VCI wrapped weapons, equipment, and parts not immediately used will be stored in their VCI packings.

² Retard forward force of bolt assembly to prevent damage to tray assembly when no ammunition is present.

Section II. CONTROLS

2-3. Machine Gun Controls

Controls are shown in figure 1-3.

2-4. Mount Assembly Controls

Controls are shown in figure 1-4 and 1-6.

Section III. OPERATING INSTRUCTIONS

2-5. Preparation for Firing

See table 2-2.

2-6. Service Before Firing

See table 3-1.

2-7. Troubleshooting Chart for Operator

Refer to TM 9-1005-224-12.

2-8. Loading

Refer to figure 2-13.

2-9. Firing

Note. Harness assembly will be worn at all times and attached to aircraft when firing the weapon.

a. With machine gun positioned, loaded, and aimed, push safety button (fig. 2-12) to FIRE "F" position.

b. Pull trigger fully and hold to fire gun automatically.

c. Due to low cyclic rate of fire of machine gun, single rounds or short bursts can be easily fired. Trigger must be completely released for each shot to fire single rounds or to interrupt firing at any time.

Note. When a single round only is to be fired, retract bolt assembly, move safety button to SAFE "S" position, open cover assembly, make sure chamber is empty, position de-linked round in the tray assembly groove, and close cover assembly to hold round in place.

Note. When belt is exhausted, the last two links will remain in tray assembly. Links and end link plug can be removed by hand after cover assembly is opened for loading.

TABLE 2-2. Preparation for Firing

Sequence No.	Procedures	References
1.....	Install mount assemblies—XM23 or XM24.....	Fig. 2-1, 2-2, and 2-3
2.....	Install machine gun XM60D.....	Fig. 2-4
3.....	Check bipods.....	TM 9-1005-224-12
4.....	Check traverse right and left, and depression of subsystem XM23.....	Fig. 2-5
5.....	Check traverse right and left, and depression of subsystem XM24.....	Fig. 2-6
6.....	Install ejection control bag.....	Fig. 2-7
7.....	Install ammunition box and cover assembly and chute assembly for subsystems XM23.....	Fig. 2-8, 2-9
8.....	Install ammunition can assembly for subsystem XM24.....	Fig. 2-10
9.....	Charge weapon.....	Fig. 2-11
10.....	Push safety into SAFE "S" position.....	Fig. 2-12
11.....	Load ammunition.....	Fig. 2-13
12.....	Stow weapon until used for subsystem XM23 or XM24.....	Fig. 2-14, 2-15

2-10. Failure to Fire

a. *Misfire.* A misfire is a complete failure to fire. It must be treated as a hangfire until such possibility has been eliminated.

b. *Hangfire.* A hangfire is a delay in functioning of a propelling charge. Time intervals prescribed in paragraph 2-11 should be observed after a failure to fire.

c. *Cook-Off.* A cook-off is firing of the chambered round due to heat of a hot barrel. A cook-off may occur from ten seconds to five minutes after round has been in contact with a hot barrel.

2-11. Immediate Action Procedures for Removing a Round in Case of Failure to Fire

a. If a stoppage occurs, wait five seconds, retract cocking handle assembly to rear, insuring that operating rod assembly remains to the rear.

b. If round is ejected, return cocking handle assembly to forward position, relay on target and attempt to fire. If weapon does not fire, it must be cleared and weapon and ammunition inspected to determine cause of stoppage.

c. If round is not ejected, move the safety to SAFE "S" position. Remove ammunition and

links, inspect receiver assembly and move the safety to FIRE "F" position, and attempt to fire. If round does not fire and barrel is considered hot enough to cause a cook-off (200 rounds fired within two minutes), wait five minutes with the bolt assembly in the forward position. Remove round, reload.

Note. Disregard the five minute wait if weapon is not hot enough to cause a cook-off.

2-12. Runaway Gun

If gun continues to fire after trigger assembly has been released, immediately open cover assembly permitting the bolt assembly to go underneath the round of ammunition and stop in the forward position.

2-13. Extracting a Ruptured Cartridge Case

Position ruptured cartridge case extractor in chamber. Insert cleaning rod into muzzle end of barrel and, by tapping lightly with the hand, remove extractor.

2-14. Unloading

Raise cover assembly, remove link belt. Inspect the chamber.

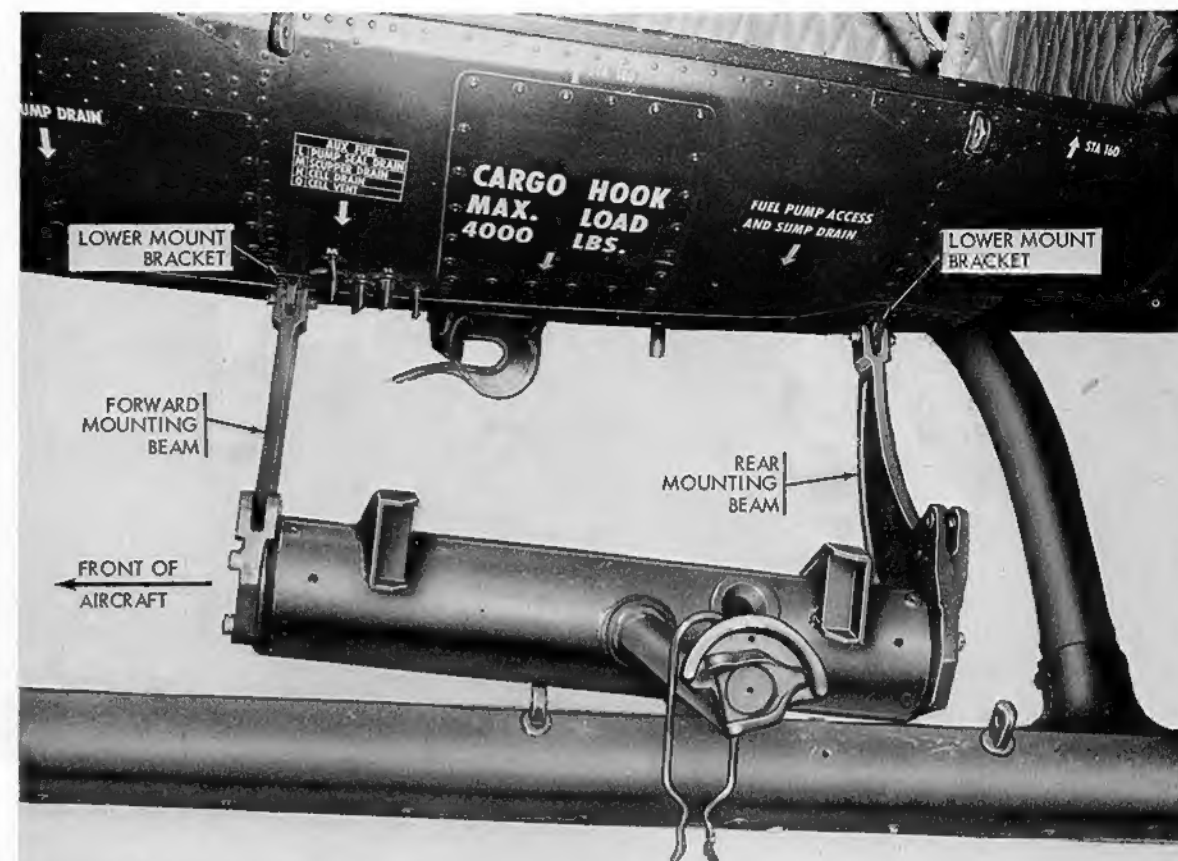

STEP 1 - INSTALL OR REMOVE FORWARD AND REAR MOUNTING BEAMS ON LOWER MOUNT BRACKETS.

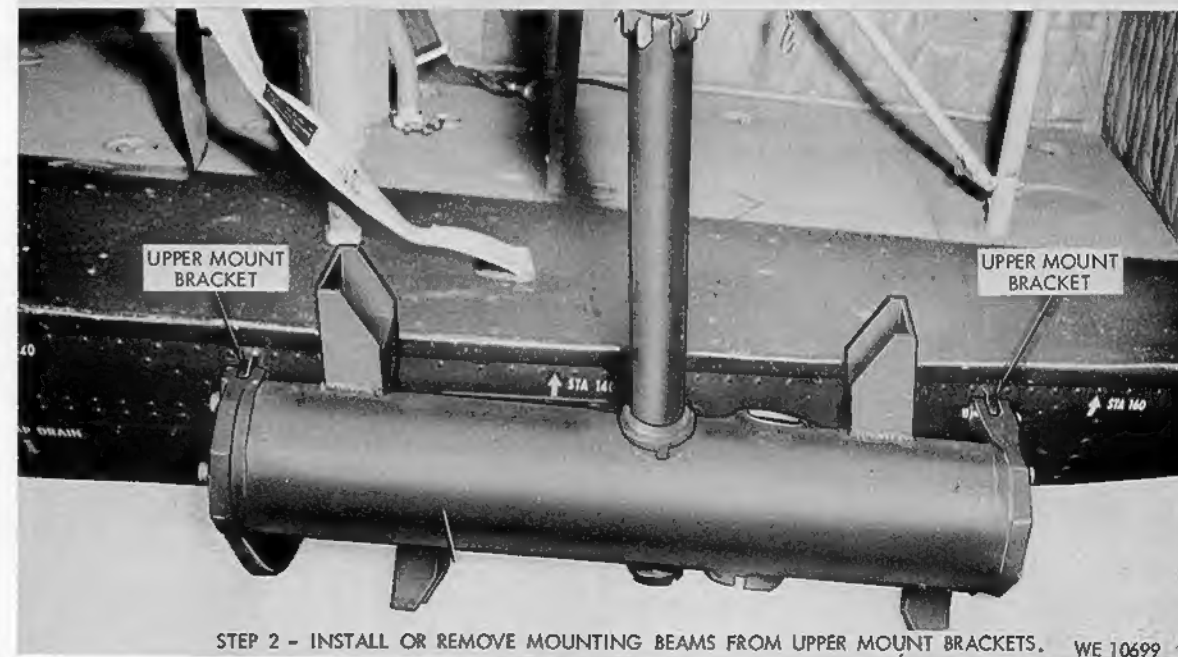

STEP 2 - INSTALL OR REMOVE MOUNTING BEAMS FROM UPPER MOUNT BRACKETS. WE 10699

Figure 2-1. Removal or installation of mount assembly XM23—UH-1D helicopter—left side shown.

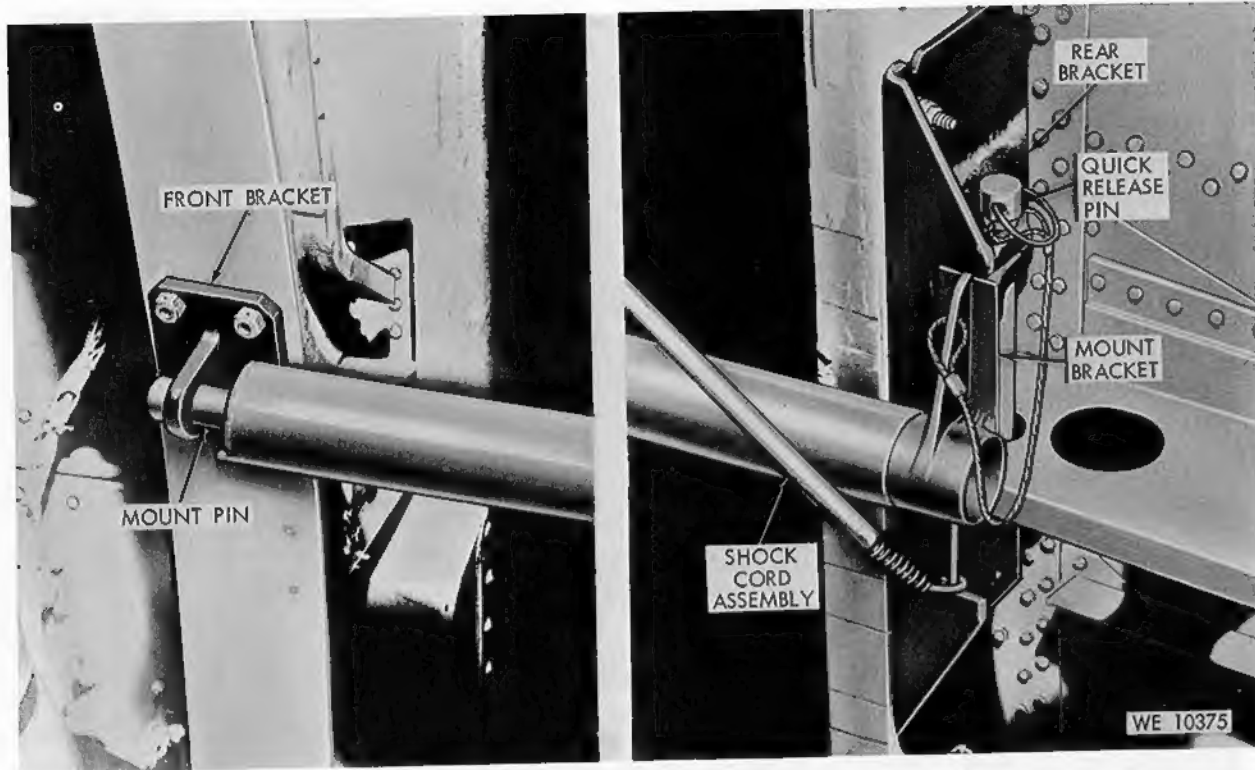

Figure 2-2. Removal or installation of mount assembly XM24—CH-47A helicopter—left side shown.

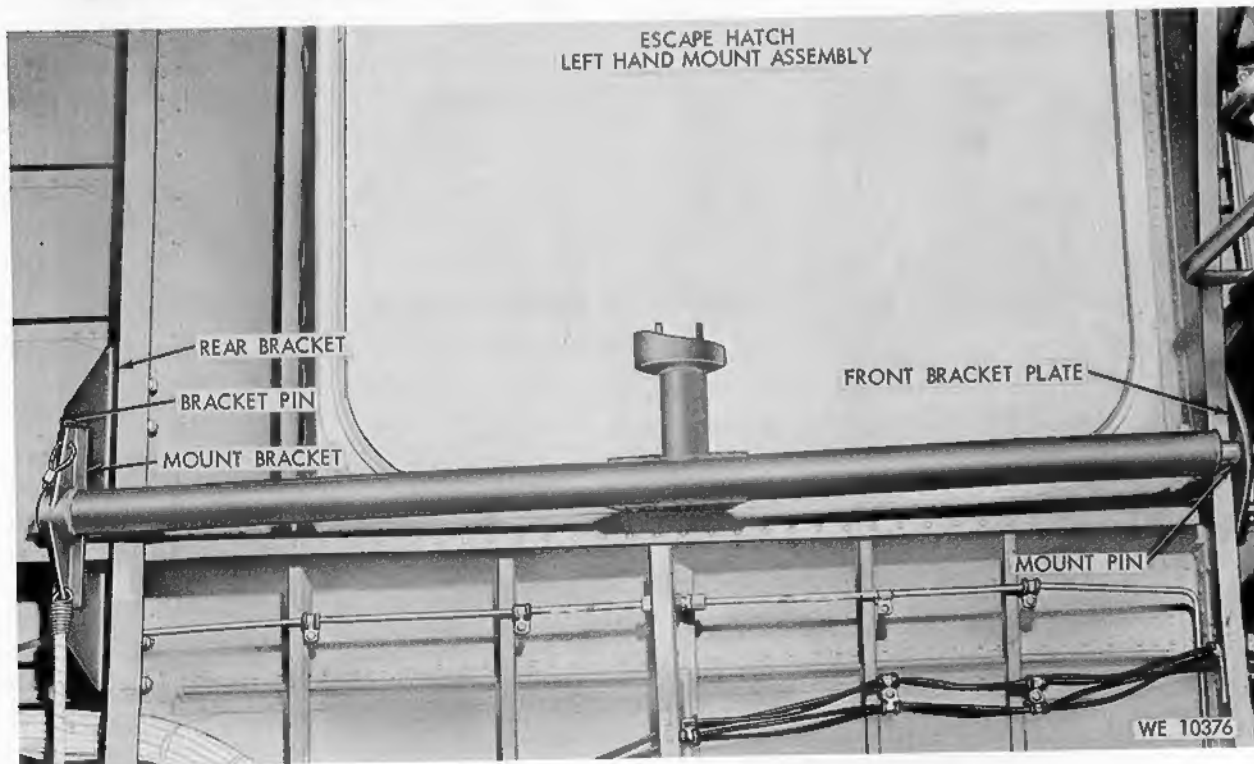

Figure 2-3. Removal or installation of mount assembly XM24—CH-47A helicopter—right side shown.

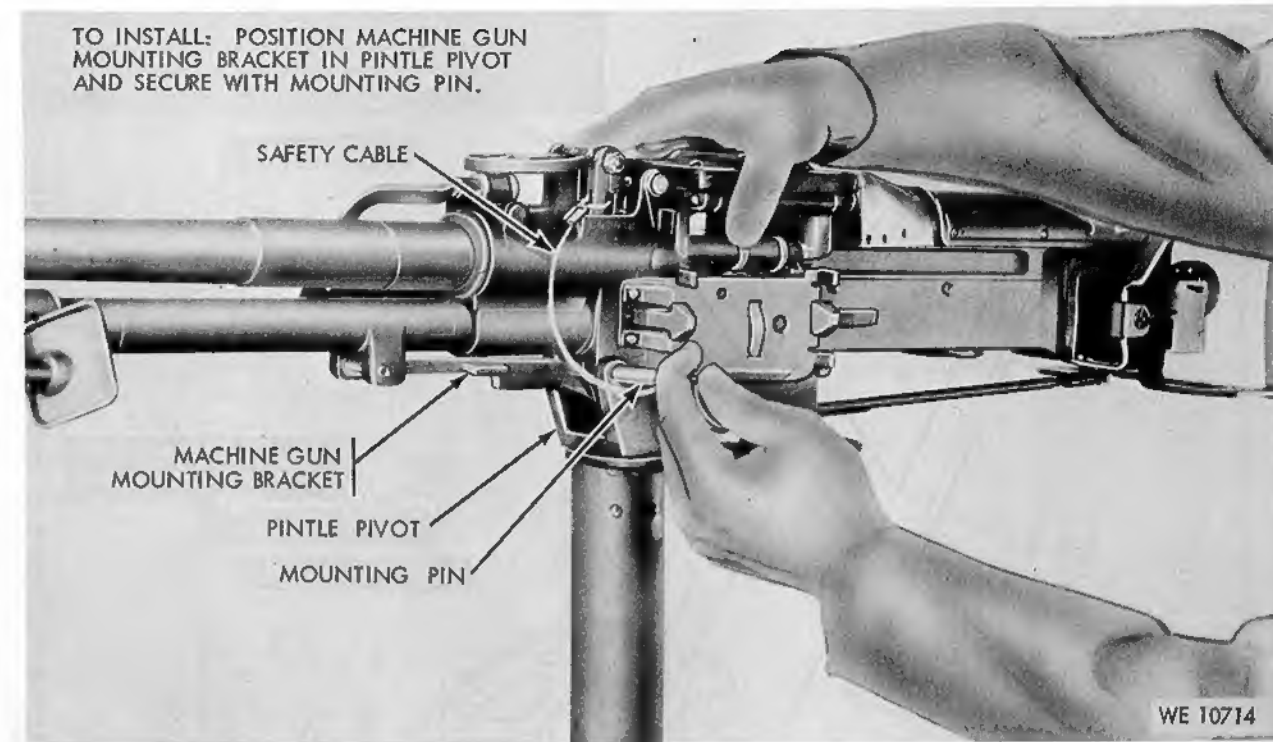
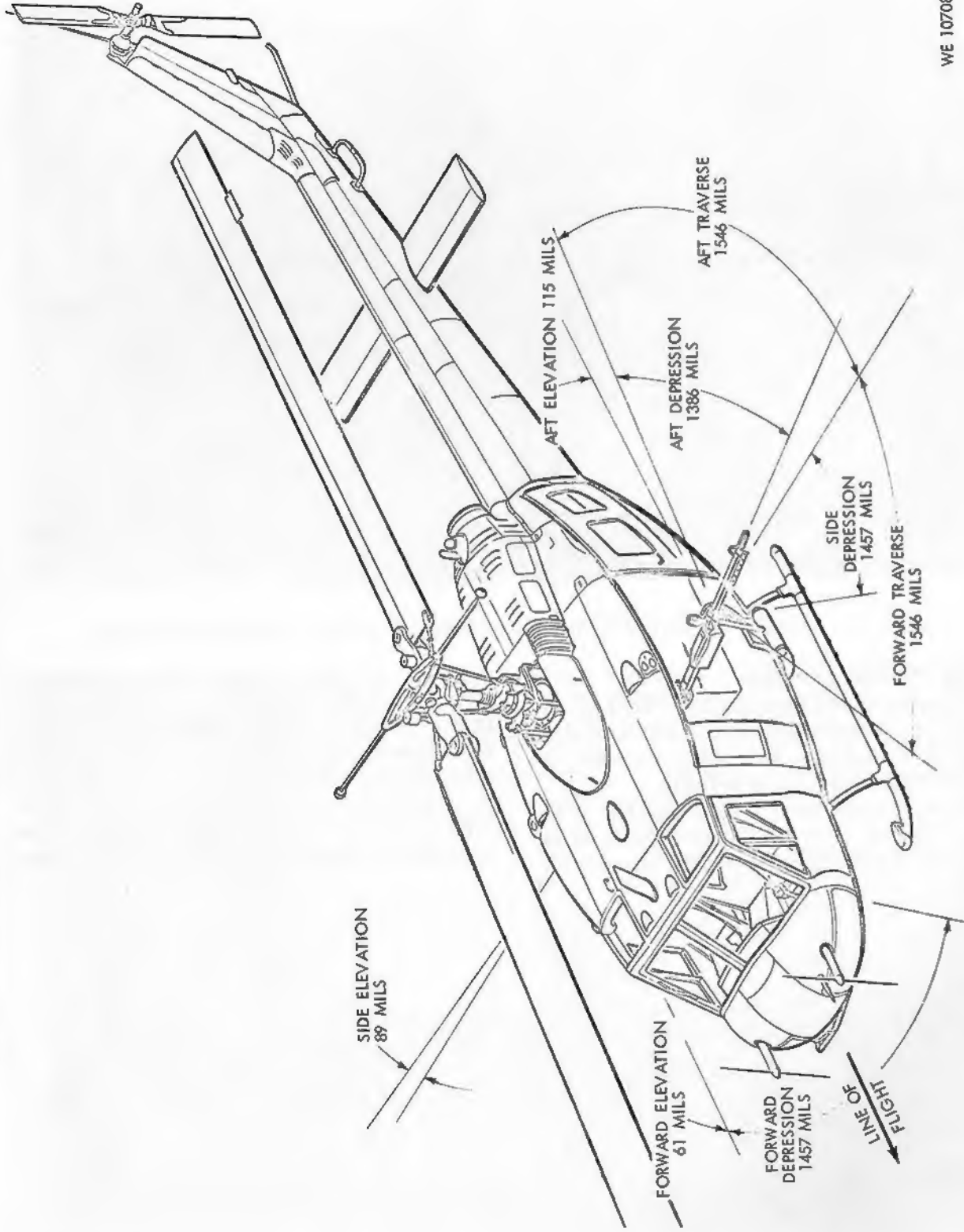

Figure 2-4. Machine gun XM60D positioned on left or right mount assembly XM23 or XM24.

2-15. Double Feeding

Whenever a stoppage occurs with bolt assembly in forward position, assume that a round is chambered and stoppage must be treated as a hangfire (para 2-10b). Under no circumstances, following any stoppage, will bolt assembly be retracted and allowed to go forward (without first having

inspected chamber to ensure that it is clear) stripping another round from ammunition belt. In event such a chamber inspection is not performed and a round remains undetected in the chamber, the nose of second round can detonate the primer of the chambered round causing an explosion in receiver assembly. Damage to the weapon and/or injury to personnel could result.



WE 10708

Figure 2-5. Machine gun XM60D installed and traversed in the forward aft and down positions—UH-1D helicopter.

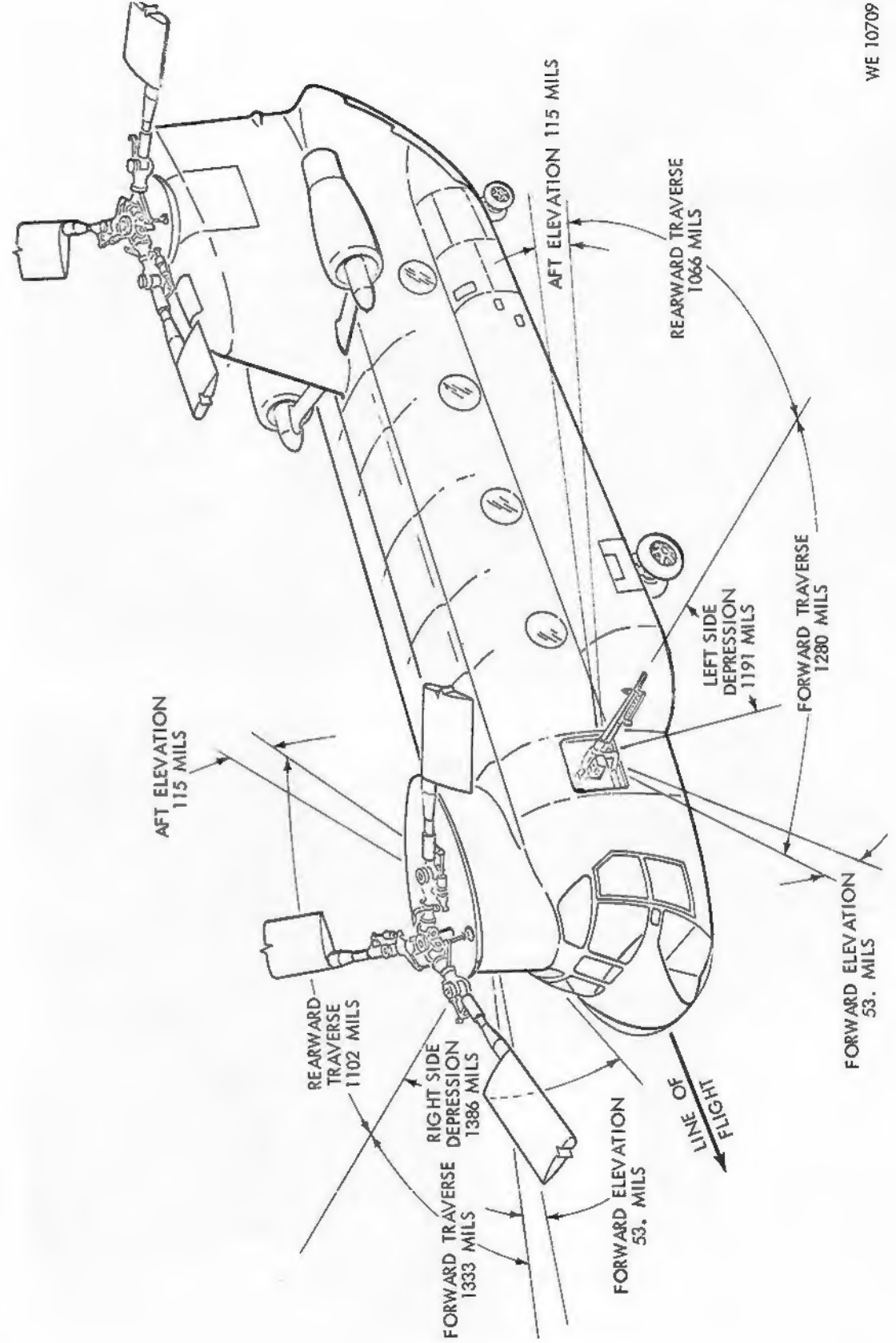

WE 10709

Figure 2-6. Machine gun XM60D installed and traversed in the forward aft and down positions—CH-47A helicopter.



STEP 1 - POSITION EJECTION CONTROL BAG UNDER BAG MOUNTS.

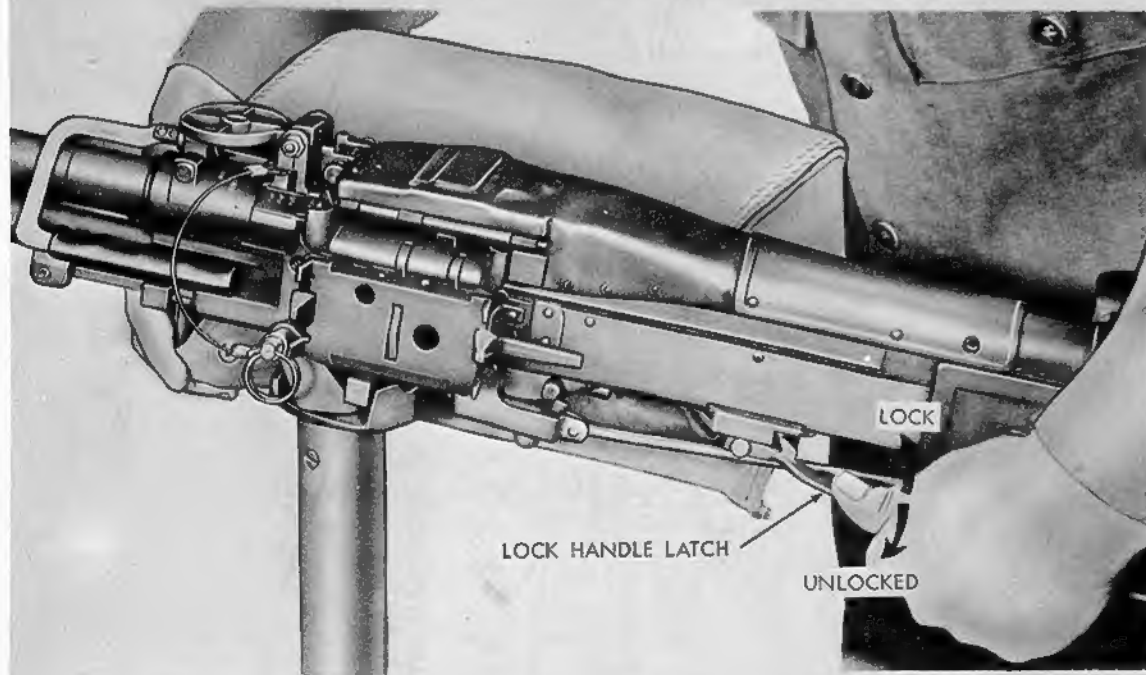

STEP 2 - LOCKED OR UNLOCKED POSITION.

WE 10475

Figure 2-7. Removal or installation of ejection control bag—subsystem XM23 or XM24.

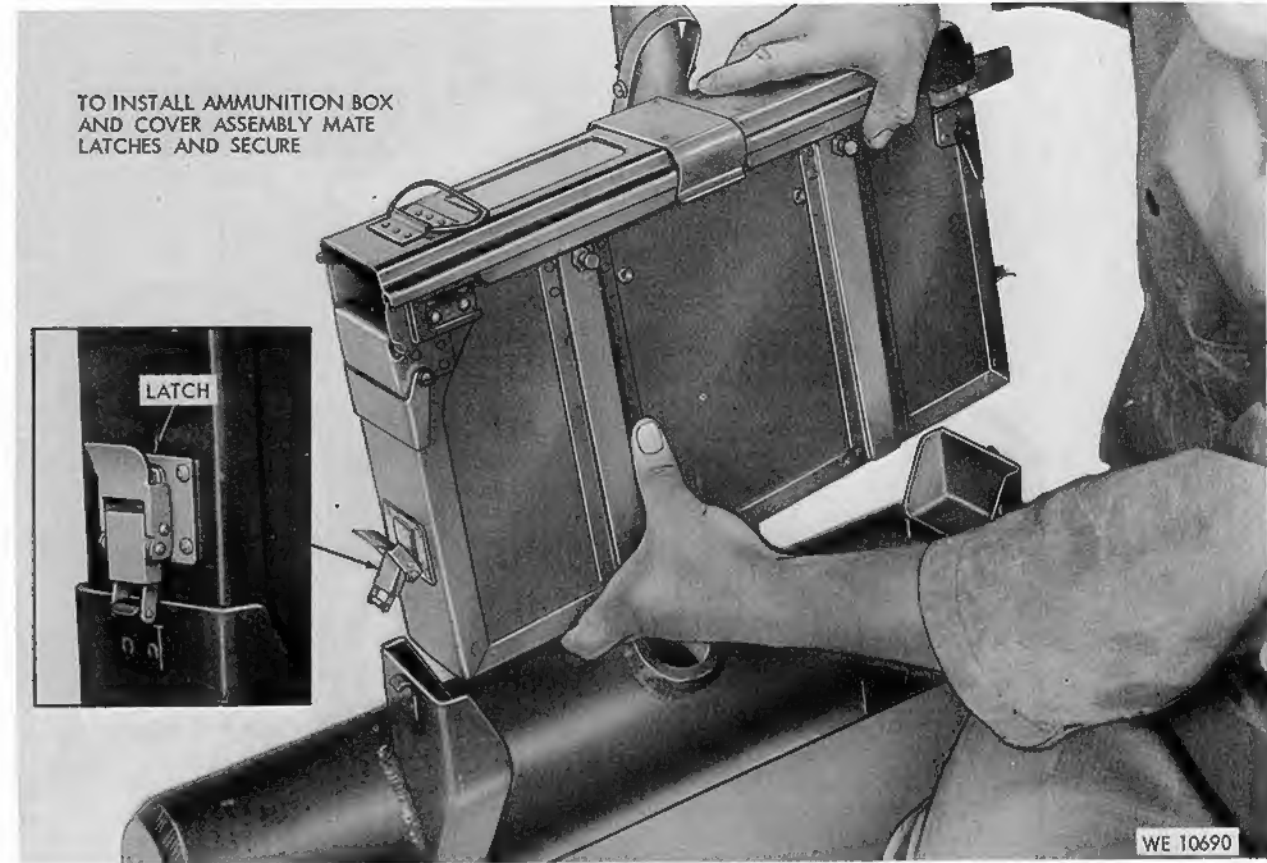

Figure 2-8. Removal or installation of ammunition box and cover assemblies on mount assembly XM23.

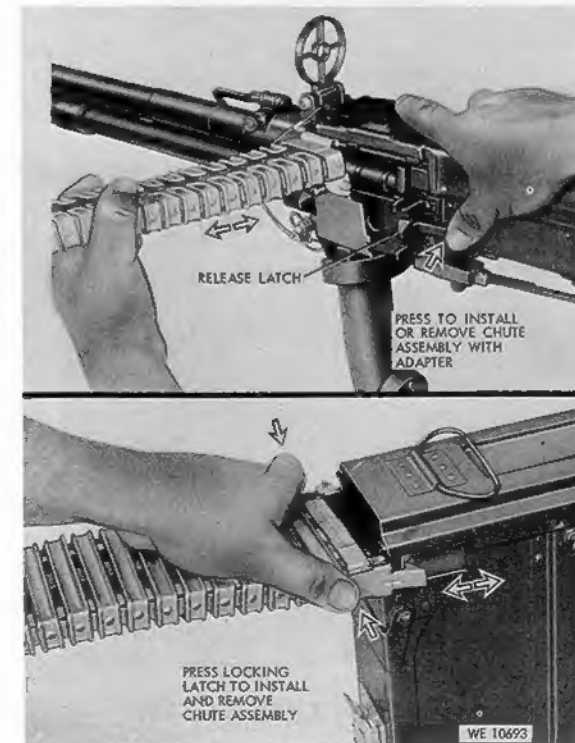

Figure 2-9. Removal or installation of the chute assembly—subsystem XM23.

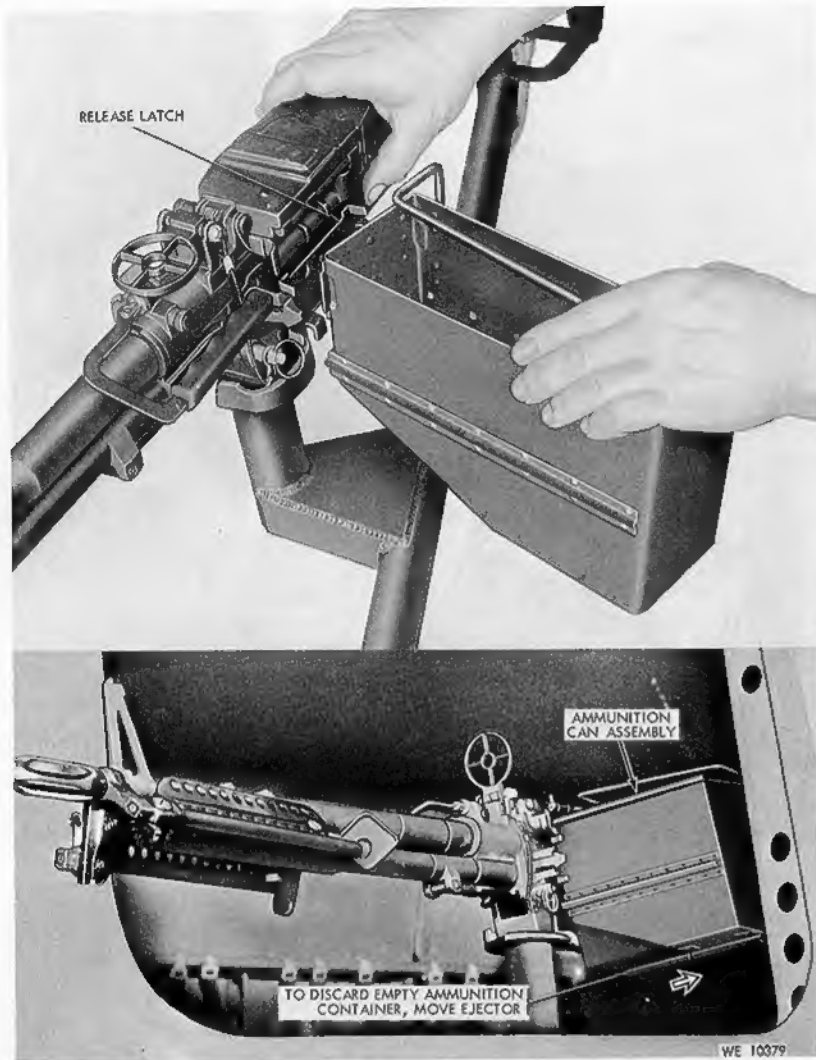

Figure 2-10. Removal or installation of ammunition can assemblies on machine gun XM60D—subsystem XM24.

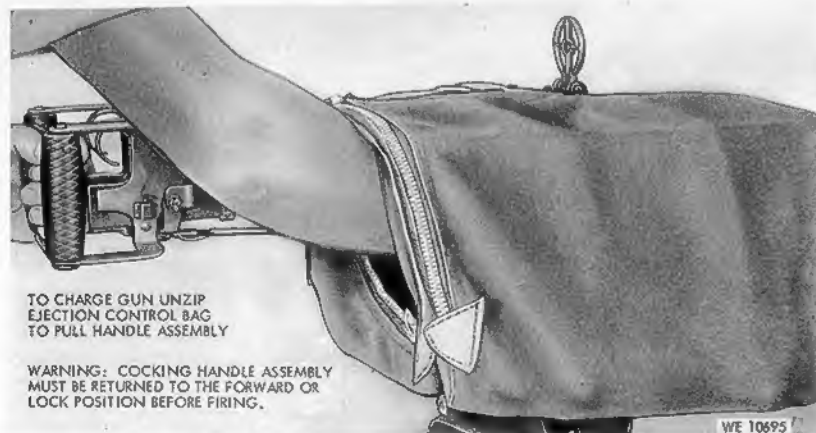

Figure 2-11. To charge machine gun XM60D—subsystem XM23 and XM24.

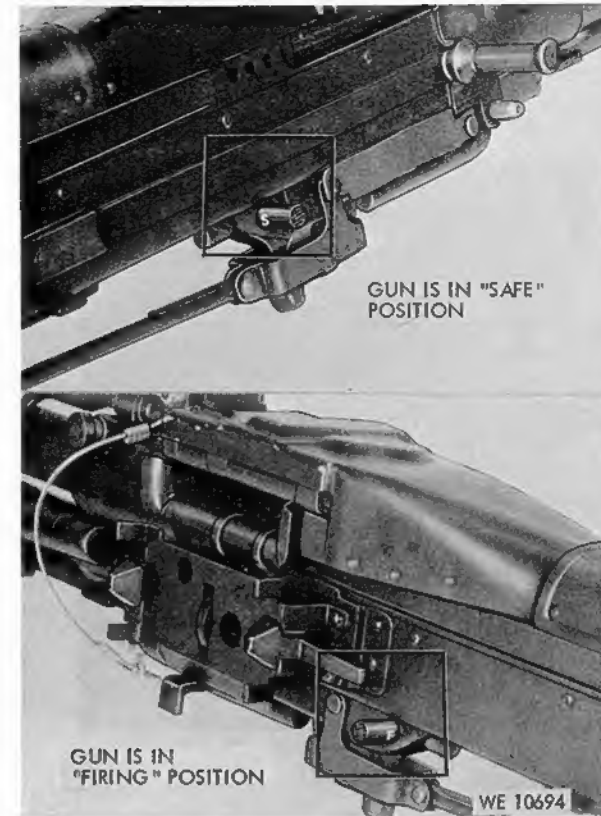

Figure 2-12. Location and identification of SAFE "S" and FIRING "F" positions of machine gun XM60D.

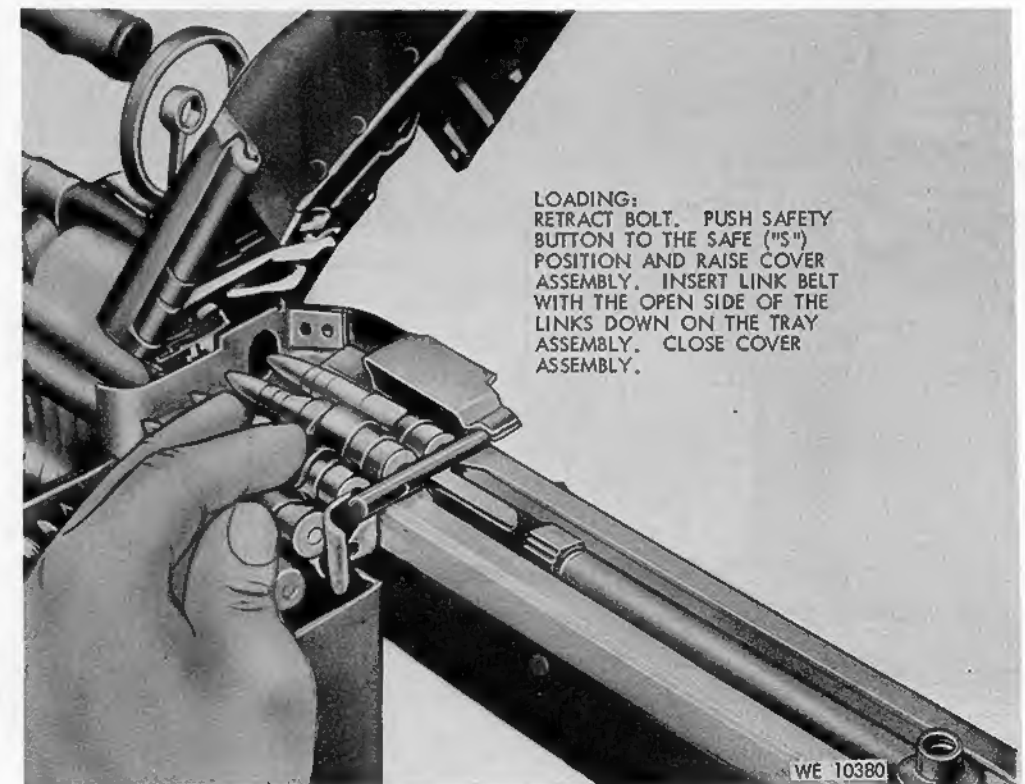

Figure 2-13. Positioning link belt on the cartridge tray assembly—subsystem XM23 or XM24.

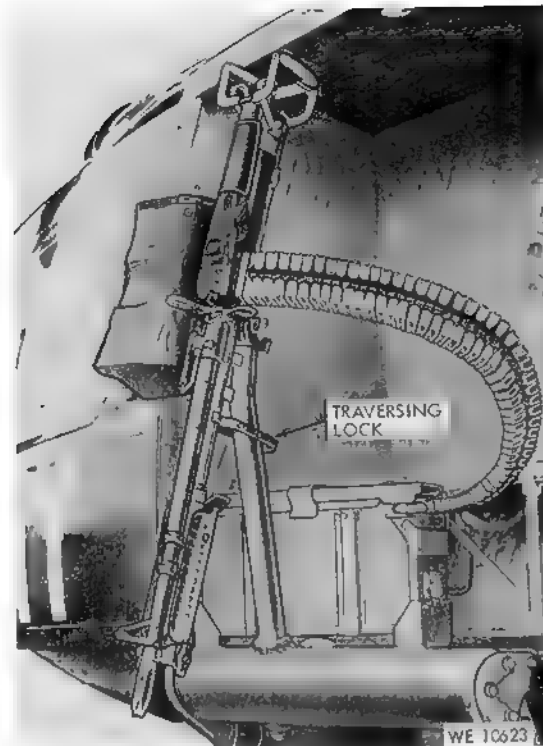

Figure 2-14. Machine gun XM60D installed—subsystem XM2S—showing traversing lock in stowed position.

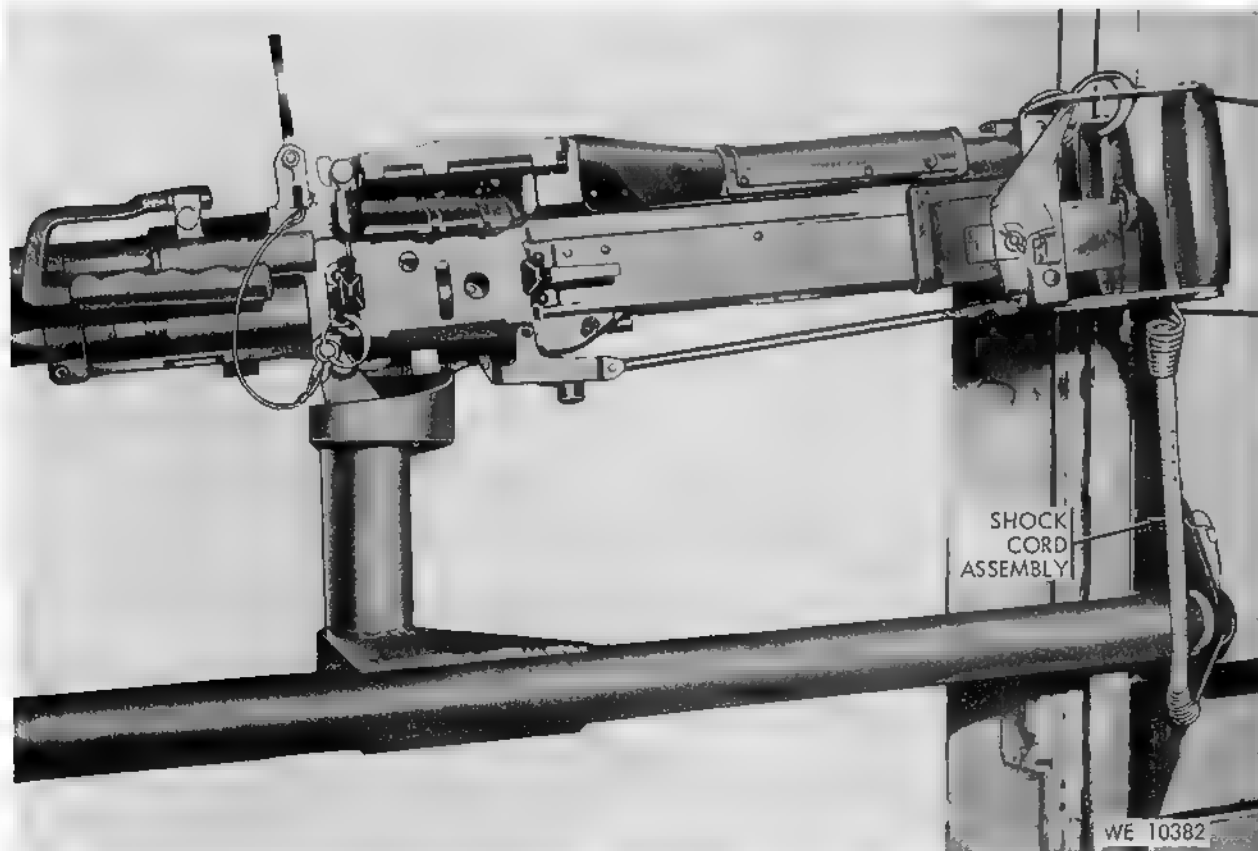

Figure 2-15. Machine gun XM60D installed—subsystem XM24—showing cord assembly in stowed position.

CHAPTER 3 ORGANIZATIONAL MAINTENANCE INSTRUCTIONS

Section I. REPAIR PARTS, TOOLS, AND EQUIPMENT

3-1. Repair Parts

See appendices I and II.

3-2. Tools and Equipment

See appendices I and II.

Section II. LUBRICATION AND PAINTING

3-3. Lubrication Chart

See Lubrication chart (fig. 3-1).

3-4. Painting

Refer to TM 9-218 and TM 9-208-1.

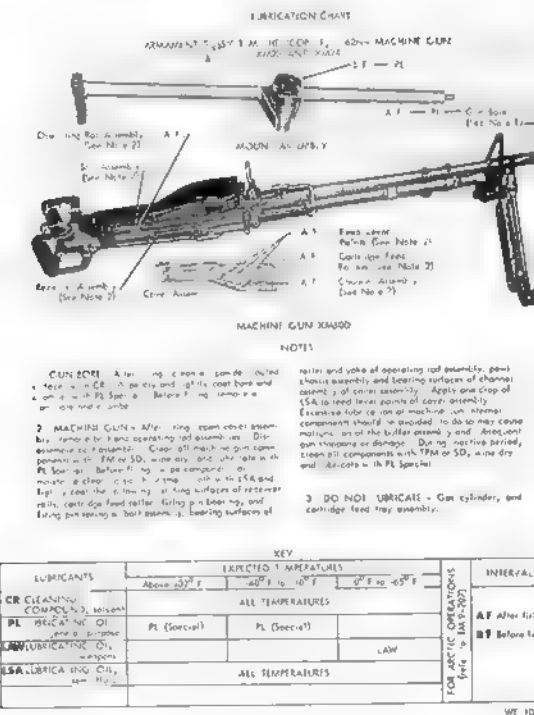

Figure 3-1. Lubrication chart.

Section III. PREVENTIVE-MAINTENANCE CHECKS AND SERVICES

3-5. Services Instructions

a. Daily Inspection. Refer to table 3-1.

b. Intermediate Inspection. (25 flying hours)

Refer to table 3-2.

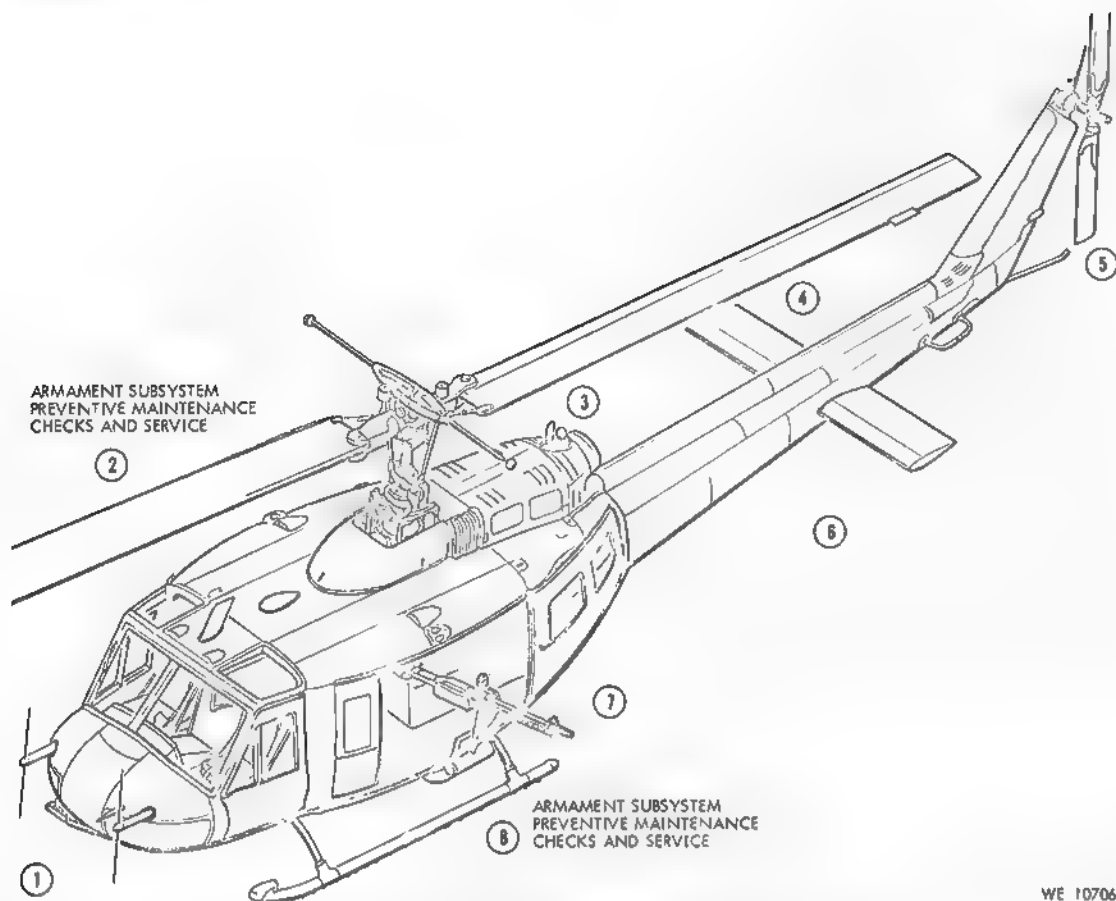

Figure 3-2. Exterior inspection diagram UH-1D helicopters.

WE 10706

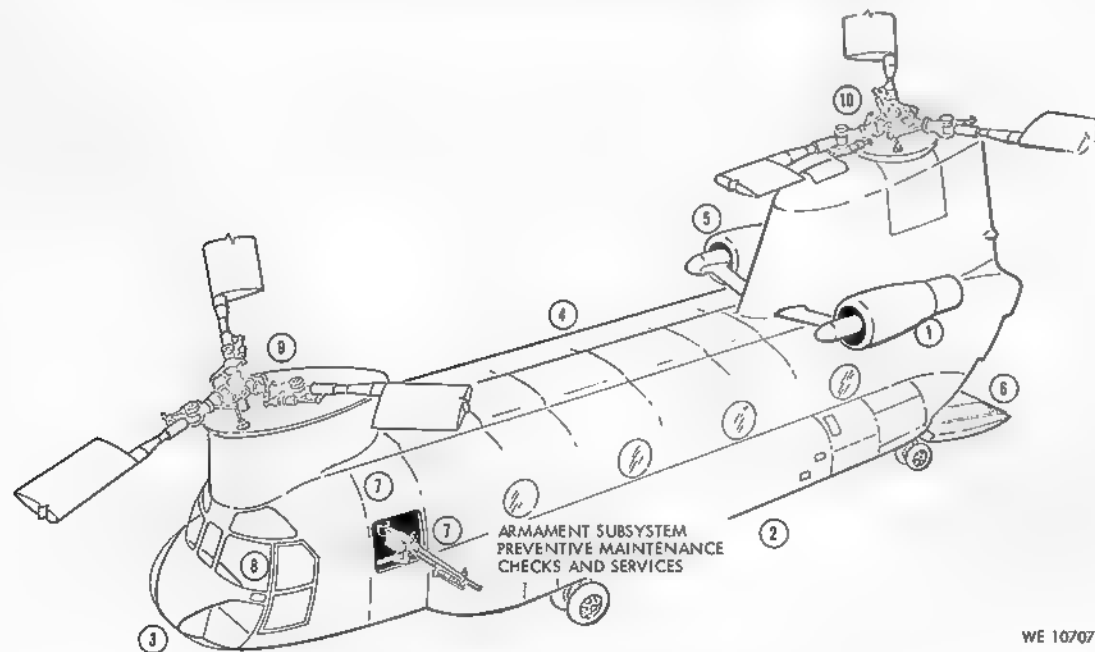

Figure 3-3. Exterior inspection diagram CH-47A helicopters.

WE 10707

Organizational Maintenance

TABLE 3-1. Preventive Maintenance Checks and Services

Daily Inspection

Sequence number	Required every	Item and procedure	Paragraph reference
MACHINE GUN XM60D			
1.....	Pre-flight.....	Barrel assembly bore and chamber—Must be dry and free of foreign objects.	TM 9-1005-224-12
2.....	Pre-flight.....	Barrel lock lever—Check to assure positive retention of barrel.....	Figs. 3-5, 3-6 and 4-1.
HELICOPTER UH-1D			
3.....	Pre-flight.....	Mount assembly—Check mount assembly for secure attachment to helicopter hard points. See that pintle post is secured in its base.	Fig. 2-1 and fig. 3-2 for location area.
HELICOPTER CH-47A			
4.....	Pre-flight.....	Mount assembly—Check mount assembly for secure installation horizontally across the cabin doorway on the right side and the escape hatch on the left side of the CH-47A helicopter.	Figs. 2-2, 2-3, and fig. 3-3 for location area.
5.....	Post-flight.....	Machine guns and mount assemblies—Clean and lubricate in accordance with lubrication chart.	Fig. 3-1 and para. 3-7.

c. Location of Inspection Areas. In both tables, checks and services to be performed will be made in areas 2 and 8 shown on figure 3-2 and in area 7 shown on figure 3-3.

d. The "sequence numbers" column of tables 3-1 and 3-2 provides the identification numbers which are to be used when reporting uncorrected deficiencies on DA Form 2404.

3-6. Cleaning Instructions

a. General cleaning instructions are outlined in paragraphs (1) through (3) below and TM 9-247.

- (1) Use dry-cleaning solvent (SD) or mineral spirits paint thinner (TPM) to clean or wash grease or oil from all metal parts.
- (2) Use solvent cleaning compound (CR) (formerly rifle bore cleaner) to clean all parts which have been subjected to powder fouling during firing.
- (3) After the parts are cleaned, rinse and dry them thoroughly. Apply a light coat of PL special or LAW lubricating oil to all polished metal surfaces to prevent rusting.

TABLE 3-2. Preventive Maintenance Checks and Services

Organizational Maintenance

Intermediate Inspection

Sequence number	Required every	Item and procedure	Paragraph reference
MACHINE GUN XM60D			
1.....	Intermediate.....	Barrel assembly w/bipod assembly—Check for unusual wear and damage to bore. Check flash suppressor for distorted ribs. Replace barrel assembly w/bipod assembly if necessary.	TM 9-1005-224-12
2.....	Intermediate.....	Cover assembly—Manually operate components to assure freedom of movement. Test cover latch to insure that cover is retained in closed position.	TM 9-1005-224-12
3.....	Intermediate.....	Buffer assembly—Inspect for oil leaks, rust or defect that may affect operation. Replace if necessary.	Fig. 3-5 and para. 3-13.
4.....	Intermediate.....	Bolt assembly—Inspect ejector and extractor for freedom of movement. Inspect components for evidence of chipping and cracks; replace if necessary.	TM 9-1005-224-12
5.....	Intermediate.....	Receiver assembly—Inspect for loose rivets. Check rails inside receiver assembly for distortion and chipping.	TM 9-1005-224-12
6.....	Intermediate.....	Grip and trigger assembly—Check for freedom of movement and check link and spring sear assemblies for proper adjustment. Replace damaged components and readjust link and spring sear assembly.	Fig. 3-6 and para. 3-11 and 3-19.
7.....	Intermediate.....	Sear and safety housing assembly—Inspect for freedom of movement, weakened or broken springs and missing components. Replace if necessary.	Fig. 3-7 and para. 3-12.
8.....	Intermediate.....	Lubrication—Clean and oil as instructed in lubrication chart.....	Fig. 3-1 and para. 3-6.
HELICOPTER UH-1D			
9.....	Intermediate.....	Mount assembly XM23—Inspect base and beams for cracks and distortion. Check traversing lock for securing the machine gun.	Fig. 2-1 and para. 3-21.
HELICOPTER CH-47A			
10.....	Intermediate.....	Mount assembly XM24—Inspect brackets for cracks or distortion. Inspect pin and cord assembly for secure attachment on cabin doorway on right hand side.	Fig. 2-2 and para. 3-25.
11.....	Intermediate.....	Mount assembly XM24—Inspect brackets for cracks or distortion. Inspect pin and cord assembly for secure attachment on escape hatch on left side.	Fig. 2-3 and para. 3-25.

Section IV. TROUBLESHOOTING

3-7. Scope

Refer to table 3-3.

TABLE 3-3. Troubleshooting

Malfunction	Probable cause	Corrective Action
Machine Gun XM60D		
Failure to feed.....	Insufficient gas pressure.....	Clean gas port TM 9-1005-224-12.
	Feed pawl assembly defective.....	Replace TM 9-1005-224-34.
	Feed pawl spring defective.....	Replace TM 9-1005-224-34.
	Front and rear cartridge guides defective.....	Replace TM 9-1005-224-34.
	Feed lever cam spring defective.....	Replace TM 9-1005-224-34.
	Cartridge feed roller defective.....	Replace TM 9-1005-224-34.
	Lubrication inadequate.....	See lubrication chart.
	Belt installed incorrectly.....	Reverse belt with open portion of link down.
	Defective cover latch.....	Replace TM 9-1005-224-34.
	Damaged or weakened operating rod spring.....	Replace TM 9-1005-224-12.
Failure to chamber.....	Obstruction by foreign material in receiver.....	Remove foreign material and lubricate as required.
	Ruptured cartridge case.....	Remove (para 2-13).
Failure to fire.....	Caked carbon in gas cylinder piston or receiver assembly.....	Remove carbon TM 9-1005-224-12.
	Damaged round.....	Recharge weapon (fig. 2-11).
	Broken or damaged firing pin or spring.....	Replace TM 9-1005-224-12.
	Faulty ammunition.....	Replace (para 1-3).
	Dirty chamber.....	Clear then clean or replace barrel, if necessary.
Failure to extract.....	Weakened or damaged operating rod compression helical spring.....	Replace TM 9-1005-224-12.
	Loose grip and trigger assembly.....	Tighten screw retainer assembly.
	Broken extractor or spring.....	Replace TM 9-1005-224-12.
Failure to eject.....	Short recoil.....	Clean out gas port with wrench TM 9-1005-224-12.
	Gas piston installed backward.....	Install properly TM 9-1005-224-12.
Failure to cock.....	Short recoil.....	Clean out gas port with wrench TM 9-1005-224-12.
	Frozen or damaged ejector or ejector spring.....	Clean and/or replace TM 9-1005-224-12.
	Broken sear.....	Replace (para 3-12 and 3-19, and fig. 3-8).
	Deformed link and spring notch.....	Replace (para 3-12 and fig. 3-8).
Restricted pintle pivot movement.....	Broken, defective or missing sear plunger and/or compression helical spring.....	Replace (para 3-12 and fig. 3-8).
	Mount Assembly XM23	
Out of alignment.....	Dirty, rusty or damaged pintle pivot or ball steel bearings.....	Clean, repair or replace (para 3-20 and fig. 3-12).
	Twisted mounting beam, pintle post or tube assembly.....	Replace (fig. 3-12).
Mount Assembly XM24		
Restricted pintle pivot movement.....	Dirty, rusty, or damaged pintle pivot or ball steel bearings.....	Clean, repair or replace (para 3-24 and fig. 3-17).
	Twisted cord assembly or mount assembly.....	Replace (fig. 3-17)

Section V. MACHINE GUN XM60D

3-10. Barrel Assembly with Bipod Assembly

- a. Removal. Refer to figure 3-6.
- b. Disassembly and/or Assembly. Refer to TM 9-1005-224-12.
- c. Cleaning, Inspection, and Repair.
 - (1) Refer to TM 9-1005-224-12.
 - (2) If barrel assembly w/bipod assembly is unserviceable, return to direct support for repair or replacement.

3-11. Grip and Trigger Assembly

- a. Disassembly and/or Assembly. Refer to figure 3-7.
- b. Cleaning, Inspection, and Repair.
 - (1) Examine threads on retainer assembly for burred or worn condition. Replace if unserviceable.
 - (2) Examine all springs for proper tension, bent or broken coils. Replace if unserviceable.
 - (3) Replace hardware items that are bent or broken.
 - (4) If grip and trigger assembly is damaged, return machine gun to direct support for repair or replacement.
 - (5) Examine nut and link and spring (20 and 21, figure 3-5) for bent, broken condition, or thread damage. Replace if unserviceable.

3-12. Sear and Safety Housing Assembly

- a. Disassembly and/or Assembly. Refer to figure 3-8.
- b. Cleaning, Inspection, and Repair.
 - (1) Examine the spring (6 fig. 3-5) for bent or broken condition. Replace if unserviceable.
 - (2) Examine pin and adapter (3 and 9, fig. 3-5) for cracks and damage. Replace if unserviceable.
 - (3) Examine activator and housing for cracks and distortion. Replace activator and housing if unserviceable.
 - (4) Examine safety, sear, and plunger for burrs, wear, cracks, and other damage. Replace if unserviceable.

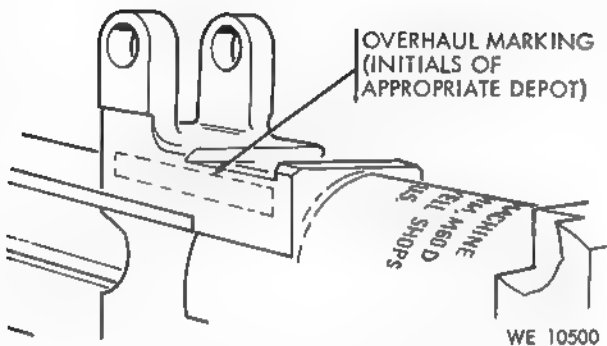

Figure 3-4. Location of overhaul mark.

3-8. Overhaul and Unserviceability Criteria

- a. Return machine gun through direct support for depot overhaul after firing approximately 50,000 rounds. The receiver of the overhauled gun will be stamped with the initials of the installation performing the overhaul (fig. 3-4), e.g. "RIA".
- b. Overhauled guns will be fired an additional 50,000 rounds. After the second 50,000 rounds fired, the weapon will be returned to direct support maintenance as unserviceable, not repairable, and will be disposed of in accordance with AR 755-20 and AR 755-21.

3-9. Machine Gun XM60D

- a. Disassembly and/or Assembly. Refer to figure 3-5 and TM 9-1005-224-12 for detailed instructions.
- b. Cleaning, Inspection, and Repair. Refer to TM 9-1005-224-12.

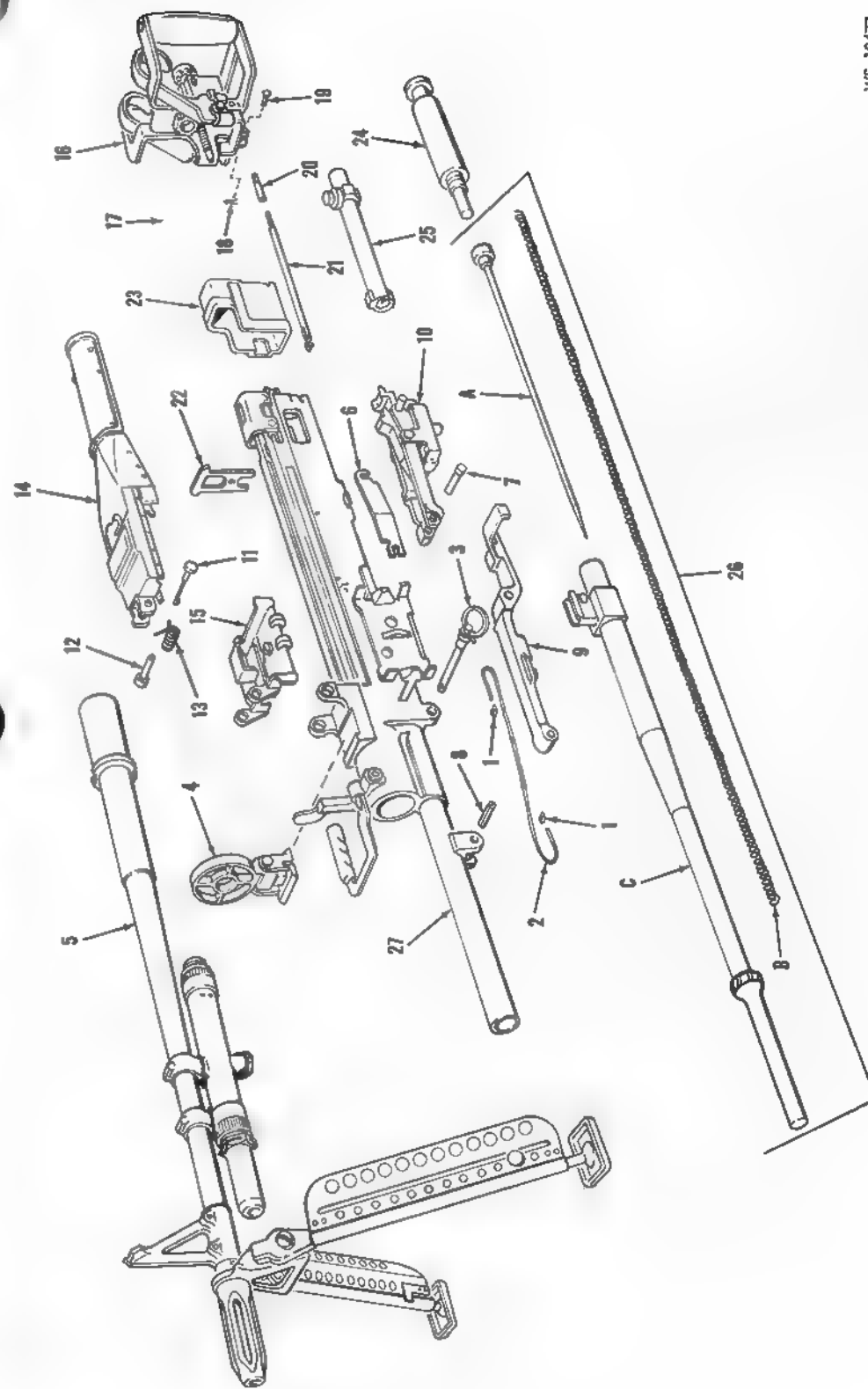

WE 10477

Figure 3-5. Machine gun XM60D—partially exploded view.

- 1—Sleeve
- 2—Cable
- 3—Pin
- 4—Sight assembly rear
- 5—Barrel assembly w/bipod assembly
- 6—Spring
- 7—Pin
- 8—Pin
- 9—Adapter
- 10—Housing assembly
- 11—Pin
- 12—Latch
- 13—Spring
- 14—Cover assembly
- 15—Tray assembly
- 16—Grip and trigger assembly
- 17—Wire
- 18—Pin
- 19—Pin
- 20—Nut
- 21—Link and spring
- 22—Yoke
- 23—Boot
- 24—Buffer assembly
- 25—Bolt assembly
- 26—Rod assembly group
- A—Guide assembly
- B—Spring
- C—Rod assembly
- 27—Receiver group

- (5) Examine all other hardware items for damage and replace if unserviceable.

3-13. Buffer Assembly

a. *Disassembly and/or Assembly.* No disassembly is authorized.

b. *Cleaning, Inspection, and Repair.*

- (1) Examine buffer assembly for leaks. Replace if unserviceable.
- (2) If yoke (22, fig. 3-5) is distorted and damaged beyond repair, replace.

3-14. Operating Rod Assembly

a. *Disassembly and/or Assembly.* No disassembly is authorized.

b. *Cleaning, Inspection, and Repair.*

- (1) Refer to TM 9-1005-224-12.
- (2) If inspection reveals damage beyond organizational repairman, replace assemblies.

3-15. Breech Bolt Assembly

a. *Disassembly and/or Assembly.* Refer to TM 9-1005-224-12.

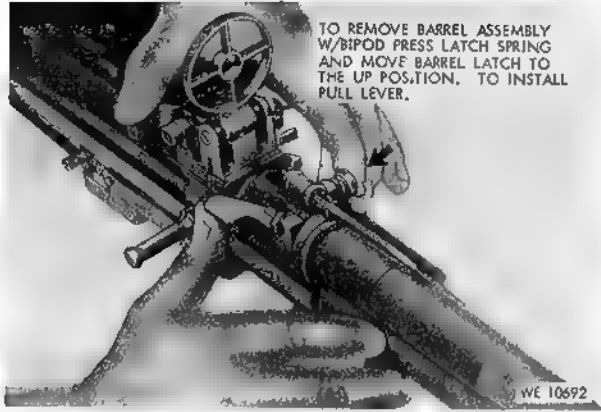

Figure 3-6. Removing or installing barrel assembly w/bipod assembly.

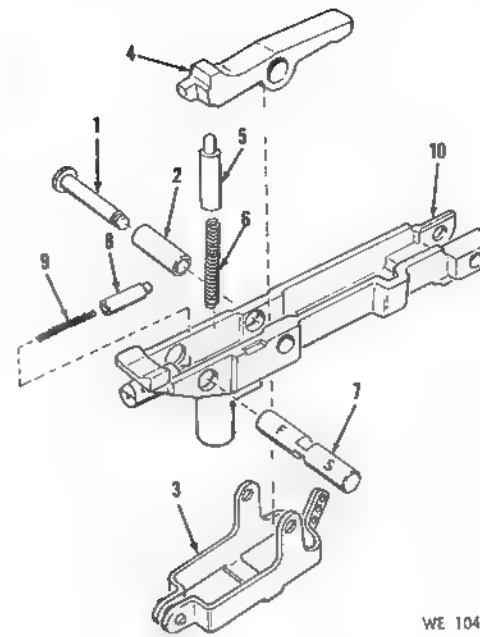

Figure 3-8. Sear and safety housing assembly—exploded view.

- | | |
|-----------|-------------|
| 1—Pin | 6—Activator |
| 2—Bushing | 7—Safety |
| 3—Sear | 8—Plunger |
| 4—Plunger | 9—Spring |
| 5—Spring | 10—Housing |

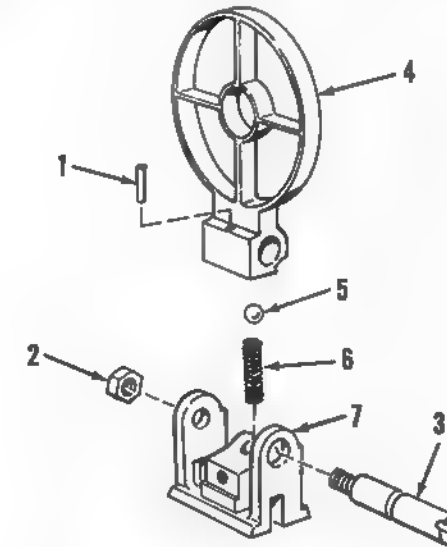

Figure 3-9. Rear Sight Assembly—exploded view.

- | | |
|------------|----------|
| 1—Pin | 4—Sight |
| 2—Locknut | 5—Ball |
| 3—Retainer | 6—Spring |
| | 7—Base |

b. *Cleaning, Inspection, and Repair.*

- (1) Refer to TM 9-1005-224-12.
- (2) If inspection reveals damage beyond repair, replace assembly.

3-16. Tray Assembly

a. *Disassembly and/or Assembly.* No disassembly is authorized.

b. *Cleaning, Inspection, and Repair.*

- (1) Refer to TM 9-1005-224-12.
- (2) If tray assembly is unserviceable, return to direct support for repair or replacement.

3-17. Rear Sight Assembly

a. *Disassembly and/or Assembly.* Refer to figure 3-9.

b. *Cleaning, Inspection, and Repair.*

- (1) Inspect sight assembly for cracks and distortion.
- (2) Examine base for burrs, cracks, and distortion. Remove and replace if unserviceable.
- (3) Examine ball, spring, and retainer for damage. Replace if unserviceable.

c. *Replacement.* Refer to figure 3-10 for replacement of sight.

3-18. Receiver Assembly

a. *Disassembly and/or Assembly.* No disassembly is authorized.

b. *Cleaning, Inspection, and Repair.*

- (1) Inspect for loose rivets.
- (2) Inspect handle assembly and barrel lock lever.
- (3) Inspect magazine bracket assembly for operation.
- (4) Examine receiver assembly for cracks, damage, or worn areas, if unserviceable return machine gun to direct support.

3-19. Adjustment of Sear Link Nut

a. Charge weapon and move safety to SAFE "S" position.

b. Remove free slack between activator and sear.

c. Adjust sear linkage from 1/32 to 3/32 inch "play" from trigger stop to sear.

d. Resistance increase denotes beginning of sear movement against the sear spring.

e. Wire as illustrated in figure 3-11.

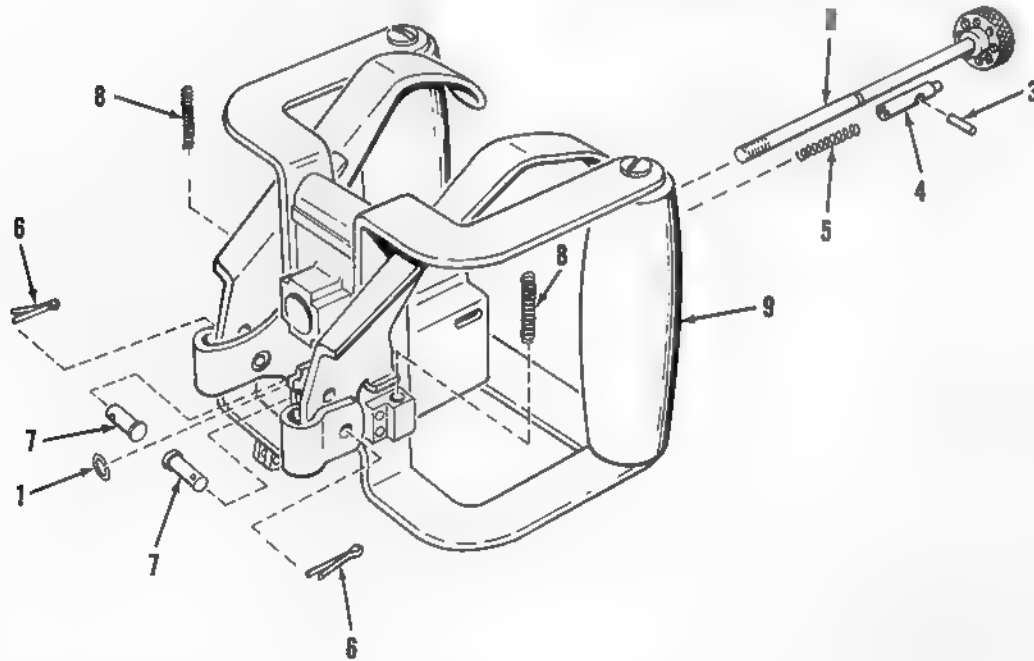

Figure 3-7. Grip and trigger assembly—partially exploded view.

- | | | |
|---------------------|----------|--------------------------|
| 1—Clip | 4—Pin | 7—Pin |
| 2—Retainer assembly | 5—Spring | 8—Spring |
| 3—Pin | 6—Pin | 9—Grip and trigger group |

WE 10493

WE 10494

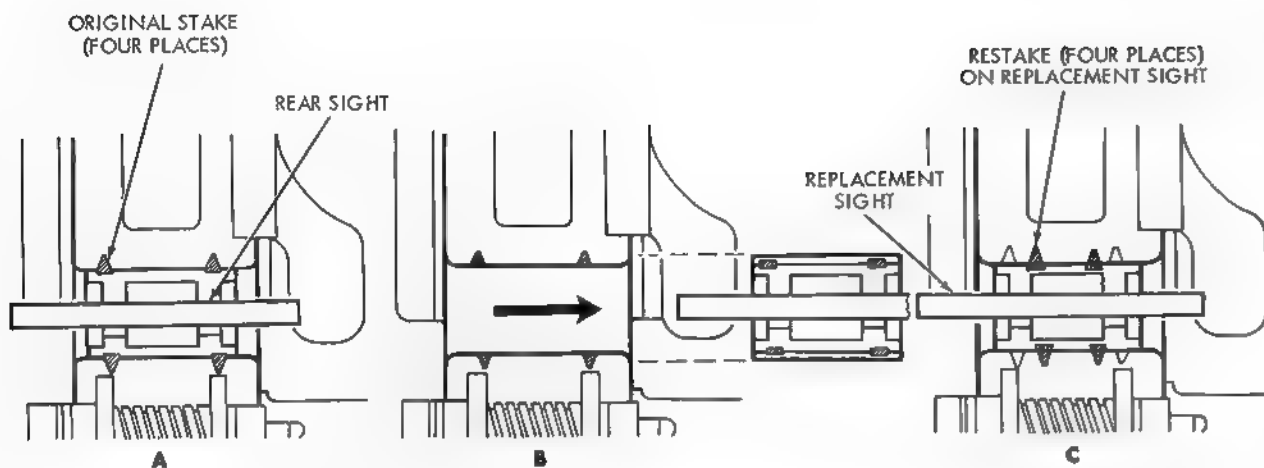

Figure 3-10. Removing or installing rear sight assembly.

WE 10587

Section VI. MOUNT ASSEMBLY XM23 AND EQUIPMENT

3-20. Mount Assembly XM23

a. *Disassembly and/or Assembly.* Refer to figure 3-12.

b. *Cleaning, Inspection, and Repair.*

- (1) Inspect the base and beams for cracks or distortion. Replace beams if unserviceable and if base is unserviceable, return to direct support for repair or replacement.
- (2) Examine pintle for cracks, wear, and distortion. Replace if unserviceable.
- (3) Inspect pivot for cracks and distortion. Steel balls for damaged surfaces. Replace pivot or balls if unserviceable.
- (4) Inspect traversing lock for cracks and spring action. Replace if unserviceable.

3-21. Ammunition Box and Cover Assembly

a. *Disassembly and/or Assembly.* Refer to figure 3-13.

b. *Cleaning, Inspection, and Repair.*

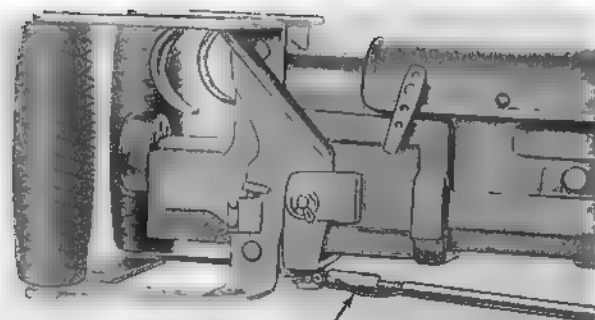

SAFETY WIRE LINK AND SPRING ASSEMBLY AND LINK NUT, AFTER MAKING THE PROPER TRIGGER ADJUSTMENT.

WE 10691

Figure 3-11. Proper method of wiring link nut and link and spring.

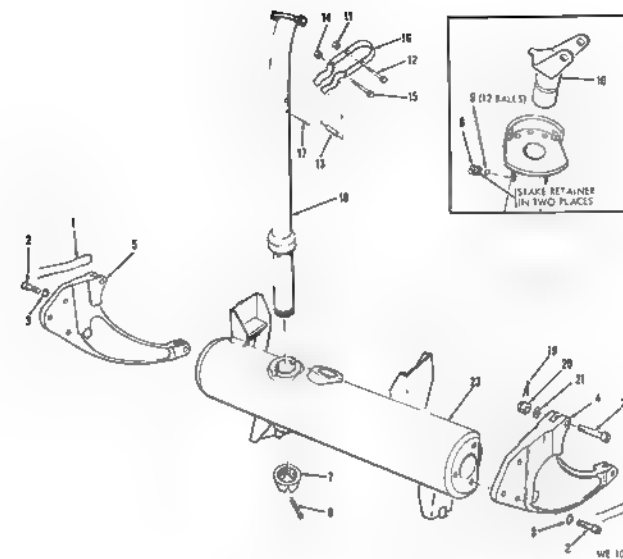

Figure 3-12. Mount assembly XM23—partially exploded view.

- | | | |
|----------|------------|-----------|
| 1—Wire | 8—Retainer | 16—Lock |
| 2—Screw | 9—Ball | 17—Pin |
| 3—Washer | 10—Pivot | 18—Pintle |
| 4—Beam | 11—Nut | 19—Nut |
| 5—Beam | 12—Screw | 20—Washer |
| 6—Pin | 13—Spacer | 21—Bolt |
| 7—Nut | 14—Nut | 22—Bore |
| | 15—Bolt | |

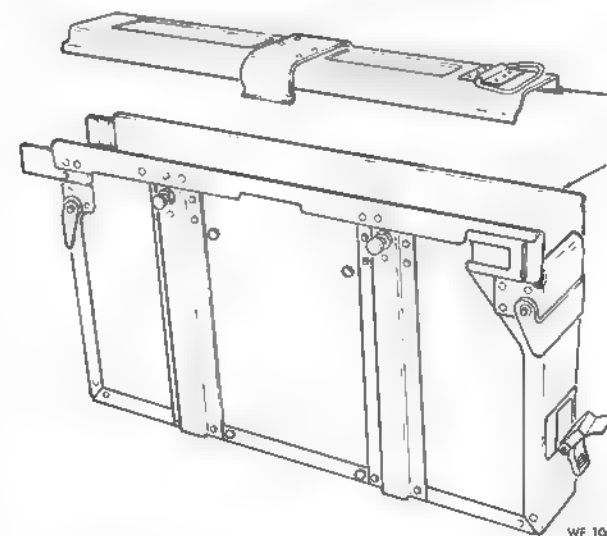

Figure 3-13. Ammunition box and cover assembly—partially exploded view.

- 1—Cover assembly 2—Ammunition box

- (1) Inspect cover assembly for cracks and distortion. Replace if unserviceable.
- (2) Inspect ammunition box for cracks, distortion, and continued service. Return ammunition box and cover assembly to direct support if unserviceable.

3-22. Ammunition Box Chute Assembly

a. *Disassembly and/or Assembly.* Refer to figures 3-18 and 3-14.

b. *Cleaning, Inspection, and Repair.*

- (1) Examine chute for kinks and distortion. Replace link or links if unserviceable.
- (2) Examine adapter (fig. 1-5) for cracks and distortion. Replace if unserviceable.

3-23. Ejection Control Bag

a. *Disassembly and/or Assembly.* Refer to figure 3-16.

b. *Cleaning, Inspection, and Repair.*

- (1) Examine bag for tears, broken zippers, and mildew. Replace if unserviceable.

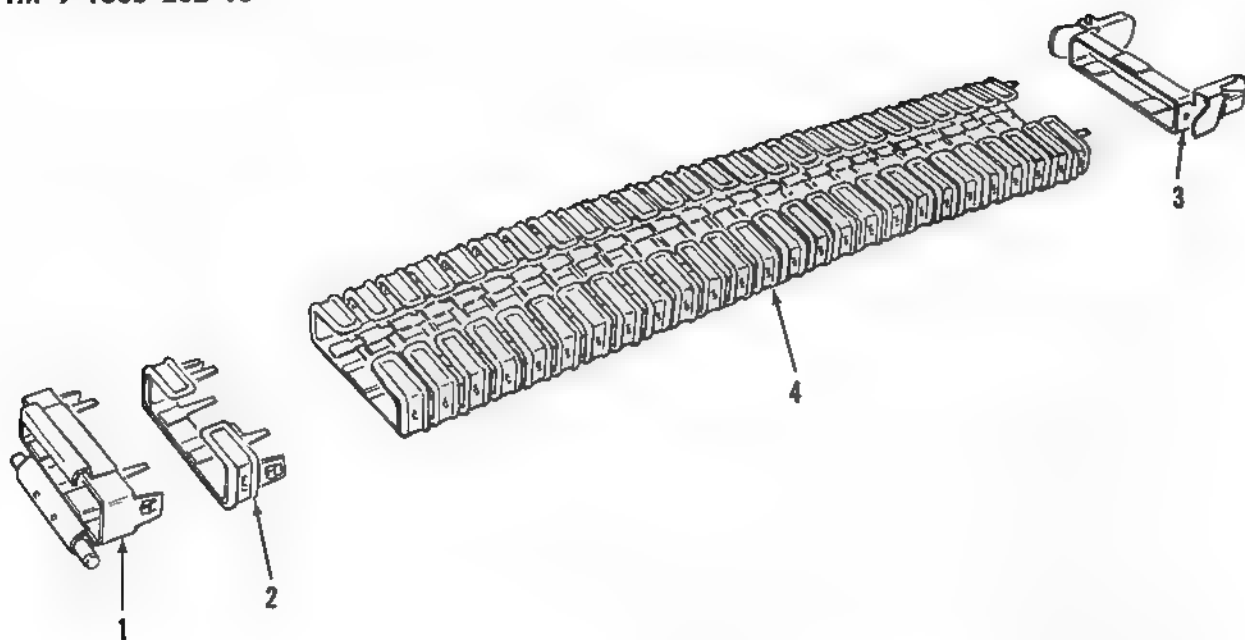

WE 10624

Figure 3-14. Ammunition box and cover assembly—continued—partially exploded view.

- 1—Fitting
- 2—Link

- 3—Fitting
- 4—Ammunition chute

- (2) Examine frame for cracks and distortion. Check front and rear dovetails for alignment and scoring. If frame is unserviceable, return to direct support for repair or replacement.

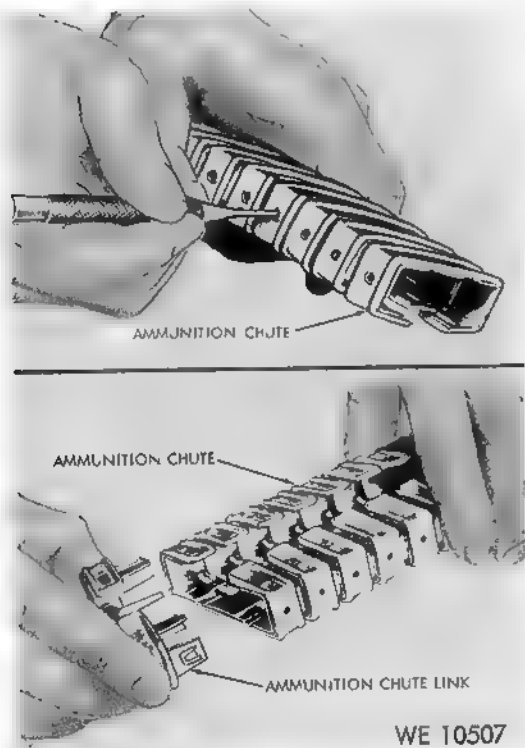

WE 10507

Figure 3-15. Removing or installing ammunition link.

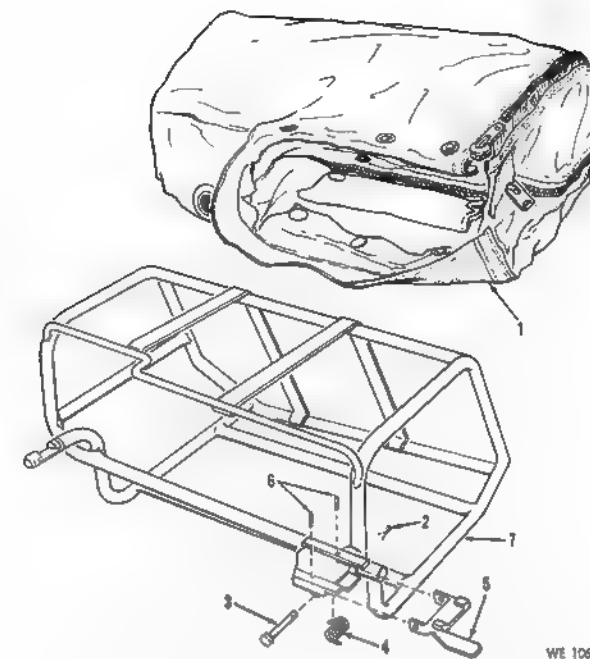

WE 10697

Figure 3-16. Ejection control bag—partially exploded view.

- 1—Bag
- 2—Pin
- 3—Pin
- 4—Spring

- 5—Latch
- 6—Pin
- 7—Frame

Section VII. MOUNT ASSEMBLY XM24 AND EQUIPMENT

3-24. Mount Assembly XM24

a. *Disassembly and/or Assembly.* Refer to figure 3-17.

b. *Cleaning, Inspection, and Repair.*

- (1) Inspect welding assemblies for cracks and distortion. If welding assemblies are unserviceable, return to direct support for repair or replacement.
- (2) Inspect pivot for cracks and distortion, steel balls for damaged surfaces. Replace pivot or steel balls if unserviceable.
- (3) Examine pin for proper operation and distortion, cable for breaks and complete protective cover, and cord as-

sembly for weak elastic in the rubber. Replace if unserviceable.

3-25. Ammunition Can Assembly

a. *Disassembly and/or Assembly.* Refer to figure 3-18.

b. *Cleaning, Inspection, and Repair.*

- (1) Examine plunger for cracks and distortion. Replace if unserviceable.
- (2) Inspect spring for proper tension and kinked loops. Replace if unserviceable.
- (3) Examine ammunition can assembly for loose rivets and distortion, return to direct support for repair or replacement.

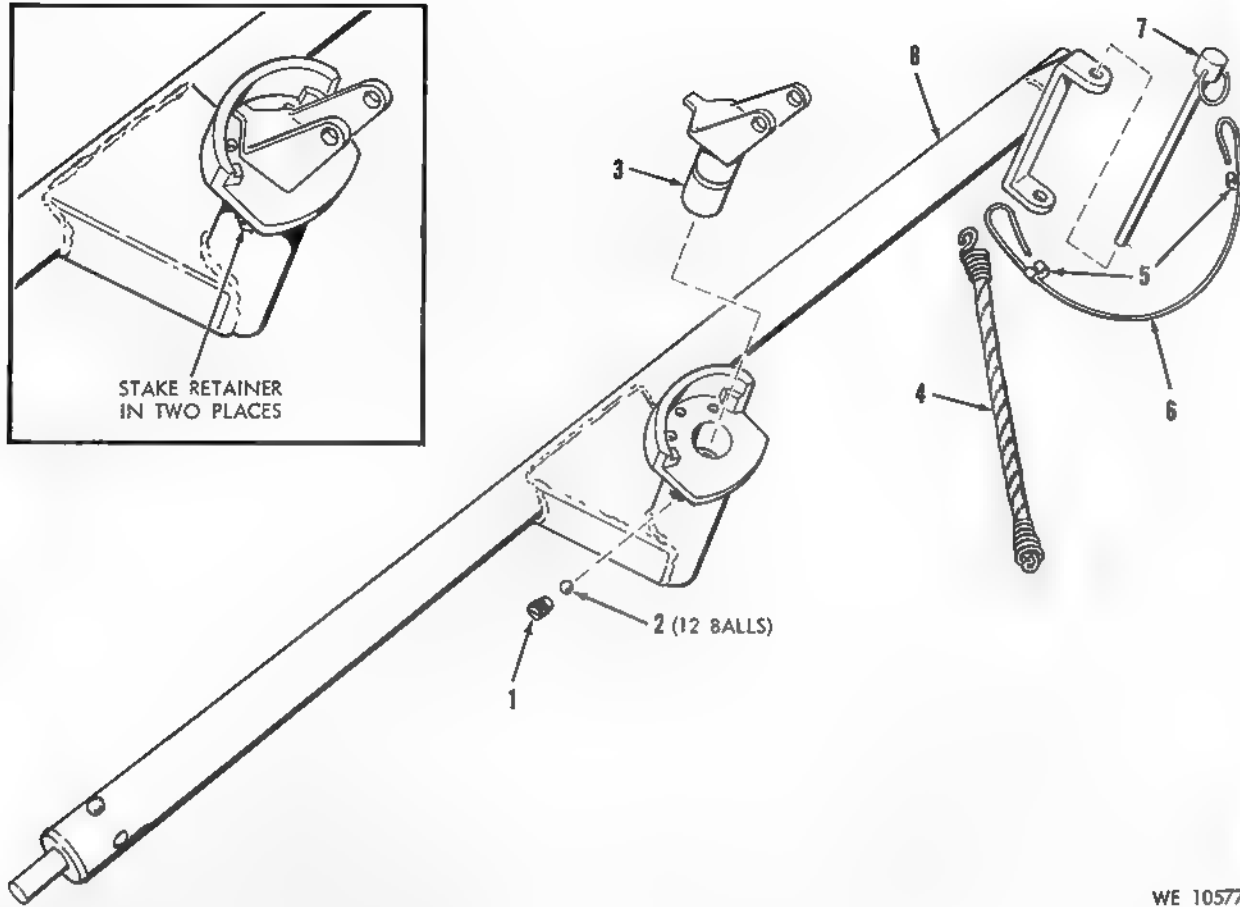

Figure 3-17. Mount assembly XM24—exploded view.

- | | |
|-----------------|---|
| 1—Retainer | 6—Cable |
| 2—Ball | 7—Pin |
| 3—Pivot | 8—Welding assembly right hand (shown)
or
Welding assembly left hand |
| 4—Cord assembly | |
| 5—Sleeve | |

WE 10577

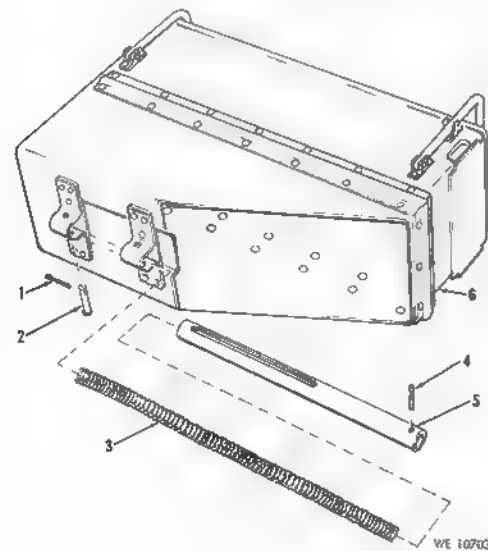

Figure 3-18. Ammunition can assembly—partially exploded view.

- | | |
|----------|----------------------|
| 1—Pin | 4—Rivet |
| 2—Pin | 5—Plunger |
| 3—Spring | 6—Can assembly group |

WE 10703

CHAPTER 4

DIRECT AND GENERAL SUPPORT AND DEPOT MAINTENANCE INSTRUCTIONS

Section I. MACHINE GUN XM60D AND EQUIPMENT

4-1. Function Firing

Refer to TM 9-1005-224-34.

detailed instructions.

b. *Cleaning, Inspection, and Repair.*

(1) Refer to TM 9-1005-224-12.

(2) Inspect for worn, cracked or damaged parts. Unserviceable parts, except the receiver assembly will be replaced.

4-2. Machine Gun XM60D

a. *Disassembly and/or Assembly.* Refer to figures 3-5, 4-1, and TM 9-1005-224-12 for

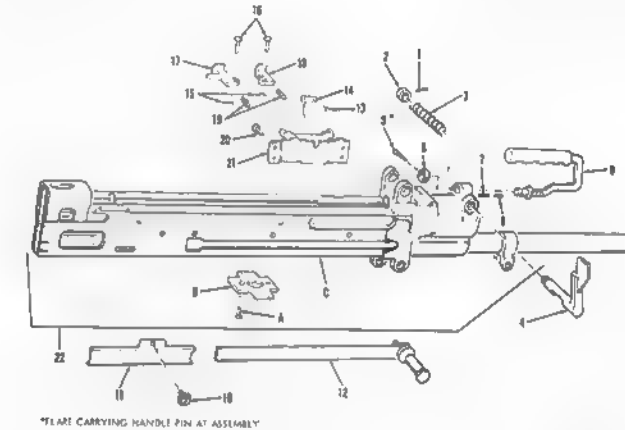

Figure 4-1. Machine gun XM60D—partially exploded view.

- | | |
|--------------------|----------------------|
| 1—Pin | 14—Spring |
| 2—Ring | 15—Pin |
| 3—Spring | 16—Pin |
| 4—Lever | 17—Latch |
| 5—Pin | 18—Latch |
| 6—Ring | 19—Spring |
| 7—Spring | 20—Rivet |
| 8—Plunger | 21—Bracket assembly |
| 9—Handle assembly | 22—Receiver assembly |
| 10—Screw | A—Rivet |
| 11—Guide | B—Plate |
| 12—Handle assembly | C—Receiver |
| 13—Rivet | |

4-3. Barrel Assembly with Bipod Assembly

a. *Disassembly and/or Assembly.* Refer to figure 3-5 and TM 9-1005-224-34.

b. *Cleaning, Inspection, and Repair.* Refer to

TM 9-1005-224-34.

4-4. Grip and Trigger Assembly

a. *Disassembly and/or Assembly.* Refer to figure 3-7 and paragraph 3-11.

b. *Cleaning, Inspection, and Repair.* Refer to paragraph 3-11.

4-5. Sear and Safety Housing Assembly

a. *Disassembly and/or Assembly.* Refer to figure 3-8 and paragraph 3-12.

b. *Cleaning, Inspection, and Repair.* Refer to paragraph 3-12.

4-6. Buffer Assembly

a. *Disassembly and/or Assembly.* No disassembly authorized.

b. *Cleaning, Inspection, and Repair.* Refer to paragraph 3-13.

4-7. Operating Rod Assembly

a. *Disassembly and/or Assembly.* Refer to TM 9-1005-224-34.

b. *Cleaning, Inspection, and Repair.* Refer to paragraph 3-14 and TM 9-1005-224-12.

4-8. Breech Bolt Assembly

a. *Disassembly and/or Assembly.* Refer to TM 9-1005-224-12.

b. *Cleaning, Inspection, and Repair.* Refer to TM 9-1005-224-12.

Section II. MOUNT ASSEMBLY XM23 AND EQUIPMENT

4-13. Mount Assembly XM23

a. *Disassembly and/or Assembly.* Refer to figure 3-12.

b. *Cleaning, Inspection, and Repair.* Refer to paragraph 3-20.

4-14. Ammunition Box and Cover Assembly

a. *Disassembly and/or Assembly.* Refer to figures 3-18 and 3-14.

b. *Cleaning, Inspection, and Repair.* Refer to paragraph 3-21.

Section III. MOUNT ASSEMBLY XM24 AND EQUIPMENT

4-17. Mount Assembly XM24

a. *Disassembly and/or Assembly.* Refer to figure 3-17.

b. *Cleaning, Inspection, and Repair.* Refer to paragraph 3-24.

4-9. Cover Assembly

a. *Disassembly and/or Assembly.* Refer to TM 9-1005-224-34.

b. *Cleaning, Inspection, and Repair.* Refer to TM 9-1005-224-34.

4-10. Tray Assembly

a. *Disassembly and/or Assembly.* Refer to TM 9-1005-224-34.

b. *Cleaning, Inspection, and Repair.* Refer to TM 9-1005-224-34.

4-11. Rear Sight Assembly

a. *Disassembly and/or Assembly.* Refer to figure 3-9 and paragraph 3-17.

b. *Cleaning, Inspection, and Repair.* Refer to paragraph 3-7.

c. *Replacement.* Refer to figure 3-10.

4-12. Receiver Assembly

a. *Disassembly and/or Assembly.* Refer to TM 9-1005-224-34.

b. *Cleaning, Inspection, and Repair.* If receiver assembly (22, fig. 4-1) is unserviceable, the gun will be turned in for replacement.

4-15. Ammunition Box Chute Assembly

a. *Disassembly and/or Assembly.* Refer to figures 3-13 and 3-14.

b. *Cleaning, Inspection, and Repair.* Refer to paragraph 3-22.

4-16. Ejection Control Bag

a. *Disassembly and/or Assembly.* Refer to figure 3-16.

b. *Cleaning, Inspection, and Repair.* Refer to paragraph 3-23.

4-18. Ammunition Can Assembly

a. *Disassembly and/or Assembly.* Refer to figure 3-18.

b. *Cleaning, Inspection, and Repair.* Refer to paragraph 3-25.

4-19. Combination Screwdriver and Reamer Wrench

a. *Disassembly and/or Assembly.* Refer to figure 4-2 and TM 9-1005-224-34.

b. *Cleaning, Inspection, and Repair.* Refer to TM 9-1005-224-34.

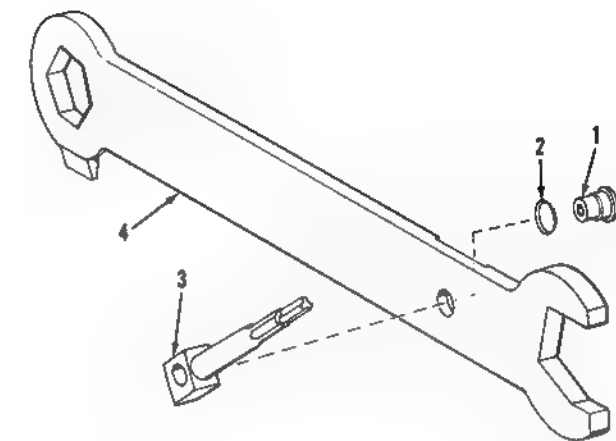

Figure 4-2. Combination screwdriver and reamer wrench—exploded view.

1—Pin	3—Reamer
2—Washer	4—Wrench

CHAPTER 5 AMMUNITION

5-1. Authorized Rounds

Ammunition authorized for use in the 7.62-millimeter machine gun XM60D is listed below and in figure 5-1.

Cartridge, 7.62-millimeter: AP, NATO, M61

Cartridge, 7.62-millimeter: ball, NATO, M59

Cartridge, 7.62-millimeter: ball, NATO, M80

Cartridge, 7.62-millimeter Dummy: NATO, M63

Cartridge, 7.62-millimeter: tracer, NATO, M62



Figure 5-1. Authorized rounds.

CHAPTER 6 FINAL INSPECTION

6-1. Procedures

Refer to TM 9-1005-224-34.

CHAPTER 7 REPAIR STANDARDS

7-1. Location of Standards

Refer to TM 9-1005-224-34.

CHAPTER 8 OVERHAUL INSTRUCTIONS

8-1. Procedures

Overhaul procedures are similar to those pertaining to direct and general support maintenance which are contained in Chapter 4 and TM 9-1005-224-34. Repair parts are listed in

Appendix I. For further details on overhaul, contact Commanding General, Headquarters, U. S. Army Weapons Command, ATTN: AMSWE-SMM-SA, Rock Island Arsenal, Rock Island, Illinois 61202.

APPENDIX I

BASIC ISSUE ITEMS, ORGANIZATIONAL, DIRECT AND GENERAL SUPPORT, AND DEPOT MAINTENANCE REPAIR PARTS AND SPECIAL TOOL LISTS

Section I. PREFACE

1. Explanation of Columns

a. Source, Maintenance, and Recoverability Code.

(1) *Source.* Source codes used in this list are:

Code	Explanation
P	Requisition from the depot system of the responsible commodity command (applies to high mortality parts).
P1	Requisition from the depot system of the responsible commodity command (applies to low mortality parts).
X1	Requisition next higher assembly or component.

(2) *Maintenance level.* Maintenance level codes used in this list are:

Code	Explanation
O	Organizational maintenance
F	Direct support maintenance
H	General support maintenance
D	Depot maintenance

(3) *Recoverability.* Recoverability codes used in this list are:

Code	Explanation
R	Items which are economically repairable at direct and general support maintenance activities and are normally furnished by supply on an exchange basis.
T	High dollar value recoverable repair parts which are subject to special handling and are issued on an exchange basis. Such recoverable parts are normally repaired or overhauled at depot maintenance activities.

When no code is indicated, the item will be considered expendable.

b. Description. The Federal item name is shown in capital letters.

c. Unit of Issue. The quantity to be requisitioned.

a. Quantity Incorporated in Unit. Indicates the number of times the listed item is used in the functional group.

e. Organizational 15-Day Maintenance Allowance per Equipment Density Spread.

(1) The quantitative allowances represent one prescribed load for a 15-day period. They must be on hand or on requisition at all times. The appropriate subcolumn is determined as follows:

(a) Select the subcolumn heading which includes the number of subsystems being supported, i.e., if supporting 12 subsystems, subcolumn headed 7-20 would be used.

(b) For machine gun repair parts, the number of subsystems being supported shall be multiplied by number of guns per subsystem, i.e., if supporting 12 subsystems, which have two guns each, multiply the 12 (number of subsystems) by 2, obtaining 24. The quantitative allowance will be listed in subcolumn headed 21-50.

(2) Major commanders will determine the number of prescribed loads organizational maintenance units will carry. Units and organizations authorized additional prescribed loads will multiply quantities obtained in (1) above by the number of prescribed loads and use appropriate subcolumn.

f. Direct and General Support 15-Day Maintenance Allowances.

(1) *Maintenance per 100 equipments.* This column indicates repair part allowance factors for direct and general support maintenance. These factors represent the estimated average quantities required to provide maintenance and, where applicable, supply support for 100 equipments for a 15-day period under combat conditions. The exact quantity authorized must be computed as instructed in (2) below.

(2) *Computation of authorized quantities.* To compute the exact quantities authorized using the allowance factors, multiply the number of equipments supported by the allowance factor. Then divide by 100.

Example: If the number of equipments supported is 30
and the allowance factor
for 100 equipment is . . . × 1.9

270
30
570

The resulting product is . . . 570
Divide this by 100 (this may be accomplished by moving the decimal point two places toward the left thus: .570 or 0.570).

When the resulting fractional value is 0.5 or larger, it will be rounded off to the next higher whole number.

Example: If 1.77 is obtained, a quantity of 2 is authorized. When the resulting fractional value is below 0.5, it will be rounded to the next lower whole number.

Example: If 3.4 is obtained, a quantity of 3 is authorized.

g. Depot Maintenance Guide per 100 Equipments.

(1) This column indicates repair part allowance factors for depot maintenance. These factors represent recommended quantities required to overhaul 100 components or end items of equipment.

(2) The exact quantity authorized must be computed as instructed in *f*(2) above.

h. Allowance Symbols. When an allowance factor is inclosed in parenthesis, the item is designated as a "combat essential item of a critical nature" and must be stocked at all times, regardless of demand. Additional repair parts are indicated by an asterisk (*). These items are to be requisitioned as required.

i. Where no quantity is shown, reference should be made to the first appearance of the item as indicated in the description column.

Note. The 15-day level is not applicable to special tools for direct support and depot maintenance.

j. Illustration. Contains the figure number and key number (or letter) of the illustration of the listed item.

Section II. BASIC ISSUE ITEMS--Continued

(1) Source, Maintenance, and Recoverability Code			(2) Federal Stock Number	(3) Description	(4) Unit of Issue	(5) Quantity Authorized	(6) Illustration	
(a) Source	(b) Maintenance Level	(c) Recover- ability					(a) Figure Number	(b) Item Number
				MOUNT ASSEMBLY, LEFT HAND (49937) AND RIGHT HAND (49936) (Armament subsystem XM23.)				
			1005-973-2474	ADAPTER, AMMUNITION CHUTE STRAIGHT: (7792472).....	2	2	1-5	
			1005-903-1094	AMMUNITION BOX AND COVER ASSEMBLY: (51267)	1	2	1-5	
			1005-903-1088	BAG, EJECTION CONTROL: (49931).....	1	2	1-5	
			7510-763-5996	CHUTE ASSEMBLY FLEXIBLE (7792347-4) (Initial issue only).....	1	2	1-5	
			1005-994-9647	ENVELOPE, TRANSPARENT: (81348-E-43183).....	1	1	AI-4	
				PLUG, END LINK: (7791595).....	1	10	AI-4	
				MOUNT ASSEMBLY, LEFT SIDE (50599) AND RIGHT SIDE (50600) (Armament subsystem XM24.)				
			1005-903-1088	BAG, EJECTION CONTROL: (49931).....	1	2	1-7	
			1005-903-1090	CAN ASSEMBLY, AMMUNITION: (50617).....	1	2	1-7	
			7510-763-5996	ENVELOPE, TRANSPARENT: (81348-E-43183).....	1	1	AI-4	
			1005-994-9647	PLUG, END LINK: (7791595).....	1	10	AI-4	
				Material Issued By Other Commodity Commands				
				Additional copies, when required, will be requisitioned from the Adjutant Generals office.				
				DA Form 2408-3 Equipment Maintenance Record (Organizational).....		1		
				DA Form 2408-4 Weapon Record Data.....		1		
				DA Form 2408-5 Equipment Modification Record.....		1		
				DA Form 2408-6 Equipment Maintenance Record (Support Echelons).....		1		
				DA Form 2408-7 Equipment Transfer Report.....		1		
				DA Form 2408-8 Equipment Acceptance and Registration Record.....		1		
				MANUAL, technical, TM 9-1005-262-15.....		1		
				MISCELLANEOUS MATERIEL FOR:				
				The items listed below are not issued as components of the major combination. They are to be requisitioned and issued in accordance with TA, TOE, or as otherwise specified				
				AMMUNITION				
				Ammunition for use with this weapon is listed in SM 9-5-1305 For training allowances of ammunition other than dummy cartridge, see TA 23-100				
				ARTICLES FOR INSTRUCTIONAL PURPOSES				
				The following item WILL BE TAKEN into the field upon permanent change of station and into the theater of operation				
			1305-542-1272	DUMMY CARTRIDGE, 7 62 MILLIMETER: (7553706) (See TA 23-103 for allowances.)				

Section III. ORGANIZATIONAL REPAIR PARTS AND SPECIAL TOOLS

(1) Source, Maintenance and Recoverability Code	(2) Federal Stock Number	(3) Description	(4) Unit of Issue	(5) Quantity Incorporated in Unit	(6) 15 Days Maintenance Allowance Per Equipment Density Spread				(7) Illustration
					A	B	C	D	
		None authorized							
		REPAIR PARTS FOR:							
		ARMAMENT SUBSYSTEM, HELICOPTER, 7.62-MILLIMETER MACHINE GUN: XM123 and XM24, w/c							
		MACHINE GUN, 7.62 MILLIMETER: XM60D, flexible (49929)							
		Quantity incorporated in unit indicates quantity per one XM60D machine gun.							
P1	1005-909-3014	ACTUATOR, SEAR ASSEMBLY: (49824)	1	2	*	*	*	3-8	5
P1	1005-608-5037	ACTUATOR ASSEMBLY, CAM: (7269063)	2	1	(1)	(1)	(1)	AI-9	3
P1	1005-909-3011	ADAPTER, GUN: (49819)	1	2	*	*	*	3-5	9
P	3110-142-0145	BALL, BEARING (96906-19059-8)	10	1	*	*	*	3-9	5
P1	1005-608-5001	BARREL ASSEMBLY WITH BIPOD ASSEMBLY: (7269027)	1	1	*	*	*	3-5	5
P1	1005-909-3022	BASE, REAR SIGHT: (49874)	2	2	*	*	*	3-6	7
P1	1005-608-5039	BEARING, FIRING PIN: (7269065)	5	1	(1)	(1)	(1)	AI-9	5
P1	1005-763-1863	BOLT ASSEMBLY, BREECH: (11010357)	1	1	(1)	(1)	(1)	3-5	25
P1	1005-909-3016	BOOT, DUST AND MOISTURE SEAL: (49827)	1	2	*	*	*	3-5	23
P1	1005-908-4141	BUFFER ASSEMBLY: (11010518)	1	1	(1)	(1)	(1)	3-5	24
P1	1005-909-3005	BUSHING, SEAR: (49805)	2	2	*	*	*	3-8	2
P1	1005-912-1147	CAM ASSEMBLY (11686319)	1	1	*	*	*	AI-11	1
P	5340-909-3033	CLIP, RETAINING SCREW: (49814)	2	1	*	*	*	3-7	1
P1	1005-608-5119	CLIP, SPRING LEVER: (7269146)	2	1	*	*	*	AI-11	1
P	1005-872-4442	EJECTOR, CARTRIDGE: (11010375)	2	1	(1)	(1)	(1)	AI-9	2A
		COMPONENTS OF MAJOR COMBINATIONS							

P1	1005-608-5004	EXTENSION, GAS CYLINDER: (7269030)	1	1	*	*	*	AI-7	8
P1	1005-779-6030	EXTRACTOR, BOLT ASSEMBLY (7790907)	2	1	(1)	(1)	(1)	AI-9	10
P1	1005-909-3024	GRIP AND TRIGGER ASSEMBLY: (49926)	1	2	*	*	*	3-5	16
P	1005-608-5172	GUIDE ASSEMBLY, DRIVING SPRING: (7269199)	2	1	(1)	(1)	(1)	3-5	26A
P1	1005-608-5089	GUIDE, CARTRIDGE, FRONT: (7269116)	5	1	*	*	*	AI-11	5
P1	1005-608-5090	GUIDE, CARTRIDGE, REAR: (7269117)	1	1	*	*	*	AI-11	6
P1	1005-909-3013	HOUSING, SEAR: (49822)	1	2	*	*	*	3-8	10
P1	1005-608-5214	LATCH, HINGE PIN: (7269243)	2	1	(1)	(1)	(1)	3-5	12
P1	1005-608-5118	LEVER, FEED: (7269145)	2	1	*	*	*	AI-11	2B
P1	1005-909-3023	LINK AND SPRING, SEAR ASSEMBLY: (49875)	1	2	*	*	*	3-5	21
P	5310-208-4026	LOCKNUT: (96906-20500-1032)	1	2	*	*	*	3-9	2
P1	1005-608-5005	NUT, GAS CYLINDER: (7269031)	1	1	*	*	*	AI-7	5
P1	1005-909-3003	NUT, SEAR LINK: (49803)	2	2	*	*	*	3-5	20
P1	1005-608-5093	PAWL ASSEMBLY, FEED: (7269120)	2	1	*	*	*	AI-11	7
P1	1005-909-3007	PIN, DOUBLE TRIGGER: (49808)	2	2	*	*	*	3-7	7
P	5310-282-1225	PIN, COTTER: (96906-24665-150)	1	2	*	*	*	3-5	18
P1	5340-913-5486	PIN (96906-17990-C-519)	1	2	*	*	*	3-5	3
P	5315-200-2213	PIN, SPRING: (96906-9048-100)	1	2	*	*	*	3-7	3
P	1005-872-4443	PIN, FIRING: (11010376)	2	1	(1)	(1)	(1)	AI-9	6
P1	1005-608-5218	PIN, HINGE COVER: (7269247)	2	2	*	*	*	3-5	11
P	1005-909-3006	PIN, LINK, SEAR: (49806)	2	2	*	*	*	3-5	19
P	1005-994-9648	PIN, LOCK: (7792920)	2	2	(1)	(1)	(1)	AI-9	1
P	1005-909-3026	PIN, LOCKING: (50256)	2	2	*	*	*	3-7	4
P1	1005-909-3004	PIN, SEAR: (49804)	2	2	*	*	*	3-8	1
P	5315-839-0901	PIN, SPRING: (96906-39066-81)	1	1	(1)	(1)	(1)	AI-9	7
P	5315-720-6492	PIN, SPRING: (96906-9047-069)	1	2	(1)	(1)	(1)	3-9	1
P	1005-872-4445	PLUG ASSEMBLY, BOLT: (7791523)	2	1	(1)	(1)	(1)	AI-9	2
P1	1005-987-9907	PLUG, GAS CYLINDER: (7792093)	3	1	(1)	(1)	(1)	AI-7	9
P1	1005-608-5057	PLUNGER, EXTRACTOR: (7269063)	2	1	(1)	(1)	(1)	AI-9	11
P1	1005-909-3009	PLUNGER, SAFETY: (49811)	2	2	*	*	*	3-8	8
P1	1005-608-5180	PLUNGER, SEAR: (7269207)	2	2	*	*	*	3-8	4
P1	1005-903-1037	RETAINER ASSEMBLY, SCREW: (50258)	1	1	*	*	*	3-7	2
P1	1005-909-4179	RETAINER, REAR SIGHT: (49829)	1	1	*	*	*	3-9	3
P	1005-069-9359	ROD ASSEMBLY, OPERATING: (7791597)	1	1	(1)	(1)	(1)	3-5	26C
P1	1005-909-3008	SAFETY, SMALL ARMS: (49810)	1	2	*	*	*	3-8	7
P1	1005-608-5182	SEAR: (7269209)	1	1	(1)	(1)	(1)	3-8	3
P1	1005-909-3018	SIGHT, REAR: (49832)	1	2	*	*	*	3-7	2
P1	5340-952-4705	SPRING (96906-24585-75)	1	2	*	*	*	3-9	3
P	1005-909-3025	SPRING, HELICAL, COMPRESSION: (50255)	2	2	*	*	*	3-7	6
P	1005-909-3017	SPRING, HELICAL, COMPRESSION: (49828)	2	2	*	*	*	3-9	5
P1	1005-608-5060	SPRING, HELICAL, COMPRESSION: (7269086)	4	1	(1)	(1)	(1)	3-8	9
P	1005-608-5059	SPRING, HELICAL, COMPRESSION: (7269085)	4	1	(1)	(1)	(1)	AI-9	12
P1	1005-608-5184	SPRING, HELICAL, COMPRESSION: (7269211)	1	2	*	*	*	3-8	9
P1	1005-608-5061	SPRING, HELICAL, COMPRESSION: (7269087)	4	1	(1)	(1)	(1)	AI-9	5
P	1005-608-5271	SPRING, HELICAL, COMPRESSION: (7269303)	4	1	(1)	(1)	(1)	3-5	26B

Section III. ORGANIZATIONAL REPAIR PARTS AND SPECIAL TOOLS—Continued

(1) Source, Maintenance and Recoverability Code		(2) Federal Stock Number	(3) Description	(4) Unit of Issue	(5) Quantity Incorporated in Unit	(6) 16 Days Maintenance Allowance Per Equipment Density Spread				(7) Illustration	
Source	Maintenance Level					Recoverability	A	B	C	D	Number
P1	O	1005-909-3021	SPRING, LOCK, RETAINING PIN: (49860)	2	2	*	*	*	*	3-5	6
P1	O	1005-987-9682	TRAY ASSEMBLY, CARTRIDGE: (7792096)	2	1	*	*	*	*	3-5	15
P	O	1005-608-5009	WASHER, KEY: (7269035)	4	2	(1)	(1)	(1)	(1)	AI-7	6
P1	O	9505-603-4116	WIRE, STEEL, CORROSION RESISTING: (96906-20995-C20)	lb	†	*	*	*	*	3-5	17
P1	O	9505-293-4208	WIRE, STEEL, CORROSION RESISTING: (96906-20995-C32)	lb	†	*	*	*	*	3-12	1
P1	O	1005-909-3020	YOKE, BUFFER RETAINING: (49859)	1	2	*	*	*	*	AI-7	4
			MOUNT ASSEMBLY, LEFT HAND (49937) AND RIGHT HAND (49936) (Armament subsystem XM23.)								
P	O	3110-990-4372	BALL, STEEL (96906-19059-86)	10	24	*	*	*	*	3-12	9
P1	O	1005-903-1036	BEAM, MOUNTING: (50149)	1	2	*	*	*	*	3-12	4
P1	O	1005-903-1034	BEAM, MOUNTING: (49869)	1	2	*	*	*	*	3-12	5
P	O	5306-151-0528	BOLT: (88044-24-26)	100	4	*	*	*	*	3-12	22
P1	O	1005-903-1042	LOCK, TRANSVERSING: (50615)	1	2	*	*	*	*	3-12	16
P1	O	5310-208-4026	NUT: (96906-20500-1032)	1	2	*	*	*	*	3-12	11
P1	O	5310-877-5796	NUT: (96906-21044-N4)	1	2	*	*	*	*	3-12	14
P1	O	5310-167-1280	NUT: (88044-310-C4)	1	8	*	*	*	*	3-12	20
P1	O	1005-903-1035	NUT, PLAIN, ROUND: (49942)	1	2	*	*	*	*	3-12	7
P	O	5315-234-1854	PIN, COTTER: (96906-24665-153)	1	8	*	*	*	*	3-12	19
P	O	5315-234-1864	PIN, COTTER: (96906-24665-302)	1	8	*	*	*	*	3-12	6
P1	O	1005-903-1041	PIN, POST: (50613)	1	2	*	*	*	*	3-12	18
P1	O	1005-903-1228	PIVOT, PIN, (51165)	1	2	*	*	*	*	3-12	10
P1	O	1005-909-3010	RETAINER, BALL BEARING: (49815)	1	2	*	*	*	*	3-12	8
P1	O	5305-050-9217	SCREW (96906-24678-48)	1	12	*	*	*	*	3-12	2
P1	O	1005-903-1043	SPACER, SLEEVE: (50616)	2	2	*	*	*	*	3-12	13
P1	O	1005-912-3698	TUBE ASSEMBLY, BASE: (50628)	1	2	*	*	*	*	3-12	23
P	O	5310-080-6004	WASHER, FLAT: (96906-27183-14)	1	12	*	*	*	*	3-12	3
P	O	5310-141-1795	WASHER, FLAT: (88044-980-416)	1	8	*	*	*	*	2-18	3-12

P1	O	9505-293-4208	WIRE, STEEL, CORROSION RESISTING: (96906-20995-C32)	lb	†	*	*	*	*	3-12	1
			MOUNT ASSEMBLY, LEFT SIDE (50599) AND RIGHT SIDE (50600) (Armament subsystem XM24.)								
P	O	3110-990-4372	BALL, STEEL: (96906-19059-86)	10	24	*	*	*	*	3-17	2
P	O	1005-909-3031	CORD ASSEMBLY, SHOCK: (50598-1)	2	2	(1)	(1)	(1)	(1)	3-17	4
P1	O	5340-909-3034	PIN, QUICK RELEASE: (50601)	1	2	*	*	*	*	3-17	7
P1	O	1005-909-3019	PIVOT, PIN, (49843)	1	2	*	*	*	*	3-17	3
P1	O	1005-909-3010	RETAINER, BALL BEARING: (49815)	1	2	*	*	*	*	3-17	1
			CAN ASSEMBLY, AMMUNITION: (50617) (Armament subsystem XM24)								
P1	O	5315-815-1405	PIN, COTTER: (96906-24665-151)	2	2	*	*	*	*	3-18	1
P1	O	5315-087-8226	PIN, STRAIGHT, HEADLESS (96906-20392-2C-21)	2	1	*	*	*	*	3-18	2
P1	O	1005-903-1091	PLUNGER, HOLDING: (50622)	2	2	*	*	*	*	3-18	5
P1	O	1005-903-1092	SPRING, HELICAL, COMPRESSION: (50623)	2	2	*	*	*	*	3-18	3
			ROD, CLEANING SMALL ARMS: MI (6508237)								
P	O	1005-601-7660	SWAB HOLDER SECTION, SMALL ARMS CLEANING ROD: (6017660)	20	1	*	*	*	*	AI-1	IC
			AMMUNITION BOX AND COVER ASSEMBLY: (51267) (Armament subsystem XM23)								
P1	O	1005-903-1093	COVER ASSEMBLY, AMMUNITION: (51170)	1	2	*	*	*	*	3-13	1
P	O	1005-972-8127	FITTING, BOX END: (7792344)	1	2	*	*	*	*	3-14	3
P	O	1005-972-8128	FITTING, GUN END: (7792345)	1	2	*	*	*	*	3-14	1
P	O	1005-972-8126	LINK, AMMUNITION CHUTE: (7792343)	10	88	(1)	(2)	(3)	(4)	3-14	2
			BAG, EJECTION CONTROL: (49931) (Armament Subsystems XM23 and XM24)								
P1	O	1005-903-1146	BAG, EMPTY CARTRIDGE: (51166)	1	2	*	*	*	*	3-16	1
P1	O	1005-903-1040	LATCH, SAFETY, REAR BRACKET: (50269)	2	2	*	*	*	*	3-16	5
P1	O	5315-815-1405	PIN, COTTER: (96906-24665-151)	2	2	*	*	*	*	3-16	2
P1	O	1005-903-1038	PIN, REAR BRACKET: (50264)	2	2	*	*	*	*	3-16	3
P1	O	1005-903-1039	SPRING, HELICAL, TORSION: (50267)	2	1	*	*	*	*	3-16	4

Section III. ORGANIZATIONAL REPAIR PARTS AND SPECIAL TOOLS—Continued

(1) Source, Maintenance and Recoverability Code	(2) Federal Stock Number	(3) Description	(4) Unit of Issue	(5) Quantity Incorporated in Unit	(6) 15 Days Maintenance Allowances Per Equipment Density Spread				(7) Illustration Number
					A	B	C	D	
		TOOLS AND EQUIPMENT FOR UNIT REPLACEMENT							
		ARMAMENT SUBSYSTEM, HELICOPTER, 7.62-MILLIMETER MACHINE GUN: XM23 and XM24, w/c							
		MACHINE GUN, 7.62-MILLIMETER: XM60D, flexible (49929)							
		The items listed below are authorized for replenishment of basic issue equipment. The allowances shown below are for two machine guns.							
	1005-558-4174	BRUSH, CLEANING, SMALL ARMS: (5584174).....	10		1	1	2	3	AI-1
	1005-690-3115	BRUSH, CLEANING, SMALL ARMS: (790452).....	10		1	1	2	3	AI-1
	1005-650-4508	BRUSH, CLEANING, SMALL ARMS: (790342).....	10		1	1	1	2	AI-1
	1005-791-5420	CASE, CARRYING, BARREL, ASSEMBLY AND EQUIPMENT: (771008)	1		(1)	(1)	(1)	(1)	AI-3
	1680-516-8427	HARNESSE ASSEMBLY: (AF51J3817).....	1		*	*	*	*	*
	9150-889-3522	LUBRICATING OIL, SEMI-FLUID: (7791358).....	5		1	2	2	4	AI-1
	1005-691-1639	MAGAZINE ASSEMBLY, AMMUNITION (790572).....	1		(1)	(1)	(1)	(1)	AI-6
	8145-266-8843	MITTEN, CLOTH: (37-M-394).....	2		1	1	1	1	AI-5
	1005-650-8237	ROD, CLEANING, SMALL ARMS: (6508237).....	1		1	1	1	1	AI-1
	1005-680-3766	WRENCH, SCREWDRIVER AND REAMER, COMBINATION: (7790680).	1		1	1	1	1	AI-2
		MOUNT ASSEMBLY, LEFT HAND (49937) AND RIGHT HAND (49936) (Armament subsystem XM23.)							

1005-973-2474	ADAPTER, AMMUNITION CHUTE STRAIGHT: (7792472).	2		*	*	*	*	*	3-14
1005-903-1094	AMMUNITION BOX AND COVER ASSEMBLY: (51267).	1		*	*	*	*	*	1-5
1005-903-1088	BAG, EJECTION CONTROL: (49931).....	1		*	*	*	*	*	1-5
7510-763-5996	ENVELOPE, TRANSPARENT: (81348-E-43183).....	1		1	1	1	1	1	AI-4
1005-994-9647	PLUG, END-LINK: (7791595).....	1		(2)	(4)	(4)	(10)	(10)	AI-4
	MOUNT ASSEMBLY, LEFT SIDE (50599) AND RIGHT SIDE (50600) (Armament subsystem XM24.)								
1005-903-1088	BAG, EJECTION, CONTROL: (49931).....	1		*	*	*	*	*	1-7
1005-903-1090	CAN ASSEMBLY, AMMUNITION: (50617).....	1		1	1	1	1	1	1-7
7510-763-5996	ENVELOPE, TRANSPARENT: (81348-E-43183).....	1		1	1	1	1	1	AI-4
1005-994-9647	PLUG, END LINK: (7791595).....	1		(2)	(4)	(4)	(10)	(10)	AI-4
	SPECIAL TOOLS FOR ORGANIZATIONAL MAINTENANCE FOR:								
	The 15-day level does not apply to special tools for organizational maintenance. The following tools are authorized one (1) each to each aircraft armament repairman MOS 427 supporting the subsystems XM23 and XM24.								
	MACHINE GUN, 7.62-MILLIMETER: XM60D, flexible (49929)								
1005-722-5087	BRUSH, CLEANING, SMALL ARMS: (7225087).....								AI-2
4933-652-9950	EXTRACTOR, RUPTURED CARTRIDGE CASE: (7790352)								AI-2
1005-790-3600	STAFF, CLEANING, 20-MILLIMETER: (7790518).....								AI-2
1005-680-3766	WRENCH, SCREWDRIVER AND REAMER, COMBINATION: (7790680)								AI-2
	MOUNT ASSEMBLY, LEFT HAND (49937) AND RIGHT HAND (49936) (Armament subsystem XM23.) None authorized.								
	MOUNT ASSEMBLY, LEFT SIDE (50599) AND RIGHT SIDE (50600) (Armament subsystem XM24.) None authorized.								

Section III. ORGANIZATIONAL REPAIR PARTS AND SPECIAL TOOLS—Continued

(1) Source, Maintenance and Recoverability Code	(2) Federal Stock Number			(3) Description	(4) Unit of Issue	(5) Quantity Incorporated	(6) 15 Days Maintenance Allowance Per Equipment Density Spread				(7) Illustration		
	Source	Maintenance Level	Recoverability				A	B	C	D	Figure Number	Item Number	
				<p>COMMON MAINTENANCE TOOLS</p> <p>The sets listed below are authorized in accordance with TOE</p> <p>TOOL SET, AIRCRAFT ARMAMENT REPAIRMAN: MOS 427, basic (FSN 4933-987-9816) (Listed in SM 9-4-4933-A15)</p> <p>MAINTENANCE MATERIALS</p> <p>The following items are requisitioned as required For usage see TM 9-247, TM 9-213, and TM 9-208-1.</p> <p>BRUSH, ARTISTS: (81348-H-B-241).</p> <p>BRUSH, ARTISTS: (08288-8020-1)</p> <p>CLEANING COMPOUND, SOLVENT: (81348-ORD-PD-126)</p> <p>2 oz can</p> <p>6 oz can</p> <p>1 qt can</p> <p>1 gal can</p> <p>CLOTH, ABRASIVE: (P-C-458)</p> <p>DRY CLEANING SOLVENT: (81348-P-S-661)</p> <p>1 gal can</p> <p>LUBRICATING OIL, GENERAL PURPOSE: (81349-L-644)</p> <p>4 oz can</p> <p>1 qt can</p> <p>LUBRICATING OIL, SEMIFLUID: (81349-L-46000)</p> <p>1 qt can</p> <p>LUBRICATING OIL, WEAPONS: (81349-L-14107)</p> <p>1 qt can</p> <p>RAG, WIPING: (96906-16746-131).</p> <p>SWAB, SMALL ARMS CLEANING:</p> <p>20 ea in wp env (export pack) (2-P-600-40).</p> <p>200 ea in bnd1 (2-P-600-80) (5019316)</p> <p>THINNER, PAINT, MINERAL SPIRITS: (81348-TT-T-291)</p> <p>1 gal can</p>									
			8020-244-0153										
			8020-597-2645										
			6850-682-6835										
			6850-224-6657										
			6850-224-6658										
			6850 224-6663										
			5350 192-5052										
			6850-281-1985										
			9150-273-2389										
			9150-231-6689										
			9150-687-4241										
			9150-292-9689										
			7920-205-1711										
			1005-288-2868										
			1005-288-3565										
			8010-242-2089										

Section IV. DIRECT AND GENERAL SUPPORT AND DEPOT REPAIR PARTS AND SPECIAL TOOLS

(1) Source, Maintenance and Recoverability Code	(2) Federal Stock Number		(3) Description	(4) Unit of Issue	(5) Quantity Incorporated	(6) 15-Day Maintenance Allowance Per 100 Equipments		(7) Depot Maintenance Guide Per 100 Equipments	(8) Illustration		
	Source	Maintenance Level				Recoverability	(a) Direct Support		(b) Heavy Support	(a) Figure Number	(b) Item Number
			<p>None authorized</p> <p>REPAIR PARTS FOR:</p> <p>ARMAMENT SUBSYSTEM, HELICOPTER, 7.62-MILLIMETER MACHINE GUN: XM23 and XM24, w/c</p> <p>MACHINE GUN, 7.62-MILLIMETER: XM60D, flexible (49929)</p> <p>Quantity incorporated in unit indicates quantity per one XM60D machine gun</p> <p>ACTIVATOR, SEAR ASSEMBLY: (49824).....</p> <p>ACTUATOR ASSEMBLY, CAM: (7269063).....</p> <p>ADAPTER, GUN: (49819).....</p> <p>BALL BEARING (96906 19059-8).....</p> <p>BARREL ASSEMBLY WITH BIPOD ASSEMBLY (7269027).....</p> <p>BASE, REAR SIGHT: (49874).....</p> <p>BEARING, FIRING PIN: (7269065).....</p> <p>BOLT ASSEMBLY, BREECH: (11010357).....</p> <p>BOLT, BREECH: (11010358).....</p> <p>BOOT, DUST AND MOISTURE SEAL: (49827).....</p> <p>BRACKET ASSEMBLY, MAGAZINE: (7790550).....</p> <p>BUFFER ASSEMBLY: (11010518).....</p> <p>BUMPER ASSEMBLY, CAM: (7269126).....</p> <p>BUSHING, SEAR: (49805).....</p>								
P1	O		1005-909-3014	1	2	(0.2)	(0.1)	2	3-8	6	
P1	O		1005-608-5037	2	1	(0.2)	(0.1)	10	AI-9	3	
P1	O		1005-909-3011	1	2	(0.4)	(0.1)	5	3-5	9	
P	O		3110-142-0145	10	1	1.0	0.3	15	3-9	5	
P1	O		1005-608-5001	1	1	(0.8)	(0.2)	3-5	5	
									3-6		
P1	O		1005-909-3022	2	2	(0.4)	(0.1)	4	3-9	7	
P1	O		1005-608-5039	5	1	(0.2)	(0.1)	6	AI-9	5	
P1	O	R	1005-763-1863	1	1	(6.2)	(2.1)	3-5	25	
P1	D		1005-872-4441	1	1	50	AI-9	13	
P1	O		1005-909-3016	1	2	(0.8)	(0.2)	8	3-5	23	
P1	H		1005-690-3501	1	1	5	4-1	21	
P1	O		1005-908-4141	1	1	(0.5)	(0.2)	8	3-5	24	
P1	D		1005-608-5099	1	1	10	AI-11	8F	
P1	O		1005-909-3005	2	2	(0.8)	(0.2)	8	3-8	2	

Section IV. DIRECT AND GENERAL SUPPORT AND DEPOT REPAIR PARTS AND SPECIAL TOOLS—Continued

(1) Source, Maintenance and Recoverability Code			(2) Federal Stock Number	(3) Description	(4) Unit of Issue	(5) Quantity Incorporated	(6) 15-Day Maintenance Allowance Per 100 Equipments		(7) Depot Maintenance Guide Per 100 Equipments	(8) Illustration	
(a) Source	(b) Maintenance Level	(c) Recoverability					(a) Direct Support	(b) Heavy Support		(a) Figure Number	(b) Item Number
REPAIR PARTS FOR—Continued:											
MACHINE GUN, 7.62-MILLIMETER: XM60D, flexible (49929)—continued:											
P1	F		1005-909-3030	CABLE, PIN, SAFETY: (50597-2)	1	1	0.8	0.2	15	3-5	1
P1	O		1005-912-1147	CAM ASSEMBLY (11686319)	1	1	(0.4)	(0.1)	5	AI-11	1
X1	O			CHANNEL ASSEMBLY (11010268)	1	1				AI-11	1D
P	O		5340-909-3033	CLIP, RETAINING SCREW: (49814)	2	2	(1.7)	(0.6)	20	3-7	1
X1	O			CHASSIS ASSEMBLY, CARRIER: (7269149)	1	1				AI-11	7D
P1	O		1005-608-5119	CLIP, SPRING LEVER: (7269146)	2	2	(0.8)	(0.2)	10	AI-11	2A
X1	O			COVER ASSEMBLY (7269114)	1	1				3-5	14
P	O		1005-872-4442	EJECTOR, CARTRIDGE: (11010375)	2	2	(6.2)	(2.1)	50	AI-9	8
P1	O		1005-608-5004	EXTENSION, GAS CYLINDER: (7269030)	1	1	(0.2)	(0.1)	5	AI-7	8
P1	O		1005-779-6030	EXTRACTOR, BOLT ASSEMBLY (7790907)	2	2	(0.8)	(0.2)	100	AI-9	10
X1	O			FOOT ASSEMBLY, LEFT HAND (7269055)	1	1				AI-8	8C
X1	O			FOOT ASSEMBLY, RIGHT HAND (7269061)	1	1				AI-8	7C
X1	O			FRAME ASSEMBLY (7269128)	1	1				AI-11	8N
P1	O		1005-909-3024	FRAME ASSEMBLY, CARTRIDGE TRAY (7792097)	1	2	(0.5)	(0.2)	6	3-5	16
P	O		1005-608-5172	GRIP AND TRIGGER ASSEMBLY: (49926)	2	1	(13.8)	(1.2)	40	3-5	26A
P1	O		1005-608-5089	GUIDE ASSEMBLY, DRIVING SPRING: (7269190)	5	1	(0.8)	(0.2)	12	AI-11	5
P1	O		1005-608-5090	GUIDE, CARTRIDGE, FRONT: (7269116)	1	1	(0.8)	(0.2)	12	AI 11	6
P1	F		1005-603-9285	GUIDE, CARTRIDGE, REAR: (7269117)	5	1	(0.2)	(0.1)	4	4-1	11
X1	O			GUIDE, COCKING HANDLE: (11010155)	1	1				4-1	12
P1	F		1005-608-5203	HANDLE ASSEMBLY (7791621)	5	1	(0.6)	(0.2)	10	4-1	9
P1	O		1005-909-3013	HOUSING, SEAR: (49822)	1	2	(0.4)	(0.1)	5	3-8	10
X1	O			HOUSING ASSEMBLY, CARTRIDGE: (7269231)	1	1				AI-8	7D
X1	O			HOUSING ASSEMBLY, FOOT LEFT HAND (7269056)	1	1				AI-8	8D
P1	F		1005-608-5091	HOUSING ASSEMBLY, FOOT RIGHT HAND (7269062)	1	1	(0.4)	(0.1)	15	AI-11	8

X1				KEY (7269057)	1	1				AI-8	7B
P1	F		1005-608-5109	LATCH, COVER: (7269136)	2	1	(0.4)	(0.1)	5	AI-8	8B
P1	O		1005-608-5214	LATCH, HINGE PIN: (7269243)	2	1	(0.8)	(0.2)	12	AI-11	8C
P1	F		1005-690-3504	LATCH, MAGAZINE: (7790553)	1	1	(0.4)	(0.1)	8	3-5	12
P1	F		1005-690-3505	LATCH, MAGAZINE RELEASE: (7790554)	1	1	(0.4)	(0.1)	8	4-1	18
P1	D		1005-608-5021	LEG ASSEMBLY: (7269046)	1	1			5	AI-8	17
X1	O			LEVER ASSEMBLY (7269119)	1	1				AI-8	8
P1	F		1005-608-5110	LEVER ASSEMBLY, LATCH: (7269137)	1	1	(0.4)	(0.1)	8	AI-11	2
P1	O		1005-608-5118	LEVER, FEED: (7269145)	2	1	(0.4)	(0.1)	6	AI-11	8B
P1	O		1005-909-3023	LINK AND SPRING, SEAR ASSEMBLY: (49875)	1	2	(0.8)	(0.2)	10	AI 11	2B
P1	F		1005-918-2608	LOCK (11010184)	2	1	(0.1)	(0.1)	2	3-5	21
P	O		5310-208-4026	LOCKNUT: (96906-20500-1032)	1	2	1.7	0.6	22	3-9	4
P1	O		1005-608-5005	NUT, GAS CYLINDER: (7269031)	1	1	(0.2)	(0.1)	10	AI-7	5
P1	O		1005-909-3003	NUT, SEAR LINK: (49803)	2	2	(0.8)	(0.2)	10	3 5	20
P1	D		1005-608-5111	PAD ASSEMBLY, CHEEK: (7269138)	1	1			10	AI-11	8H
P1	O		1005-608-5093	PAWL ASSEMBLY, FEED: (7269120)	2	1	(0.4)	(0.1)	10	AI-11	7
P1	F		1005-608-5299	PAWL, CARTRIDGE RETAINER (7269332)	2	2	(0.8)	(0.2)	10	AI-12	3
P1	O		1005-909-3007	PIN, DOUBLE TRIGGER: (49808)	2	2	(0.8)	(0.2)	10	3-7	7
P	O		5310-282-1225	PIN, COTTER (96906-24665-150)	1	2	1.7	0.6	15	3 5	18
X1	O		5340-913-5486	PIN, FEED (7269150)	1	3				AI-11	7B
P1	F		1005-209-6241	PIN, RETAINING, GUIDE SHAFT: (11010181)	100	3	(2.0)	(0.7)	300	3-5	3
P1	F		1005-608-5022	PIN, RETAINER, SPRING: (7269048)	4	2	(0.2)	(0.1)	8	AI-8	2
P	O		5315-200-2213	PIN, SPRING: (96906-9048-100)	1	2	1.7	0.6	15	3 7	3
P	O		1005-872-4443	PIN, FIRING: (11010376)	2	1	(6.2)	(2.1)	100	AI-9	6
P1	O		1005-608-5218	PIN, HINGE COVER: (7269247)	2	2	(0.8)	(0.2)	6	3-5	11
P1	F		1005-066-6062	PIN, LATCH RETAINING: (7792069)	1	2	(0.8)	(0.2)	6	4-1	16
P	O		1005-909-3006	PIN, LINK, SEAR: (49806)	2	2	(1.0)	(0.3)	15	3-5	19
P	O		1005-994-9648	PIN, LOCK: (7792920)	2	1	(1.7)	(0.6)	50	AI-9	1
P	O		1005-909-3026	PIN, LOCKING: (50256)	2	2	(1.0)	(0.3)	14	3-7	4
P1	O		1005-909-3004	PIN, SEAR: (49804)	2	2	(0.8)	(0.2)	8	3-8	1
P1	D		5315-608-5116	PIN, SHOULDER, HEADED: (7269143)	100	2	(1.3)	(0.4)	200	AI 11	8K
P	F		5315-812-4658	PIN, SPRING: (96906-39086-141)	1	1	(6.2)	(2.1)	100	AI-7	1
P	O		5315-839-0901	PIN, SPRING (96906-39086-81)	1	1			100	AI-9	7
P	O			PIN, SPRING: (96906-9047-069)	1	2	(1.0)	(0.3)	14	4-1	1
P1	F		1005-608-5217	PIN, STRAIGHT, HEADLESS: (7269246)	4	1	(0.6)	(0.2)	100	4-1	5
P1	F		5315-812-9526	PIN, STRAIGHT, HEADLESS: (7790941)	1	1	(0.4)	(0.1)	8	AI-10	1
P1	F		5315-878-8615	PIN, STRAIGHT, HEADLESS: (7791270)	10	1	(0.4)	(0.1)	12	AI 11	8A
P1	F		1005-875-4350	PISTON, GAS: (7791247)	1	1	(0.4)	(0.1)	10	AI-7	7
P1	F		1005-020-8684	PIVOT, BIPOD ASSEMBLY: (7793010)	1	1	(0.4)	(0.1)	10	AI-8	6
P1	F		1005-083-0291	PLATE, MOUNTING: (7792974)	1	1	(0.5)	(0.2)	5	4-1	6
P	O		1005-872-4445	PLUG ASSEMBLY, BOLT: (7791523)	2	1	(6.2)	(2.1)	100	AI 9	2
P1	O		1005-987-9907	PLUG, GAS CYLINDER: (7792093)	3	1	(0.4)	(0.1)	70	AI-7	9
P1	F		1005-608-5221	PLUNGER, CARRYING HANDLE: (7269250)	4	1	(0.4)	(0.1)	4	AI-8	5

Section IV. DIRECT AND GENERAL SUPPORT AND DEPOT REPAIR PARTS AND SPECIAL TOOLS—Continued

(1) Source, Maintenance and Recoverability Code		(2) Federal Stock Number	(3) Description	(4) Unit of Issue	(5) Quantity Incorporated	(6) 15-Day Maintenance Allowance Per 100 Equipments		(7) Depot Maintenance Guide Per 100 Equipments	(8) Illustration	
(a) Source	(b) Maintenance Level					(c) Recoverability	(a) Direct Support		(b) Heavy Support	(a) Figure Number
REPAIR PARTS FOR—Continued:										
MACHINE GUN, 7.62-MILLIMETER: XM60D, flexible (49929)—continued:										
P1	O	1005-608-5057	PLUNGER, EXTRACTOR: (7269083)	2	1	(0.8)	(0.2)	20	AI-9	11
P1	F	1005-608-5096	PLUNGER, RETAINER: (7269123)	2	1	(0.1)	(0.1)	10	AI-11	1B
P1	O	1005-909-3009	PLUNGER, SAFETY: (49811)	2	2	(0.8)	(0.2)	8	3-8	8
P1	O	1005-608-5180	PLUNGER, SEAR: (7269207)	2	2	(0.8)	(0.2)	10	3-8	4
P1	F	1005-608-5024	PLUNGER, SPRING: (7269050)	2	2	(0.2)	(0.1)	6	4-1	8
X1			RECEIVER ASSEMBLY (7269251)		1				AI-8	5
P1	O	1005-908-1037	RETAINER ASSEMBLY, SCREW: (50258)	1	1	(0.4)	(0.1)	5	4-1	22
P1	F	1005-608-5208	RETAINER, COCKING HANDLE: (7269237)	4	1	(0.2)	(0.1)	8	AI-13	2
P1	F	1005-608-5097	RETAINER, FEED CAM: (7269124)	2	1	(0.1)	(0.1)	6	AI-11	1A
P1	O	1005-909-4179	RETAINER, REAR SIGHT: (49829)	1	2	1.0	0.3	6	3-9	3
P1	F	1005-608-5027	RETAINER, SPRING: (7269053)	2	2	(0.2)	(0.1)	6	AI-8	3
P1	F	1005-918-2609	RING (11010377)	2	1	(0.1)	(0.1)	2	4-1	2
P1	F	1005-608-5235	RING, HANDLE, RETAINING: (7269267)	5	1	(0.6)	(0.2)	5	4-1	6
P1	H	1005-600-3507	RIVET, MAGAZINE BRACKET: (7790556)	2	2			8	4-1	13
P	H	1005-075-7225	RIVET, MAGAZINE BRACKET ASSEMBLY: (7792086)	100	4		(0.4)	60	4-1	20
P1	F	1005-083-0290	RIVET, RECEIVER ASSEMBLY: (7792972)	100	1	(0.1)	(0.1)	20	4-1	22A
P1	D	5320-608-5032	RIVET, SOLID: (7269058)	100	4			400	AI-8	7A
P1	D	5320-608-5112	RIVET, SOLID: (7269139)	100	2			200	AI-8	8A
P1	D	5320-608-5085	RIVET, SOLID: (7269112)	100	9			100	AI-11	8E
P	O	1005-069-9359	ROD ASSEMBLY, OPERATING: (7791597)	1	1	(4.3)	(1.5)	50	AI-11	8G
P1	F	1005-608-5300	ROLLER, CARTRIDGE FEED: (7269333)	2	1	(0.1)	(0.1)	8	3-5	26C
P1	F	1005-608-5300	ROLLER, YOKE: (7790942)	1	1	(0.8)	(0.2)	10	AI-10	2
P1	F	1005-909-3008	SAFETY, SMALL ARMS: (49810)	2	2	(0.8)	(0.2)	8	3-8	7
P1	F	1005-608-5025	SCREW: (7269051)	2	1	2.0	0.6	200	AI-8	1
P	F	5305-753-4113	SCREW, ASSEMBLED WASHER: (7790559)	2	1	(1.0)	(0.2)	10	4-1	03
P1	O	1005-608-5182	SEAR: (7269209)	1	1	(0.8)	(0.2)	9	3-8	3
X1			SEAR AND SAFETY HOUSING ASSEMBLY (49925)		1				3-5	10
P1	F	1005-013-7030	SHAFT, CARTRIDGE GUIDE: (11010152)	2	1	(0.1)	(0.1)	6	AI-11	4
P1	F	1005-768-7084	SHAFT, CARTRIDGE PAWL: (7790724)	2	1	(0.1)	(0.1)	6	AI-12	1
P1	F	1005-608-5124	SHAFT, FEED PAWL: (7269151)	2	1	(0.1)	(0.1)	6	AI-11	7A
P1	D	1005-608-5113	SHIELD, COVER: (7269140)	2	1			10	AI-11	8J
P1	O	1005-909-3018	SIGHT, REAR: (49832)	1	2	(0.8)	(0.2)	5	3-9	4
P1	F	1005-909-3028	SLEEVE, SWAGING: (50596)	2	4	0.8	0.2	15	3-5	1
P1	F	1005-608-5210	SLIDE ASSEMBLY, COCKING HANDLE: (7269239)	1	1	(0.8)	(0.2)	8	AI-13	3
X1			SIGHT ASSEMBLY, REAR (49817)		1				3-5	4
P1	O	5340-952-4705	SPRING (96906-24585-75)	1	2	0.8	0.2	6	3-9	6
P1	F	1005-913-0928	SPRING (11010197)	2	1	(0.2)	(0.1)	5	4-1	3
P	O	1005-909-3025	SPRING, HELICAL, COMPRESSION: (50255)	2	2	(1.0)	(0.3)	14	3-7	5
P1	D	1005-608-5114	SPRING, HELICAL, COMPRESSION: (7269141)	100	2			180	AI-11	8L
P	O	1005-909-3017	SPRING, HELICAL, COMPRESSION: (49828)	2	2	(1.0)	(0.3)	14	3-8	9
P1	F	1005-086-6061	SPRING, HELICAL, COMPRESSION: (7791522)	2	1	(0.4)	(0.1)	5	AI-13	2
P1	F	1005-909-3012	SPRING, HELICAL, COMPRESSION: (49820)	2	4	(0.8)	(0.2)	8	3-7	8
P1	F	1005-608-5026	SPRING, HELICAL, COMPRESSION: (7269052)	4	2	(0.2)	(0.1)	5	AI-8	4
P1	F	1005-608-5098	SPRING, HELICAL, COMPRESSION: (7269125)	2	1	(0.1)	(0.1)	5	AI-11	1C
P1	O	1005-608-5060	SPRING, HELICAL, COMPRESSION: (7269086)	4	1	(0.8)	(0.2)	100	AI-9	9
P	O	1005-608-5059	SPRING, HELICAL, COMPRESSION: (7269085)	4	1	(6.2)	(2.1)	100	AI-9	5
P1	O	1005-608-5184	SPRING, HELICAL, COMPRESSION: (7269211)	1	2	(0.8)	(0.2)	8	3-8	19
P1	F	1005-690-3502	SPRING, HELICAL, COMPRESSION: (7790551)	2	2	(0.8)	(0.2)	8	4-1	4
P1	O	1005-608-5061	SPRING, HELICAL, COMPRESSION: (7269087)	4	1	(0.8)	(0.2)	100	AI-9	4
P1	F	1005-608-5270	SPRING, HELICAL, COMPRESSION: (7269302)	2	1	(0.6)	(0.2)	6	4-1	7
P	O	1005-608-5271	SPRING, HELICAL, COMPRESSION: (7269303)	4	1	(6.2)	(2.1)	100	3-5	26B
P1	F	1005-870-2118	SPRING, HELICAL, TORSION: (7791271)	2	1	(0.4)	(0.1)	8	AI-11	8D
P1	F	1005-608-5302	SPRING, HELICAL, TORSION: (7269335)	2	1	(0.4)	(0.1)	6	AI-12	4
P1	F	1005-608-5302	SPRING, HELICAL, TORSION: (7269152)	2	1	(0.1)	(0.1)	8	AI-11	7C
P1	F	1005-608-5125	SPRING, HELICAL, TORSION: (7269301)	2	1	(0.2)	(0.1)	6	3-5	13
P1	F	1005-608-5269	SPRING, LOCK, RETAINING PIN: (49860)	2	2	(0.8)	(0.2)	10	3-5	6
P1	O	1005-909-3021	SPRING, MAGAZINE SUPPORT: (7790549)	10	1		0.3	6	4-1	14
P1	H	1005-690-3500	SUPPRESSOR, FLASH: (7269034)	2	1	(0.8)	(0.2)	5	AI-7	2
P1	F	1005-608-5008	TRAY ASSEMBLY, CARTRIDGE: (7792096)	2	1	(0.8)	(0.2)	50	3-5	15
P1	O	1005-987-9682	WASHER, CARTRIDGE GUIDE: (7269144)	100	2			10	AI-11	8M
P	O	1005-608-5009	WASHER, KEY: (7269035)	4	2	(1.0)	(0.3)	50	AI-7	6
P1	O	9505-603-4116	WIRE, STEEL, CORROSION RESISTING: (96906-20995-C20)	lb	†	*	*	*	3-5	17
P1	O	9505-293-4208	WIRE, STEEL, CORROSION RESISTING: (96906-20985-C32)	lb	†	*	*	*	3-12	1
P1	O	1005-909-3020	YOKE, BUFFER RETAINING: (49859)	1	2	(0.4)	(0.1)	6	AI-7	4
									3-5	22

Section IV. DIRECT AND GENERAL SUPPORT AND DEPOT REPAIR PARTS AND SPECIAL TOOLS—Continued

(1) Source, Maintenance and Recoverability Code		(2) Federal Stock Number	(3) Description	(4) Unit of Issue	(5) Quantity Incorporated	(6) 15-Day Maintenance Allowance Per 100 Equipments		(7) Depot Maintenance Guide Per 100 Equipments	(8) Illustration	
(a) Source	(b) Maintenance Level					(a) Direct Support	(b) Heavy Support		(a) Figure Number	(b) Item Number
REPAIR PARTS FOR—Continued:										
MOUNT ASSEMBLY, LEFT HAND (49937) AND RIGHT HAND (49936) (Armament subsystem XM23.)										
P	O	3110-990-4372	BALL, STEEL (96906-19059-86)	10	24	(6.2)	(2.1)	50	3-12	9
P1	O	1005-903-1036	BEAM, MOUNTING: (50149)	1	2	(0.8)	(0.2)	10	3-12	4
P1	O	1005-903-1034	BEAM, MOUNTING: (49869)	1	2	(0.8)	(0.2)	10	3-12	5
P	O	5306-151-0528	BOLET: (88044-24-26)	100	4	4.3	1.5	50	3-12	22
P1	O	1005-903-1042	LOCK, TRAVERSING: (50615)	1	2	(0.8)	(0.2)	7	3-12	16
P1	O	5310-208-4020	NUT: (96906-20500-1032)	1	2	0.4	0.1	5	3-12	11
P1	O	5310-877-5796	NUT: (88044-21044-N4)	1	2	0.4	0.1	5	3-12	14
P1	O	1005-903-1035	NUT, PLAIN, ROUND: (49942)	1	2	(0.8)	(0.2)	10	3-12	7
P1	O	5310-167-1280	NUT: (88044-310-C4)	1	8	3.8	1.2	50	3-12	20
P	O	5315-234-1864	PIN, COTTER: (96906-24665-302)	1	8	3.8	1.2	50	3-12	6
P	O	5315-234-1854	PIN, COTTER: (96906-24665-153)	1	8	3.8	1.2	50	3-12	19
P1	O	1005-903-1041	PIN, COTTER: (50613)	1	2	(0.8)	(0.2)	10	3-12	18
P1	O	1005-903-1228	PIVOT, PIN TLE (51165)	1	2	(0.4)	(0.1)	6	3-12	10
P1	O	1005-909-3010	RETAINER, BALL BEARING: (49815)	1	2	(0.8)	(0.2)	5	3-12	8
P1	O	5305-050-9217	SCREW (96906-24678-48)	1	12	1.7	0.6	50	3-12	2
P1	O	1005-903-1043	SPACER, SLEEVE: (50616)	2	2	(0.8)	(0.2)	7	3-12	13
P1	O	1005-912-3698	TUBE ASSEMBLY, BASE: (50628)	1	2	(0.4)	(0.1)	5	3-12	23
P	O	5310-080-6004	WASHER, FLAT: (96906-27183-14)	1	12	1.0	0.3	50	3-12	3
P	O	5310-141-1795	WASHER, FLAT: (88044-960-410)	1	8	3.8	1.2	50	3-12	21
P1	O	9505-203-4208	WIRE, STEEL, CORROSION RESISTING: (96906-20995-C32)	lb	↓	*	*	1	3-12	1
MOUNT ASSEMBLY, LEFT SIDE (50599) AND RIGHT SIDE (50600) (Armament subsystem XM24.)										
P	O	3110-990-4372	BALL, STEEL (96906-19059-86)	10	24	(6.2)	(2.1)	50	3-17	2
P1	F	1005-909-3029	CABLE, PIN, SAFETY: (50597-1)	1	2	0.8	0.2	15	3-17	6
P	O	1005-909-3031	CORD ASSEMBLY, SHOCK: (50598-1)	2	2	(2.0)	(0.7)	200	3-17	4
P1	O	5340-909-3034	PIN, QUICK RELEASE: (50601)	1	2	(0.8)	(0.2)	50	3-17	7
P1	O	1005-909-3019	PIVOT, PIN TLE: (49843)	1	2	(0.4)	(0.1)	6	3-17	3
P1	O	1005-909-3010	RETAINER, BALL BEARING: (49815)	1	2	(0.8)	(0.2)	5	3-17	1
P1	F	1005-909-3028	SLEEVE, SWAGING: (50596)	2	4	0.8	0.2	15	3-17	5
X1			WELDING ASSEMBLY, LEFT HAND (49872)		1				3-17	8
X1			WELDING ASSEMBLY, RIGHT HAND (49871)		1				3-17	8
CAN ASSEMBLY, AMMUNITION: (50617) (Armament subsystem XM24.)										
P1	O	5315-815-1405	PIN, COTTER (96906-24665-151)	2	2	(0.8)	(0.2)	10	3-18	1
P1	O	5315-087-8226	PIN, STRAIGHT HEADLESS (96906-20392-2C-21)	2	1	0.4	0.1	20	3-18	2
P1	O	1005-903-1091	PLUNGER, HOLDING: (50622)	2	2	0.4	0.1	5	3-18	5
P1	O	1005-903-1092	SPRING, HELICAL, COMPRESSION: (50623)	2	2	0.4	0.1	5	3-18	3
ROD, CLEANING, SMALL ARMS: M1 (6598237)										
P	O	1005-601-7660	SWAB HOLDER SECTION, SMALL ARMS CLEANING ROD: (6017660)	20	1	1.5	0.5		AI-1	1C
WRENCH, SCREWDRIVER AND REAMER, COMBINATION: (7790680)										
P1	F	1005-608-5314	PIN, SHOULDER, HEADED: (7269348)	1	1	0.8	0.2	4	4-2	1
P1	F	1055-776-0037	REAMER ASSEMBLY: (7790805)	1	1	0.8	0.2	32	4-2	3
P1	F	1005-608-5315	WASHER, SPRING TENSION: (7269349)	2	1	0.8	0.2	8	4-2	2
X1			WRENCH (7790679)		1				4-2	4
AMMUNITION BOX AND COVER ASSEMBLY: (51267) (Armament subsystem XM23.)										
X1			BOX (50631)		2				3-13	2
P1	O	1005-903-1093	COVER ASSEMBLY, AMMUNITION: (51170)	1	2	(0.5)	(0.2)	6	3-13	1
P	O	1005-972-8127	FITTING, BOX END: (7792344)	1	2	(1.3)	(0.4)	15	3-14	3
P	O	1005-972-8128	FITTING, GUN END: (7792345)	1	2	(1.3)	(0.4)	15	3-14	1
P	O	1005-972-8126	LINK, AMMUNITION CHUTE: (7792343)	10	88	(3.8)	(1.2)	50	3-14	2

Section IV. DIRECT AND GENERAL SUPPORT AND DEPOT REPAIR PARTS AND SPECIAL TOOLS—Continued

(1) Source, Maintenance and Recoverability Code			(2) Federal Stock Number	(3) Description	(4) Unit of Issue	(5) Quantity Incorporated In Unit	(6) 15-Day Maintenance Allowance Per 100 Equipments		(7) Depot Maintenance Guide Per 100 Equipments	(8) Illustration	
(a) Source	(b) Maintenance Level	(c) Recoverability					(a) Direct Support	(b) Heavy Support		(a) Figure Number	(b) Item Number
REPAIR PARTS FOR—Continued:											
BAG, EJECTION CONTROL: (49931)											
P1	O		1005-903-1146	BAG, EMPTY CARTRIDGE: (51166).....	1	2	(0.8)	(0.2)	9	3-16	1
X1				FRAME (51174).....	1	1				3-16	7
P1	O		1005-903-1040	LATCH, SAFETY, REAR BRACKET: (50269).....	2	2	(0.8)	(0.2)	10	3-16	5
P1	O		5315-815-1405	PIN, COTTER: (96906-24665-151).....	2	2	(0.8)	(0.2)	10	3-16	2
P1	O		1005-903-1038	PIN, REAR BRACKET: (59264).....	2	2	(0.8)	(0.2)	10	3-16	3
P1	O		1005-903-1039	SPRING, HELICAL, TORSION: (50267).....	2	1	(0.8)	(0.2)	10	3-16	4
TOOLS AND EQUIPMENT FOR UNIT REPLACEMENT											
ARMAMENT SUBSYSTEM, HELICOPTER, 7.62-MILLIMETER MACHINE GUN: XM23 and XM24, w/e											
MACHINE GUN, 7.62-MILLIMETER: XM60D, flexible (49929)											
The allowances shown below are for two machine guns											
			1005-722-5087	BRUSH, CLEANING, SMALL ARMS: (7225087).....	1		20			AI-2	2
			1005-556-4174	BRUSH, CLEANING, SMALL ARMS: (5564174).....	10		30			AI-1	3
			1005-690-3115	BRUSH, CLEANING, SMALL ARMS: (7790452).....	10		30			AI-1	4
			1005-650-4508	BRUSH, CLEANING, SMALL ARMS: (7790342).....	10		1.5			AI-1	
			1005-791-5420	CASE, CARRYING, BARREL ASSEMBLY AND EQUIPMENT: (7791009).....	1		(0.2)			AI-3	
			4933-652-9950	EXTRACTOR, RUPTURED CARTRIDGE CASE: (7790352).....	1		10			AI-2	
			1680-516-8427	HARNESS ASSEMBLY: (AF51J3817).....	1		(0.4)				
LUBRICATING OIL, SEMI-FLUID: (771359)											
			9150-889-3522	LUBRICATING OIL, SEMI-FLUID: (771359).....	6		1.6			AI-1	6
			1005-691-1639	MAGAZINE ASSEMBLY, AMMUNITION: (7790572).....	1		(0.5)			AI-6	
			8148-266-8843	MITTEN, CLOTH: (37-M-394).....	2		1.5			AI-5	
			1005-650-8237	ROD, CLEANING; SMALL ARMS: (6508237).....	1		0.5			AI-1	1
			1005-790-3600	STAFF, CLEANING, 20 MILLIMETER: (7790518).....	1		0.5			AI-2	
			1005-680-3766	WRENCH, SCREWDRIVER AND REAMER, COMBINATION: (7790680).....	1		1.0			AI-2	
MOUNT ASSEMBLY, LEFT HAND (49937) AND RIGHT HAND (49936) (Armament subsystem XM23.)											
			1005-973-2474	ADAPTER, AMMUNITION CHUTE STRAIGHT: (7792472).....	1		(0.8)			3-14	1
			1005-903-1094	AMMUNITION BOX AND COVER ASSEMBLY: (51267).....	1		(0.4)			1-5	
			1005-903-1088	BAG, EJECTION CONTROL: (49931).....	4		(0.8)			1-5	
			7510-763-5996	ENVELOPE, TRANSPARENT: (81348-E-43183).....	1		1.0			AI-4	
			1005-994-9647	PLUG, END LINK: (7791595).....	1		(18.8)	(6.2)		AI-4	
MOUNT ASSEMBLY, LEFT SIDE (50599) AND RIGHT SIDE (50600) (Armament subsystem XM24.)											
			1005-903-1088	BAG, EJECTION CONTROL: (49931).....	1		(0.8)			1-7	
			1005-903-1090	CAN ASSEMBLY, AMMUNITION: (50617).....	1		(0.5)			1-7	
			7510-763-5996	ENVELOPE, TRANSPARENT: (81348-E-43183).....	1		1.0			AI-4	
			1005-994-9647	PLUG, END LINK: (7791595).....	1		(18.8)	(6.2)		AI-4	
SPECIAL TOOLS FOR DIRECT SUPPORT AND DEPOT MAINTENANCE											
The 15-day level does not apply to tools and equipment for direct support and depot maintenance. The following tools are authorized one (1) each to the direct support company supporting subsystems XM23 and XM24											
MACHINE GUN, 7.62-MILLIMETER: XM60D, flexible (49929)											
			1005-722-5087	BRUSH, CLEANING, SMALL ARMS: (7225087).....						AI-2	
			4933-652-9950	EXTRACTOR, RUPTURED CARTRIDGE CASE: (7790352).....						AI-2	
			1005-790-3600	STAFF, CLEANING, 20-MILLIMETER: (7790518).....						AI-2	
			1005-690-3766	WRENCH, SCREWDRIVER AND REAMER, COMBINATION: (7790680).....						AI-2	

**Section IV. DIRECT AND GENERAL SUPPORT AND DEPOT REPAIR
PARTS AND SPECIAL TOOLS—Continued**

(1) Source, Maintenance and Recoverability Code			(2) Federal Stock Number	(3) Description	(4) Unit of Issue	(5) Quantity Incorporated In Unit	(6) 15-Day Maintenance Allowance Per 100 Equipments		(7) Depot Maintenance Guide Per 100 Equipments	(8) Illustration		
(a) Source	(b) Maintenance Level	(c) Recoverability					(a) Direct Support	(b) Heavy Support		(a) Figure Number	(b) Item Number	
				<p align="center">TOOLS AND EQUIPMENT FOR UNIT REPLACEMENT—Continued:</p> <p>MOUNT ASSEMBLY, LEFT HAND (49937) AND RIGHT HAND (49936) (Armament subsystem XM23.)</p> <p align="center">None authorized.</p> <p>MOUNT ASSEMBLY, LEFT SIDE (50599) AND RIGHT SIDE (50600) (Armament subsystem XM24.)</p> <p align="center">None authorized.</p> <p>SPECIAL MAINTENANCE TOOLS</p> <p>The sets listed below will be issued as required</p> <p>TOOL KIT, FIELD MAINTENANCE, BASIC, SMALL ARMS: (FSN 4933-775-0366) (Listed in SM 9-4-4933-E04)</p> <p>TOOL SET, FIELD MAINTENANCE: cal. 30 and 7.62 mm machine guns and mounts (FSN 4933-856-3733) (Listed in SM 9-4-4933-E06)</p> <p>TOOL SET, DEPOT MAINTENANCE: cal. 30 and 7.62 mm machine guns and mounts (FSN 4933-714-2807) (Listed in SM 9-4-4933-E05)</p>								
				<p align="center">COMMON MAINTENANCE TOOLS</p> <p>The sets listed below are authorized in accordance with TOE</p> <p>TOOL SET, AIRCRAFT ARMAMENT REPAIRMAN: MOS 427, basic (FSN 4933-987-9816) (Listed in SM 9-4-4933-A15)</p> <p>TOOL SET, AIRCRAFT ARMAMENT REPAIRMAN: MOS 427, supplemental (FSN 4933-994-9242) (Listed in SM 9-4-4933-A16.)</p> <p>SHOP SET, FIELD MAINTENANCE, SMALL ARMS (FSN 5180-754-0664) (Listed in SM 9-4-4933-A13.)</p>								

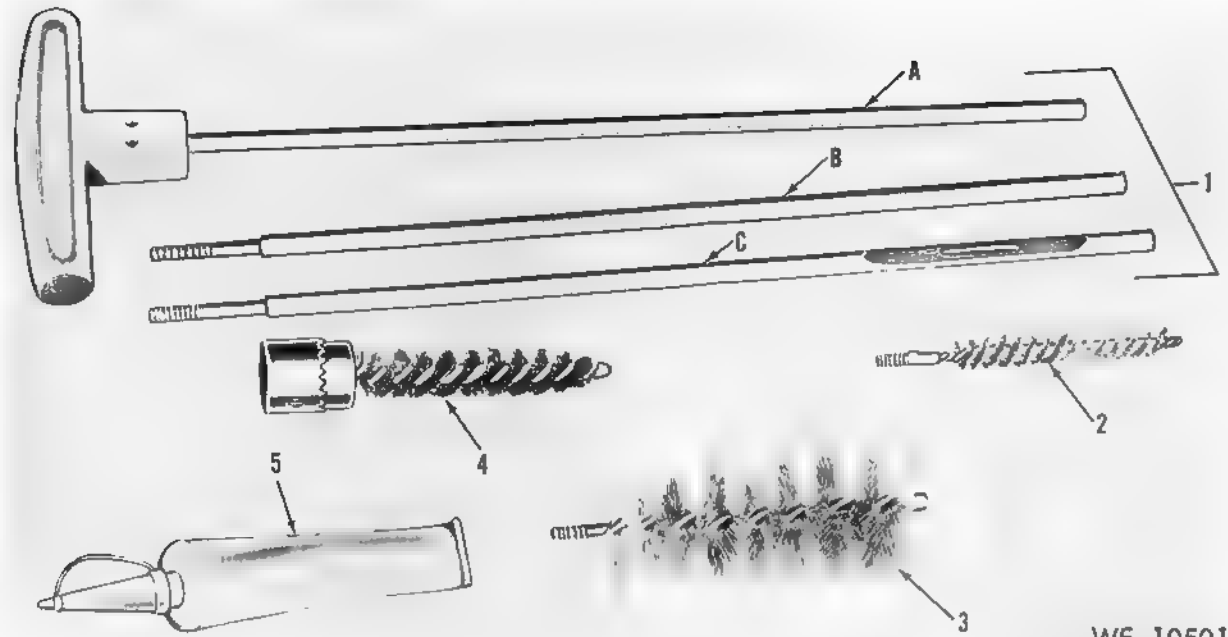

WE 10501

Figure AI-1. Cleaning equipment.

- | | |
|-----------------------|-------------------|
| 1—Rod | 2—Brush |
| A—Section | 3—Brush |
| B—Section | 4—Brush |
| C—Swab holder section | 5—Lubricating oil |



20-MILLIMETER CLEANING STAFF 1005-790-3600



SMALL ARMS CLEANING BRUSH 1005-722-5087



RUPTURED CARTRIDGE CASE EXTRACTOR 4933-652-9950

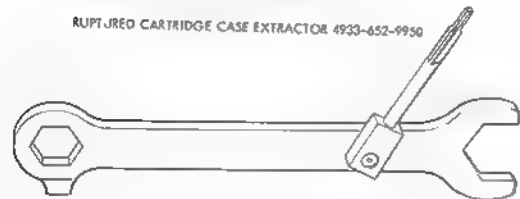

COMBINATION SCREWDRIVER AND REAMER WRENCH 1005-690-3766

WE 105037

Figure AI-2. Tools and equipment.



WE 10824

Figure AI-3. Carrying case.

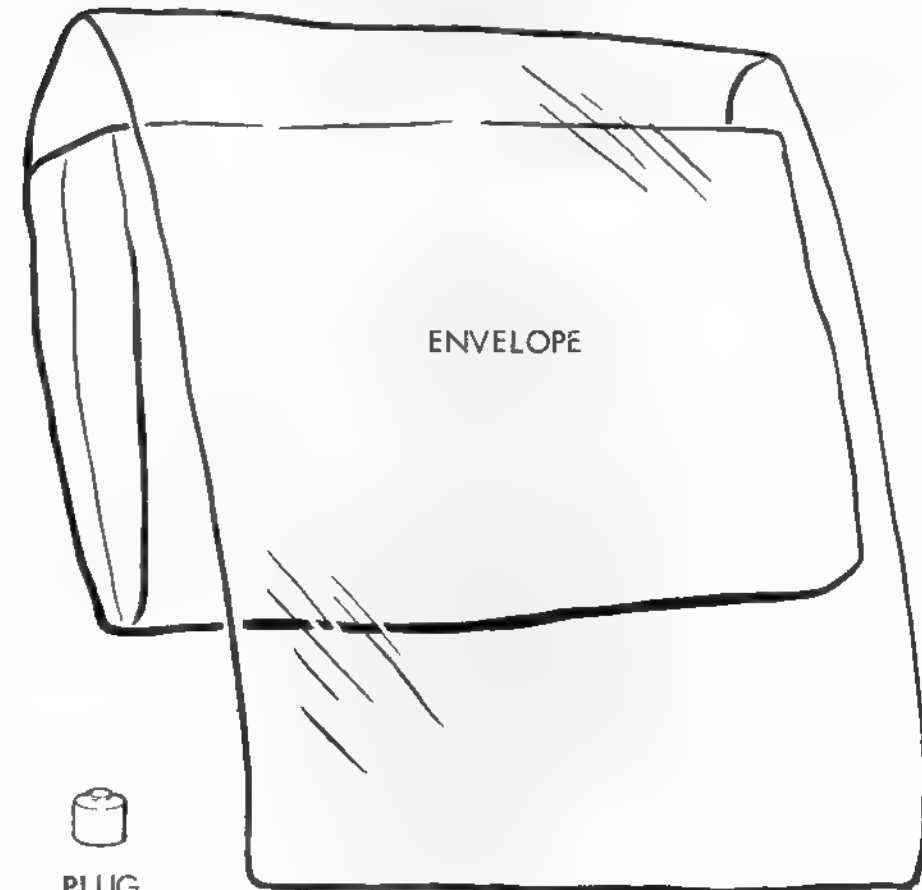

PLUG

WE 10712

Figure AI-4. Tools and equipment.

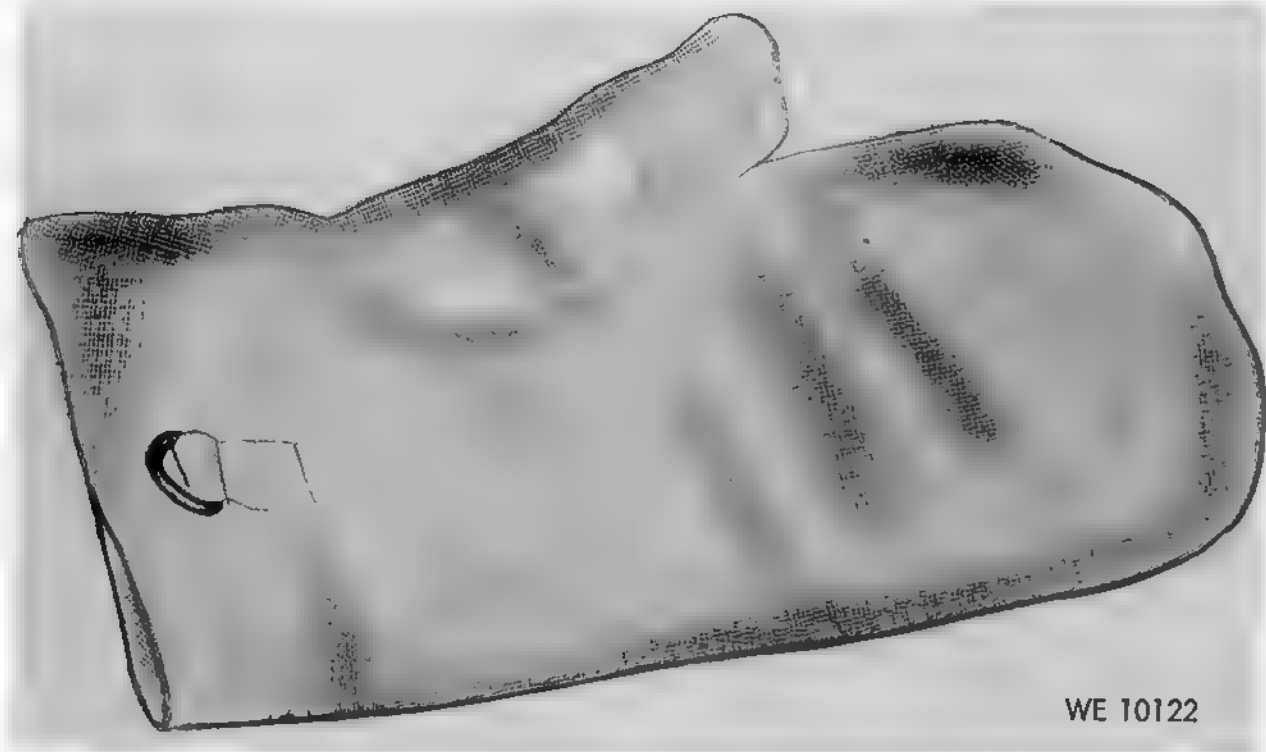

WE 10122

Figure AI-5. Cloth mitten.

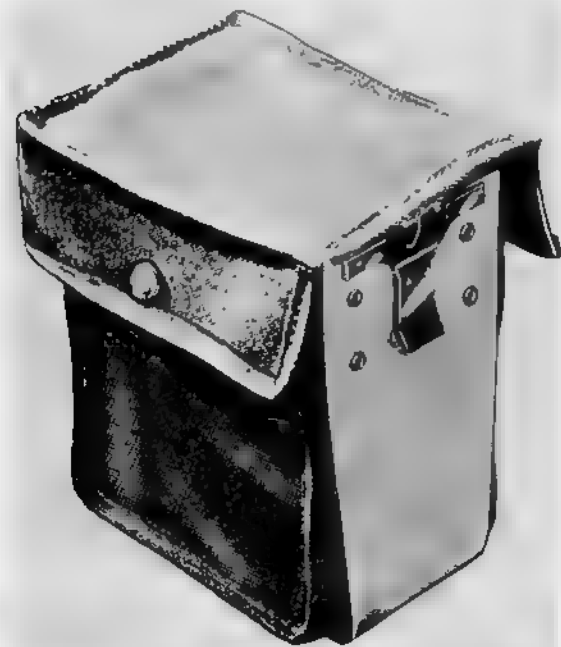

WE 10823

Figure AI-6. Magazine assembly.

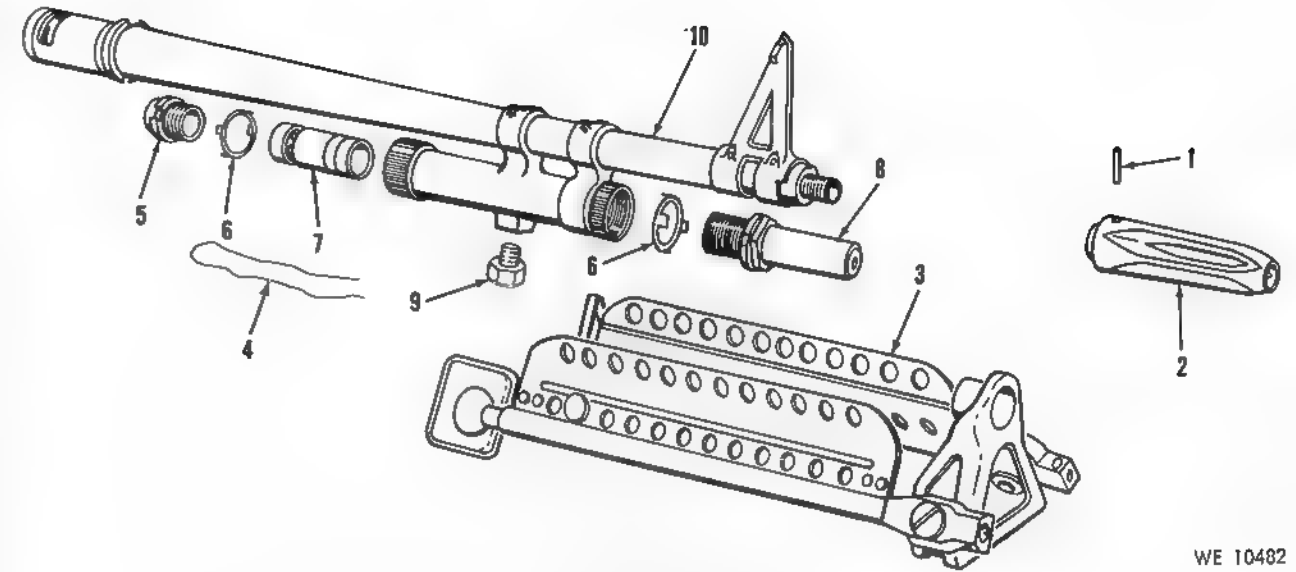

WE 10482

Figure AI-7. Barrel assembly with bipod assembly—exploded view.

- | | |
|------------------|--------------------|
| 1—Pin | 6—Washer |
| 2—Suppressor | 7—Piston |
| 3—Bipod assembly | 8—Extension |
| 4—Wire | 9—Plug |
| 5—Nut | 10—Barrel assembly |

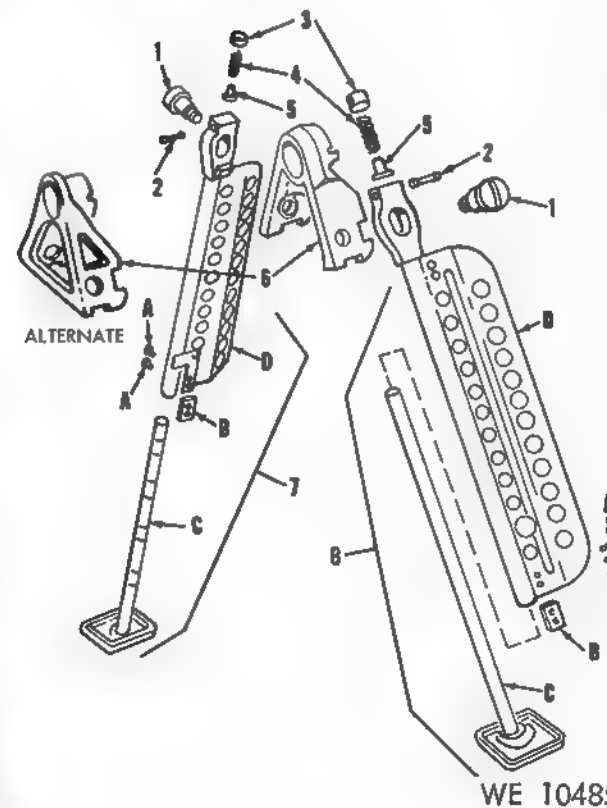

WE 10485

Figure AI-8. Bipod assembly—exploded view.

- | | |
|----------------|--------------------|
| 1—Screw | B—Key |
| 2—Pin | C—Foot assembly |
| 3—Retainer | D—Housing assembly |
| 4—Spring | 8—Leg assembly |
| 5—Plunger | A—Rivet |
| 6—Rivet | B—Key |
| 7—Leg assembly | C—Foot assembly |
| A—Rivet | D—Housing assembly |

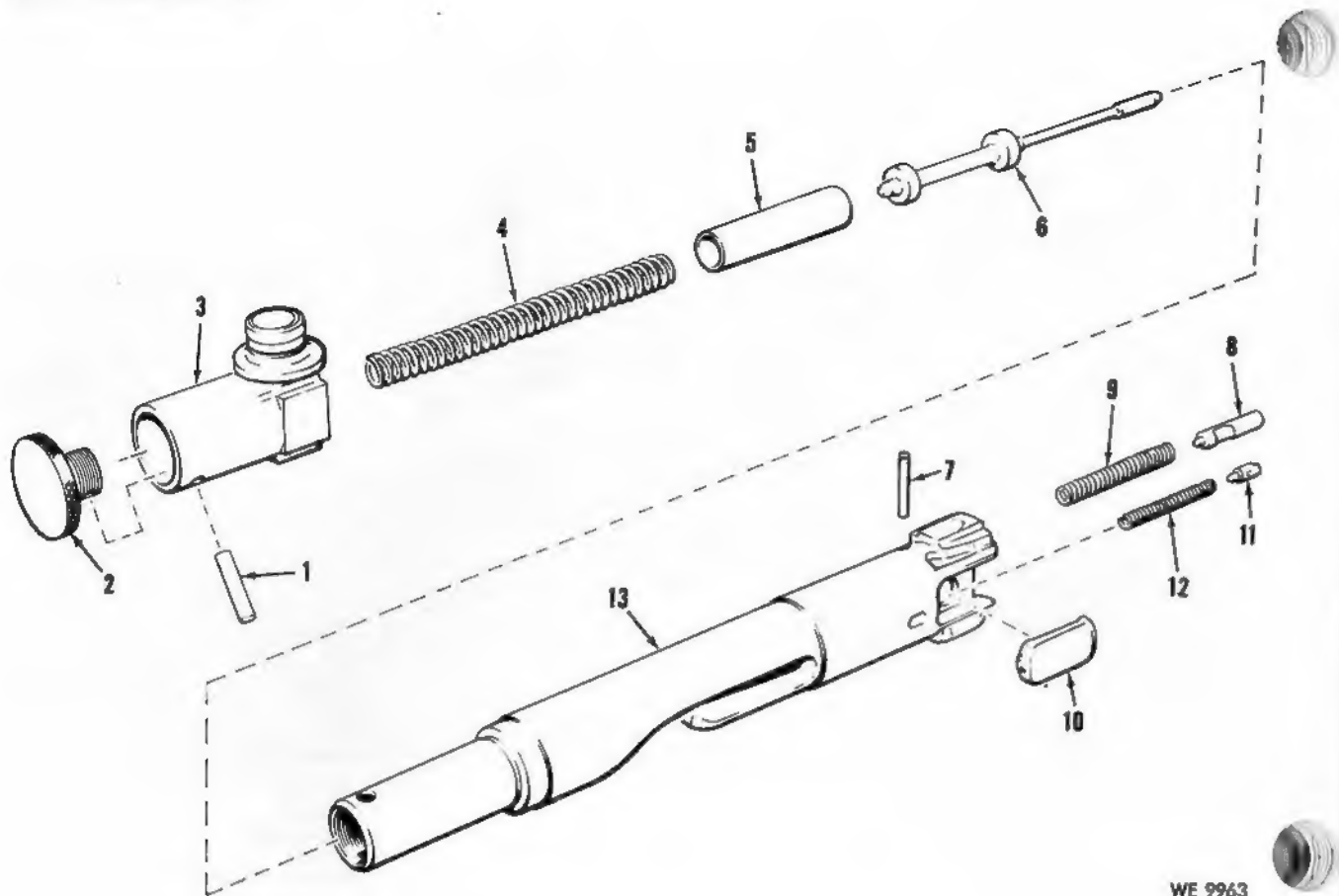

WE 9963

Figure AI-9. Bolt assembly—exploded view.

- | | | |
|---------------------|-----------|--------------|
| 1—Pin | 5—Bearing | 10—Extractor |
| 2—Plug assembly | 6—Pin | 11—Plunger |
| 3—Actuator assembly | 7—Pin | 12—Spring |
| 4—Spring | 8—Ejector | 13—Bolt |
| | 9—Spring | |

Figure AI-10. Rod assembly—exploded view.

- | |
|-----------------------|
| 1—Pin |
| 2—Roller |
| 3—Yoke and tube group |



WE 10496

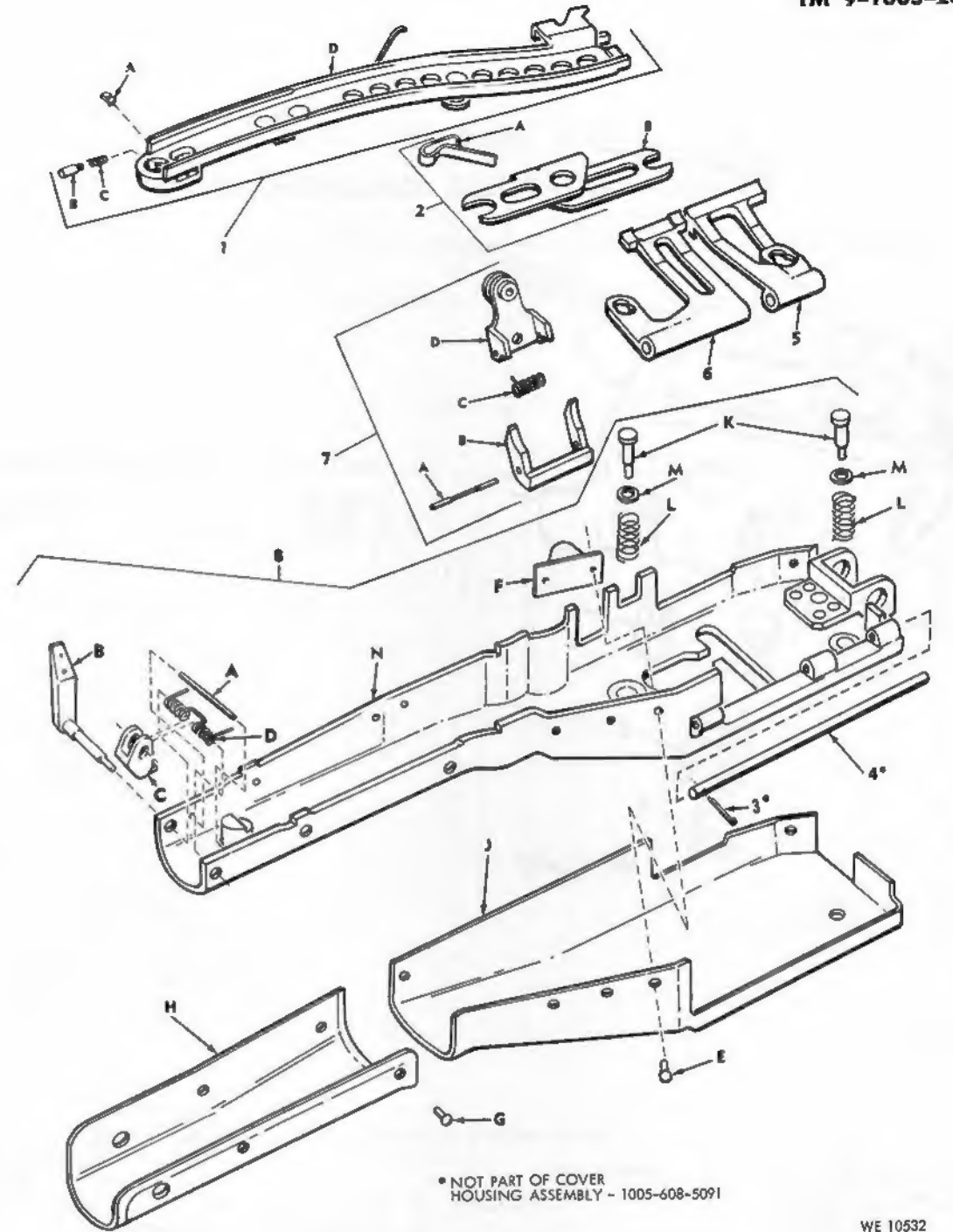

* NOT PART OF COVER HOUSING ASSEMBLY - 1005-608-5091

WE 10532

Figure AI-11. Cover assembly—exploded view.

- | | | |
|--------------------|--------------------|-------------------|
| 1—Cam assembly | 5—Guide | D—Spring |
| A—Retainer | 6—Guide | E—Rivet |
| B—Plunger | 7—Pawl assembly | F—Bumper assembly |
| C—Spring | A—Shaft | G—Rivet |
| D—Channel assembly | B—Pawl | H—Pad assembly |
| 2—Lever assembly | C—Spring | J—Shield |
| A—Clip | D—Chassis assembly | K—Pin |
| B—Lever | 8—Housing assembly | L—Spring |
| 3—Pin | A—Pin | M—Washer |
| 4—Shaft | B—Lever assembly | N—Frame assembly |
| | C—Latch | |

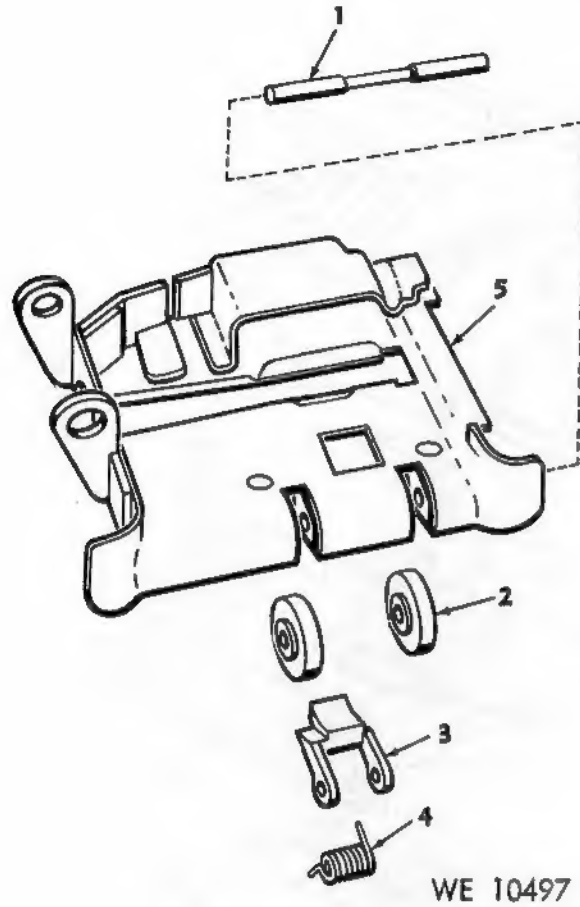
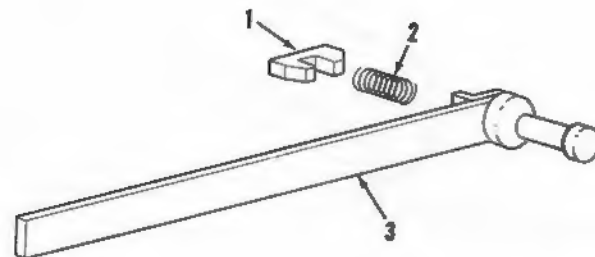

Figure AI-12. Tray assembly—exploded view.
 1—Shaft
 2—Roller
 3—Pawl
 4—Spring
 5—Frame assembly

Figure AI-13. Handle assembly—exploded view.

- 1—Retainer
- 2—Spring
- 3—Slide assembly



WE 10495

APPENDIX II MAINTENANCE ALLOCATION CHART

Refer to AR 310-3 for definitions used in this appendix.

(1) Group no.	(2) Functional group	(3) Maintenance function										(4) Tools and equipment	(5) Remarks				
		Inspect	Test	Service	Adjust	Align	Calibrate	Install	Replace	Repair	Overhaul			Re build			
1...	MACHINE GUN XM60D.....	1		1				1									
2...	BARREL ASSEMBLY WITH BI-POD ASSEMBLY.			2					2	3	4		A and B	See table AII-1.			
3...	GRIP AND TRIGGER ASSEMBLY			2					2	3	4						
4...	SEAR AND SAFETY HOUSING ASSEMBLY.....			2	2						4						
5...	BUFFER ASSEMBLY.....			2					2	2	4						
6...	OPERATING ROD ASSEMBLY...			2					2	3	4						
7...	BREECH BOLT ASSEMBLY.....			2					2	2	4		C and D	See table AII-1.			
8...	COVER ASSEMBLY.....			2							4						
9...	TRAY ASSEMBLY.....			2					2	3	4						
10...	REAR SIGHT ASSEMBLY.....									2	4						
11...	RECEIVER ASSEMBLY.....			2						3	4						
12...	MOUNT ASSEMBLY XM23.....			2						2	4						
13...	MOUNT ASSEMBLY XM24.....			2						2	4						

TABLE AII-1. Tools Required to Perform the Maintenance Functions

Tool code	Level of maintenance	Nomenclature	Federal stock number
A.....	2	WRENCH, SCREWDRIVER AND REAMER, COMBINATION:.....	1005-690-3766
B.....	3	KIT, BARREL EROSION GAGE: M8.....	4933-313-9485
C.....	3	GAGE, FIRING PIN PROTRUSION:.....	4933-653-3373
D.....	3	GAGE, PLUG, PLAIN CYLINDRICAL:.....	5220-745-8598

INDEX

	Paragraphs	Page		Paragraphs	Page
Accidents, field report of (<i>See</i> Forms, records, and reports)			Disassembly and/or assembly	3-10a	24
Adjustment of sear link nut ..	3-19	27	Barrel assembly w/bipod assembly (direct and general support):		
Ammunition	1-3b(2)	2	Cleaning, inspection, and repair	4-3b	33
Ammunition box and cover assembly (organizational):			Disassembly and/or assembly	4-3a	33
Cleaning, inspection, and repair	3-21b	28	Basic issue items	Appx I	40
Disassembly and/or assembly	3-21a	28	Bolt assembly, breech (<i>See</i> Breech bolt assembly)		
Ammunition box and cover assembly (direct and general support):			Breech bolt assembly (organizational):		
Cleaning, inspection, and repair	4-14b	34	Cleaning, inspection, and repair	3-15b	27
Disassembly and/or assembly	4-14a	34	Disassembly and/or assembly	3-15a	26
Ammunition box chute assembly (organizational):			Breech bolt assembly (direct and general support):		
Cleaning, inspection, and repair	3-22b	29	Cleaning, inspection, and repair	4-8b	34
Disassembly and/or assembly	3-22a	29	Disassembly and/or assembly	4-8a	34
Ammunition box chute assembly (direct and general support):			Buffer assembly (organizational)		
Cleaning, inspection, and repair	4-15b	34	Cleaning, inspection, and repair	3-13b	26
Disassembly and/or assembly	4-15a	34	Disassembly and/or assembly	3-13a	26
Ammunition can assembly (organizational):			Buffer assembly (direct and general support):		
Cleaning, inspection, and repair	3-25b	31	Cleaning, inspection, and repair	4-6b	34
Disassembly and/or assembly	3-25a	31	Disassembly and/or assembly	4-6a	34
Ammunition can assembly (direct and general support):			Can assembly, ammunition: (<i>See</i> Ammunition can assembly)		
Cleaning, inspection, and repair	4-18b	34	Cartridge case, ruptured (<i>See</i> Ruptured cartridge case)		
Disassembly and/or assembly	4-18a	34	Chart, lubrication	3-3	19
Assembly (<i>See specific item</i>)			Chute assembly, ammunition box: (<i>See</i> Ammunition box chute assembly)		
Authorized forms	1-3a	2	Cleaning instructions	3-6	21
Authorized rounds	5-1	36	Combination screwdriver and reamer wrench:		
Barrel assembly w/bipod (organizational):			Cleaning, inspection, and repair	4-19b	35
Cleaning, inspection, and repair	3-10b	24			

	Paragraphs	Page		Paragraphs	Page
Disassembly and/or assembly	4-19a	35	housing assembly)		
Control, bag ejection (<i>See</i> Ejection control bag)			Immediate action procedure for removing a round in case of failure to fire	2-11	8
Controls:			Injury to personnel or damage to materiel	1-3b	2
Machine gun	2-3	7	Inspection procedures, final ...	6-1	39
Mount assembly	2-4	7	Instructions, cleaning (<i>See</i> Cleaning instructions)		
Cook-off	2-10c	8	Loading	2-8	7
Cover assembly (direct and general support):			Lubrication chart (<i>See</i> Chart, lubrication)		
Cleaning, inspection, and repair	4-9b	34	Machine gun XM60D (organizational):		
Disassembly and/or assembly	4-9a	34	Cleaning, inspection, and repair	3-9b	24
Data, tabulated	1-5	2	Disassembly and/or assembly	3-9a	24
Description of subsystem:			Machine gun XM60D (direct and general support):		
Machine gun XM60D	1-4b	2	Cleaning, inspection, and repair	4-2b	33
Mount assembly XM23 ...	1-4c	2	Disassembly and/or assembly	4-2a	33
Mount assembly XM24 ...	1-4d	2	Maintenance allocation chart (<i>See also</i> Maintenance ... allocation chart, appx II)	1-2	2
Disassembly (<i>See specific item</i>)			Misfire	2-10a	8
Double feeding (<i>See</i> Feeding double)			Mount assembly XM23 (organizational):		
Ejection control bag (organizational):			Cleaning, inspection, and repair	3-20b	28
Cleaning, inspection, and repair	3-23b	29	Disassembly and/or assembly	3-20a	28
Disassembly and/or assembly	3-23a	29	Mount Assembly XM23 (direct and general support):		
Ejection control bag (direct and general support):			Cleaning, inspection, and repair	4-13b	34
Cleaning, inspection, and repair	4-18b	34	Disassembly and/or assembly	4-13a	34
Disassembly and/or assembly	4-18a	34	Mount assembly XM24 (organizational):		
Extracting a ruptured cartridge case	2-13	8	Cleaning, inspection, and repair	3-24b	31
Failure to fire	2-10	8	Disassembly and/or assembly	3-24a	31
Feeding, double	2-15	11	Mount assembly XM24 (direct and general support):		
Field report of accidents	1-3b	2	Cleaning, inspection, and repair	4-17b	34
Firing	2-9	7	Disassembly and/or assembly	4-17a	34
Forms, authorized (<i>See</i> Authorized forms)			Operating rod assembly (organizational):		
Forms, records and reports ...	1-3	2	Cleaning, inspection, and repair	3-14b	26
Function firing	4-1	33	Disassembly and/or assembly	3-14a	26
Grip and trigger assembly (organizational):			Operating rod assembly (direct and general support):		
Cleaning, inspection, and repair	3-11b	24			
Disassembly and/or assembly	3-11a	24			
Grip and trigger assembly (direct and general support):					
Cleaning, inspection, and repair	4-4b	34			
Disassembly and/or assembly	4-4a	33			
Hangfire	2-10b	8			
Housing assembly, sear and safety (<i>See</i> Sear and safety					

	Paragraphs	Page		Paragraphs	Page
Cleaning, inspection, and repair	4-7b	34	assembly	3-12a	24
Disassembly and/or assembly	4-7a	34	Sear and safety housing assembly (direct and general support):		
Overhauled guns	3-8b	24	Cleaning, inspection, and repair	4-5b	34
Overhaul instructions, procedures for	8-1	39	Disassembly and/or assembly	4-5a	34
Overhaul unserviceability criteria (See Unserviceability criteria, overhaul)			Service before firing	2-6	7
Painting	3-4	19	Service upon receipt of materiel:		
Preparation for firing	2-5	7	Scope	2-1	7
Preventive maintenance services:			Services	2-2	7
Daily inspection	3-5a	19	Tables:		
Intermediate inspection ...	3-5b	19	Service upon receipt of materiel (table 2-1) ..	2-1	7
Location of inspection areas	3-5c		Preparation for firing (table 2-2)	2-5	7
Services	3-5	19	Preventive maintenance checks and services, daily inspection (table 3-1)	3-5	19
Rear sight assembly (organizational):			Preventive maintenance checks and services, intermediate inspection (table 3-2)	3-5	19
Cleaning, inspection, and repair	3-17b	27	Troubleshooting (table 3-3)	3-7	23
Disassembly and/or assembly	3-17a	27	Tools required to perform the maintenance functions (table AII-1) ..	AII-1	71
Rear sight assembly (direct and general support):			Tabulated data (See Data, tabulated)		
Cleaning, inspection, and repair	4-11b	34	Tools and equipment	3-2	19
Disassembly and/or assembly	4-11a	34	Tray assembly (organizational):		
Receiver assembly (organizational):			Cleaning, inspection, and repair	3-16b	27
Cleaning, inspection, and repair	3-18b	27	Disassembly and/or assembly	3-16a	27
Disassembly and/or assembly	3-18a	27	Tray assembly (direct and general support):		
Receiver assembly (direct and general support):			Cleaning, inspection, and repair	4-10b	34
Cleaning, inspection, and repair	4-12b	34	Disassembly and/or assembly	4-10a	34
Disassembly and/or assembly	4-12a	34	Troubleshooting	3-7	23
Repair parts	3-1	19	Troubleshooting chart for operator	2-7	7
Repair parts and special tool lists	Appx I	40	Unloading	2-14	8
Repair standards, location of ..	7-1	39	Unserviceability criteria, overhaul	3-8	24
Rounds, authorized (See authorized forms)			Wrench, screwdriver and reamer combination (See Combination screwdriver and reamer wrench)		
Runaway gun	2-12	8			
Ruptured cartridge case	2-13	8			
Scope of manual	1-1	2			
Sear and safety housing assembly (organizational):					
Cleaning, inspection, and repair	3-12b	24			
Disassembly and/or					

By Order of the Secretary of the Army:

HAROLD K. JOHNSON,
General, United States Army,
Chief of Staff

Official:

J. C. LAMBERT,
Major General, United States Army,
The Adjutant General

Distribution:

To be distributed in accordance with DA Form 12-31, Section I requirements for Operational Maintenance Literature for XM23 and XM24 Armament Subsystem.